

SECTION 3, T.5N., R.1W., S.L.B. & M.

IN OGDEN CITY

SCALE 1" = 400'

2

SEE BOOK 14, PAGE 62

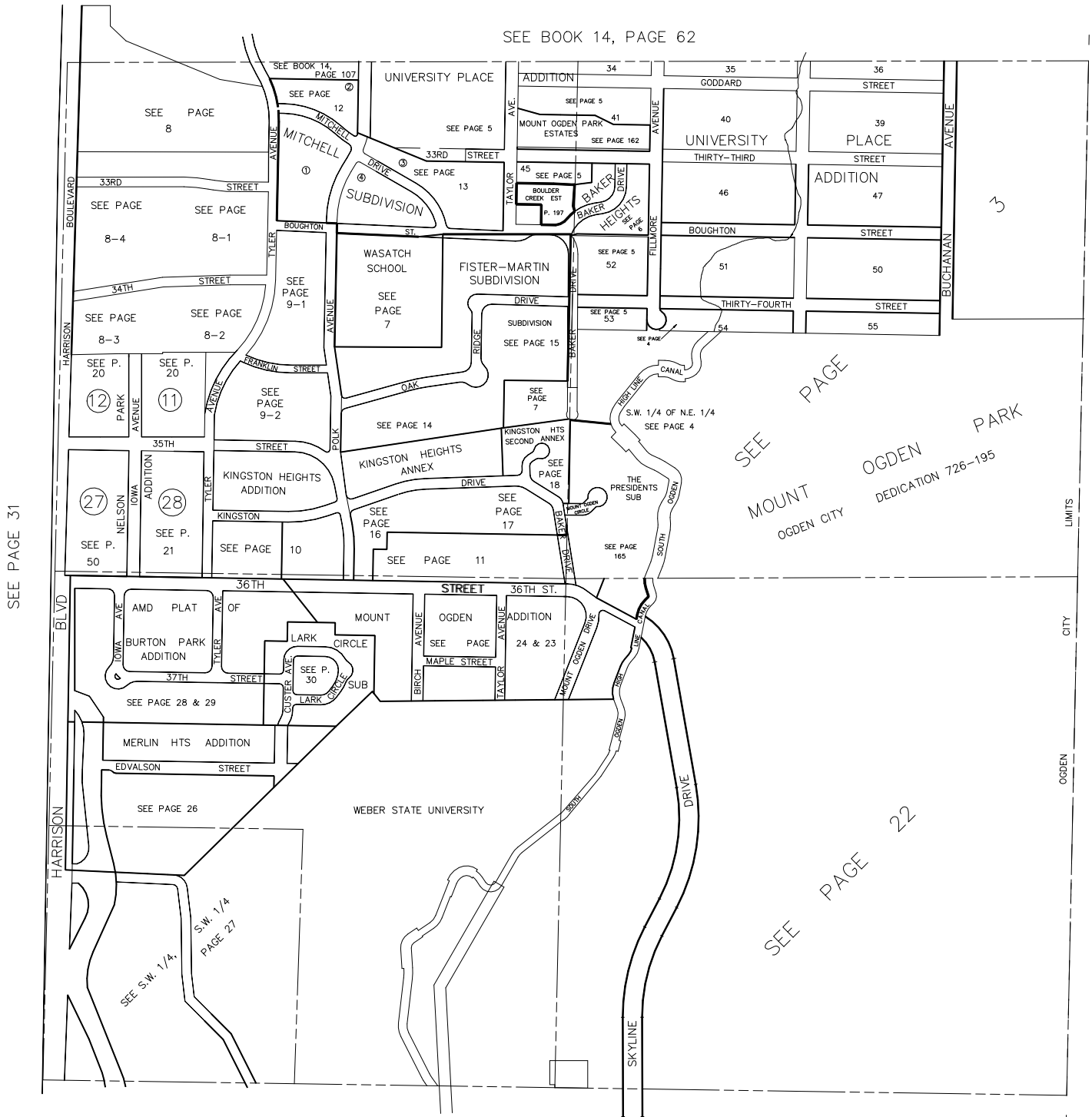

SEE BOOK 6, PAGE 85

FOR TAX PURPOSES ONLY

L.D.F. 8-92

5

SEE PAGE 31

SEE PAGE 1