

PART OF THE N.E. 1/4 OF SECTION 4, T.6N., R.1W., S.L.B. & M.
PART OF THE S.E. 1/4 OF SECTION 33, T.7N., R.1W., S.L.B. & M.

210

GREENFIELD SUBDIVISION PHASE 5

TAXING UNIT: 10

IN NORTH OGDEN CITY

SCALE 1" = 50'

SEE BOOK 17, PAGE 165

SEE BOOK 17, PAGE 161

SOUTH 1/4 CORNER
SECTION 33, T.7N., R.1W.

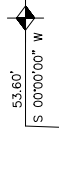

SEE PAGE 3-4

SEE PAGE 3-4

7' UTILITY & DRAINAGE EASEMENTS EACH
SIDE OF PROPERTY LINES AS INDICATED
BY DASHED LINES EXCEPT AS OTHERWISE
SHOWN.

FOR COMPLETE ENG DATA SEE
ORIGINAL DEDICATION PLAT IN
BOOK 33, PAGE 38 OF RECORDS.