

WEBER COUNTY
BRASS CAP
1981

14 23
15 22

WEBER COUNTY TRIANGULATION
STATION "TOWER"

N. 0° 12' 27" E. 697.70' (GEODETIC NORTH)

N. 0° 32' 52" W. 885.26'

S. 0° 12' 27" W.
147.60' (SOUTH)

N. 89° 47' 33" W.
139.60' (WEST)

S. 89° 47' 33" E.
147.60' (EAST)

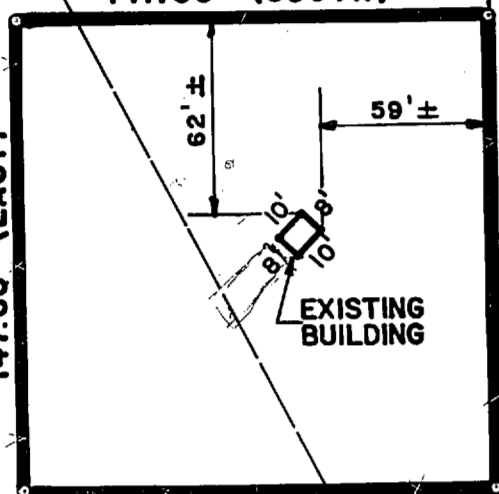

147.60' (NORTH)
N. 0° 12' 27" E.

147.60' (WEST)
N. 89° 47' 33" W.

UTAH STATE PLANE GRID
N. 62° 56' 30" E. 2350.0' F.

WEBER COUNTY TRIANGULATION
STATION "EYRIE"

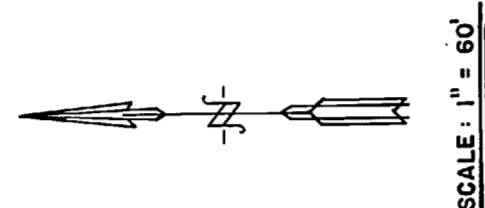

LEGEND:

O - Set 24" x 5/8" Rebar w/ Plastic Cap
Stamped Weber Co. Surveyor

SURVEYOR'S CERTIFICATE

I RANDALL J. WILLIFORD, a registered, land surveyor as prescribed by the laws of the State Of Utah and holding license No. 5366, do hereby certify that I have surveyed the properties described hereon and that this plat is a true and correct representation of said survey.

Randall J. Williford
RANDALL J. WILLIFORD
DEPUTY COUNTY SURVEYOR



BOUNDARY DESCRIPTION

A part of the S.E. 1/4 of Section 15 T.7N., R.1 E., S.L.B. & M. Beginning at a point which is North 697.70 ft. and West 139.60 ft. from the S.E. Cor. of Section 15, T.7N., R.1 E., S.L.B. & M.; Running Thence West 147.60 ft.; Thence North 147.60 ft.; Thence East 147.60 ft.; Thence South 147.60 ft. to the point of beginning.

Contains 0.5 Ac.

Narrative:

This survey was performed to provide site plan information for a new television receiver. In the absence of any occupational evidence, the bearing base for the description was assumed to be geodetic. The geodetic bearing between "Tower" and "Eyrie" was taken from Weber County control survey data.

NUMBER _____	APPROVAL SIGNATURE _____ DATE _____	NO	AUTHORIZED BY	REVISIONS	MADE BY	DATE	DESIGN BY _____
ACCOUNT _____							DRAWN BY <u>ROBERT H. TSOSIE</u>
SHEET _____							CHECKED BY _____
SHEETS _____							SCALE HORIZ 1" = 60'
							SCALE VERT _____
							DATE <u>JULY 11, 1988</u>

WEBER COUNTY
SURVEYOR & ENGINEER'S
OFFICE

SURVEYED FOR: OGDEN VALLEY TELEVISION
TRANSLATOR SPECIAL SERVICE DISTRICT
LOCATED in the S.E. 1/4 of Sec. 15, T.7 N.
R.1 E., S.L.B. & M. (Surveyed July 5, 1988)