

G:\DRAWINGS\SHARED\2662\01-HYDE\KHYDESPV Thu Oct 23 11:30:03 1997 JAE

REVISIONS

1.		4.
2.		5.
3.		6.

PROJECT NO. 288E-211 SURVEYOR: R. BULLARD  
DATE: 7-2-97 DRAWN: JAC  
SCALE: 1"=40' CHECKED:

**REEVE & ASSOCIATES, INC.**  
ENGINEERS PLANNERS & SURVEYORS  
3875 GARDEN UNIT #401  
IRVINE, CALIF. 92610  
(800) 827-5100 FAX (800) 827-8888

**RECORD OF SURVEY**

**HYDE & PERRY PROPERTIES**  
A PART OF THE SW 1/4 OF SECTION 24 AND THE NE 1/4 OF SECTION 23  
T15N, R11W, S14E, 1/4 SECTION 24, 1/4 SECTION 23  
WILLIAM SUBDIVISION NO. 8  
APRIL 1997

SHEET 1 OF 1 SHEETS

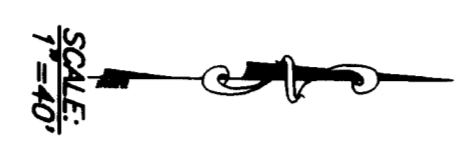
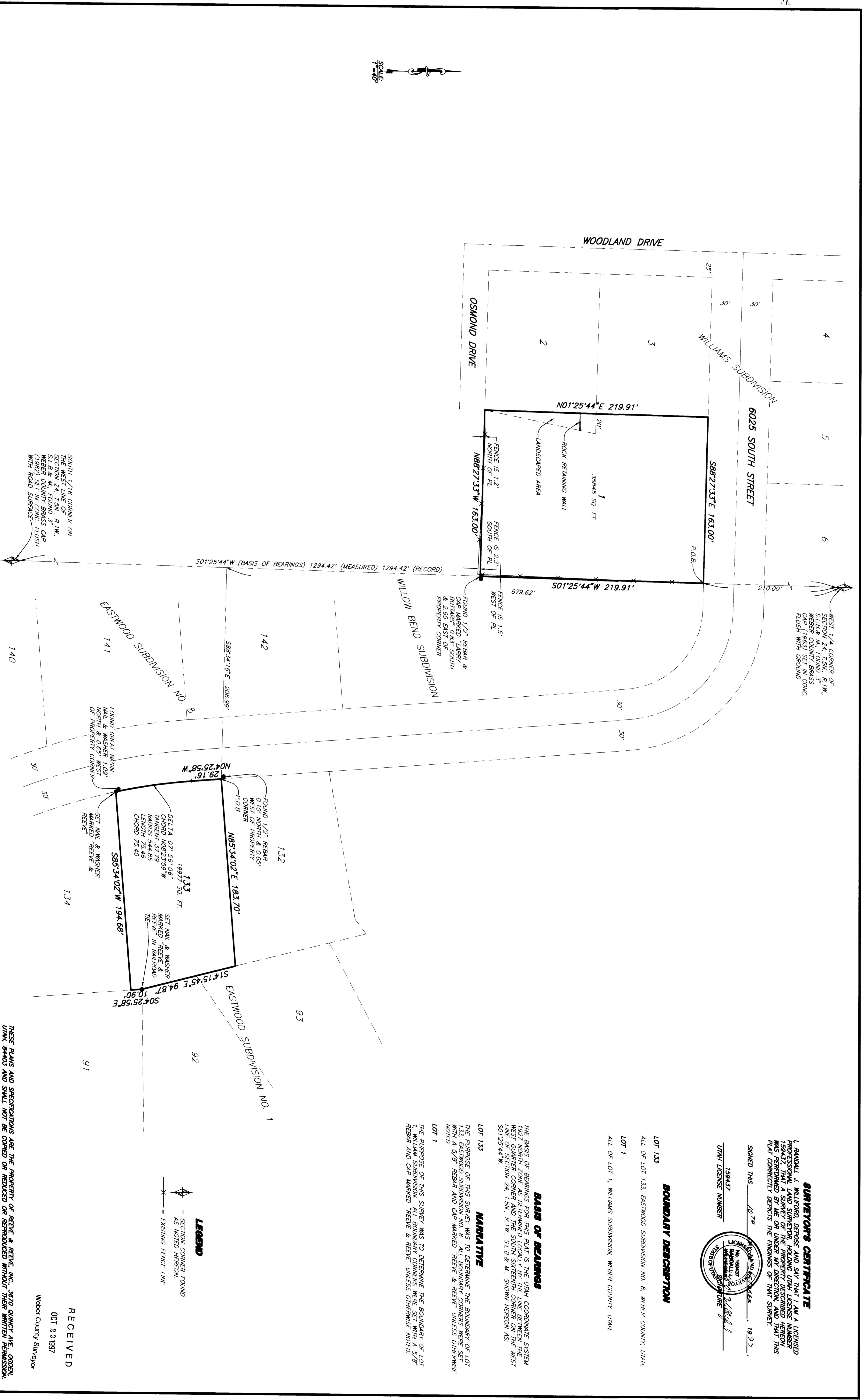

SOUTH 1/4 CORNER ON SECTION 24 T15N, R11W, S14E, 1/4 SECTION 24, 1/4 SECTION 23 (1987) SET IN CONCORDANCE WITH ROAD SURFACE

FOUND GREAT BASIN MAIL & WASHER 1.09' NORTH 0.85' WEST OF PROPERTY CORNER

DELTA 07' 56' 06" CHORD 10823.59' W RADIUS 544.65' LENGTH 75.46' CHORD 75.40'

SET NAIL & WASHER MARKED 'REVEE & PERRY' IN BALDROAD

**LEGEND**  
- S SURVEY CORNER FOUND  
- AS NOTED HEREON  
- EXISTING FENCE LINE

**BASES OF BEARINGS**  
THE BASIS OF BEARINGS FOR THIS PLAT IS THE UTM COORDINATE SYSTEM WITH THE UTM ZONE 18Q UTM GRID. THE UTM COORDINATE SYSTEM WEST QUARTER CORNER AND THE SOUTH SIXTEENTH CORNER ON THE WEST LINE OF SECTION 24, T15N, R11W, S14E & M, SHOWN HEREON AS: S07°23'44\"/>

**NARRATIVE**  
THE PURPOSE OF THIS SURVEY WAS TO DETERMINE THE BOUNDARY OF LOT 133 EASTWOOD SUBDIVISION NO. 8. ALL BOUNDARY CORNERS WERE SET WITH 5/8\"/>

**BOUNDARY DESCRIPTION**  
LOT 133 ALL OF LOT 133, EASTWOOD SUBDIVISION NO. 8, WEBER COUNTY, UTAH.  
LOT 1 ALL OF LOT 1, WILLIAMS SUBDIVISION, WEBER COUNTY, UTAH.

**SURVEYOR'S CERTIFICATE**  
I, RANDALL J. WILFORD, DEPOSE AND SAY THAT I AM A LICENSED SURVEYOR IN THE STATE OF UTAH. I HAVE PERSONALLY CONDUCTED THE SURVEY DESCRIBED HEREON AND THAT THE FINDINGS OF THIS SURVEY WERE CORRECTLY DEDUCED FROM THE FINDINGS OF THIS SURVEY.  
SIGNED THIS 10<sup>TH</sup> DAY OF SEPTEMBER, 1997.  
198437  
UTAH LICENSE NUMBER

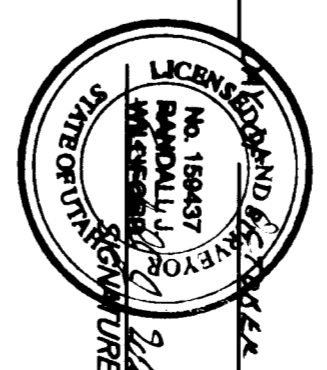

RECEIVED  
OCT 2 9 1997  
Weber County Surveyor