

SURVEYOR'S CERTIFICATE

I, DONALD D. MOORE, JR., DO HEREBY CERTIFY THAT I AM A REGISTERED LAND SURVEYOR, AND THAT I HOLD CERTIFICATE NO. 149039, AS PRESCRIBED BY THE LAWS OF THE STATE OF UTAH AND THAT I HAVE MADE A SURVEY OF THE TRACT OF LAND SHOWN ON THIS PLAT AND DESCRIBED BELOW.

DESCRIPTIONS

All of Lots 7 and 9 of Spurlock Subdivision, Plat "I", according to the official plat recorded in the office of the County Recorder for Weber County.

DATE

Donald D. Moore, Jr.
DONALD D. MOORE, JR.
REGISTERED LAND SURVEYOR

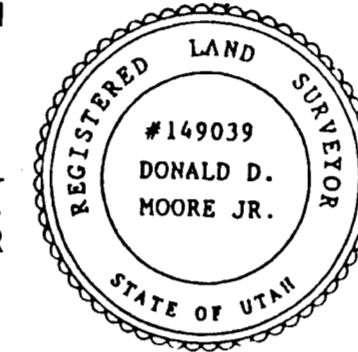

NARRATIVE

THIS SURVEY WAS CONDUCTED TO ESTABLISH BOUNDARIES OF PROPERTY FOR THE CONSTRUCTION OF A HOME. THE BASIS OF BEARING FOR THE SURVEY IS NORTH 1°39'41" EAST BETWEEN THE SOUTH QUARTER CORNER OF SECTION 10, TOWNSHIP 6 NORTH, RANGE 1 EAST AND THE NORTHEASTERLY CORNER OF LOT 9, SPURLOCK SUBDIVISION, PLAT "I".

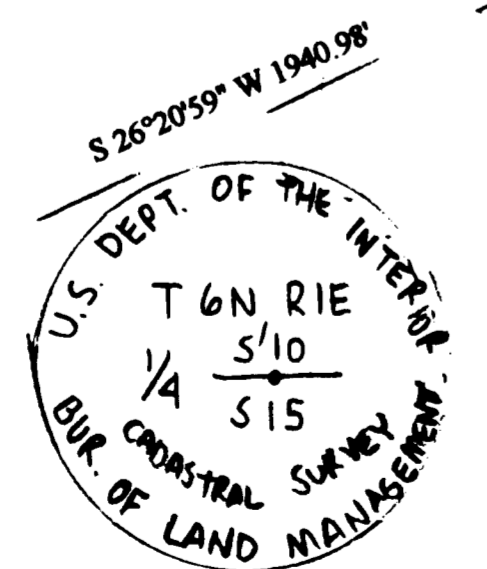
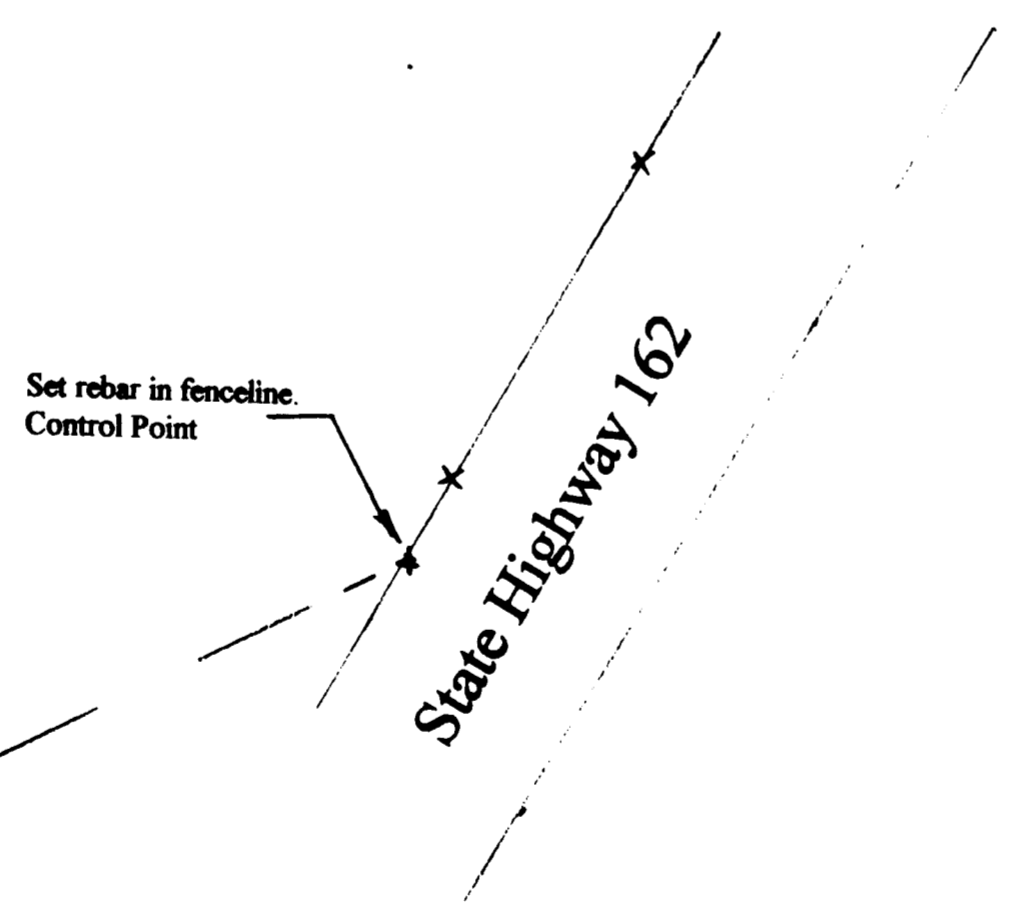

RECEIVED
DEC 17 1997
Weber County Surveyor

PROJECT
LOTS 7 and 9 - SPURLOCK SUB, PLAT I
WEBER COUNTY, UTAH
SECTION 10, T6N, R1E, SLB&M

Drawn	Checked	Date	Job No.

Donald D. Moore, Jr.
A Registered Land Surveyor
721 West 1000 South
Woods Cross, UT 84087
(801) 295-2713

PROPERTY SURVEY
FOR - STEPHEN SPURLOCK

JOB No.
SHEET 1 OF 1