

SCALE 1"=50'

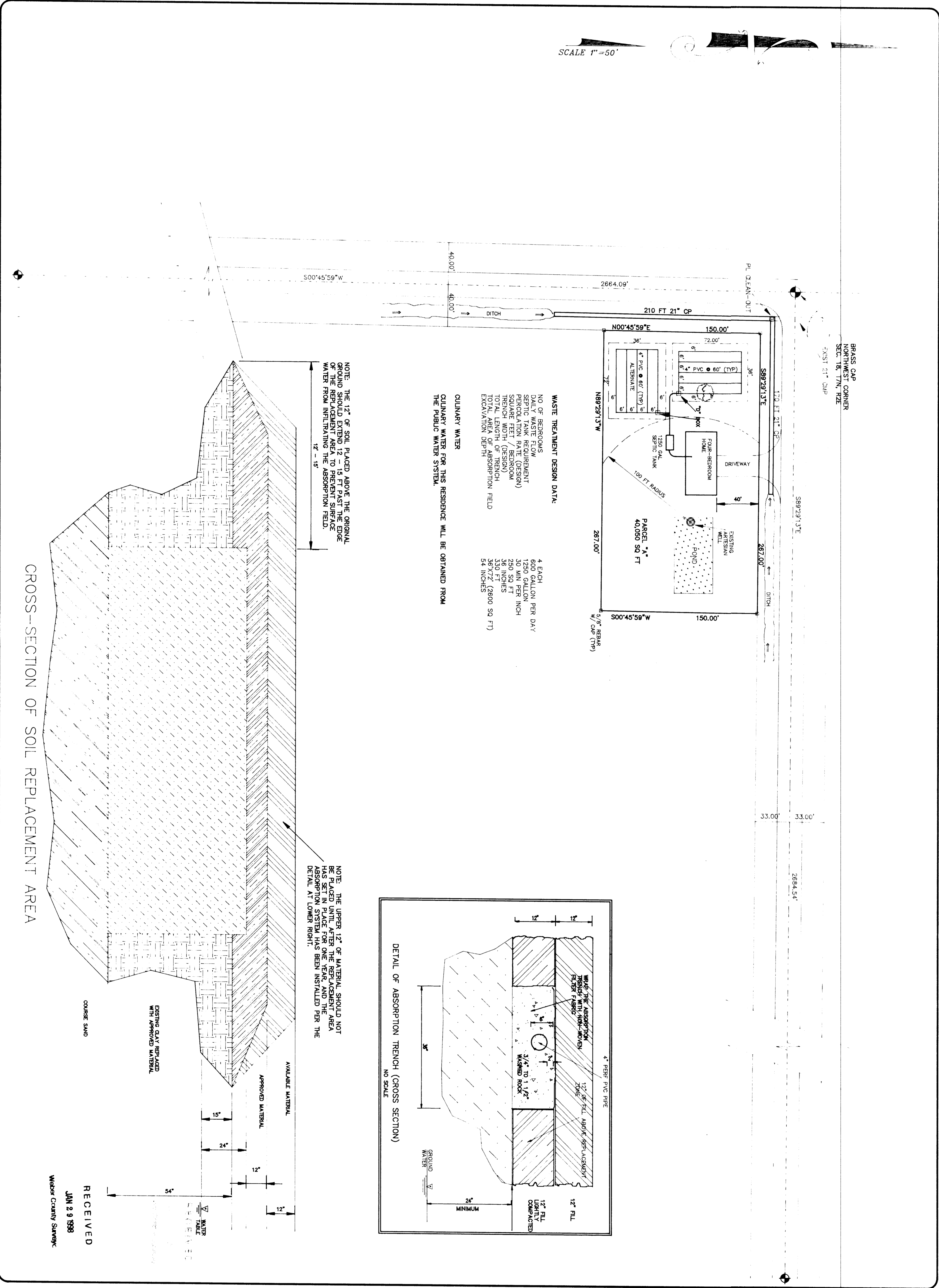

NOTE: THE 12" OF SOIL PLACED ABOVE THE ORIGINAL GROUND SHOULD EXTEND 12 TO 15 FEET PAST THE END OF THE ABSORPTION TRENCH TO PREVENT GROUND WATER FROM INFILTRATING THE ABSORPTION FIELD. 12" - 15"

WASTE TREATMENT DESIGN DATA:

NO. OF BEDROOMS: 4
 SEPTIC TANK REQUIREMENT: 1200 GALLON PER DAY
 PERCOLATION RATE (DESIGN): 30 MIN PER INCH
 SQUARE FEET / BEDROOM: 250 SQ FT
 TOTAL LENGTH OF TRENCH: 330 FEET
 TOTAL AREA OF ABSORPTION FIELD: 38'x72' (2800 SQ FT)
 EXCAVATION DEPTH: 54 INCHES

QUINARY WATER:
 QUINARY WATER FOR THIS RESIDENCE WILL BE OBTAINED FROM THE PUBLIC WATER SYSTEM.

NOTE: THE UPPER 12" OF MATERIAL SHOULD NOT BE RE-USED FOR THIS YEAR. THE ABSORPTION SYSTEM HAS BEEN INSTALLED PER THE DETAIL AT LOWER RIGHT.

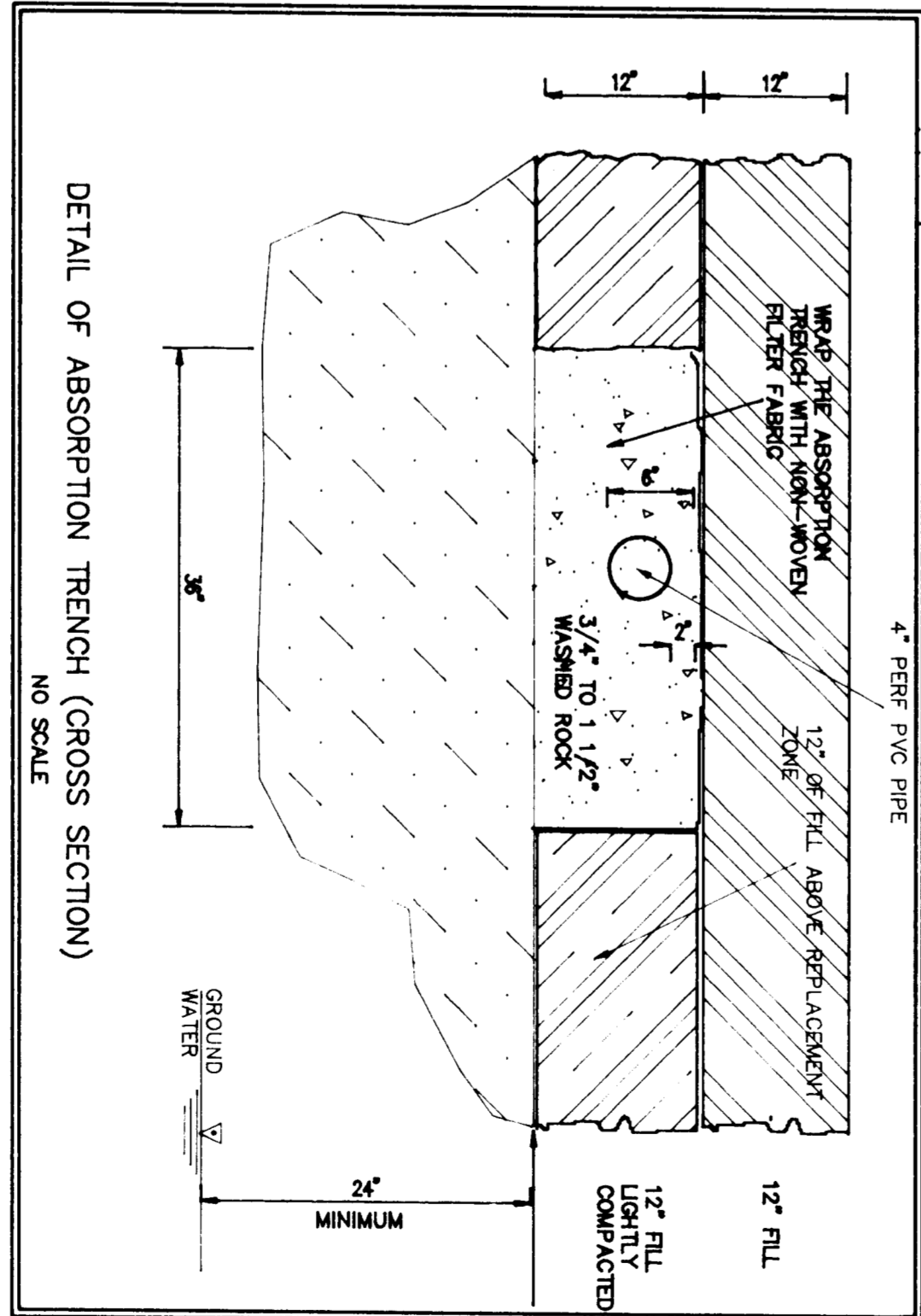

CROSS-SECTION OF SOIL REPLACEMENT AREA

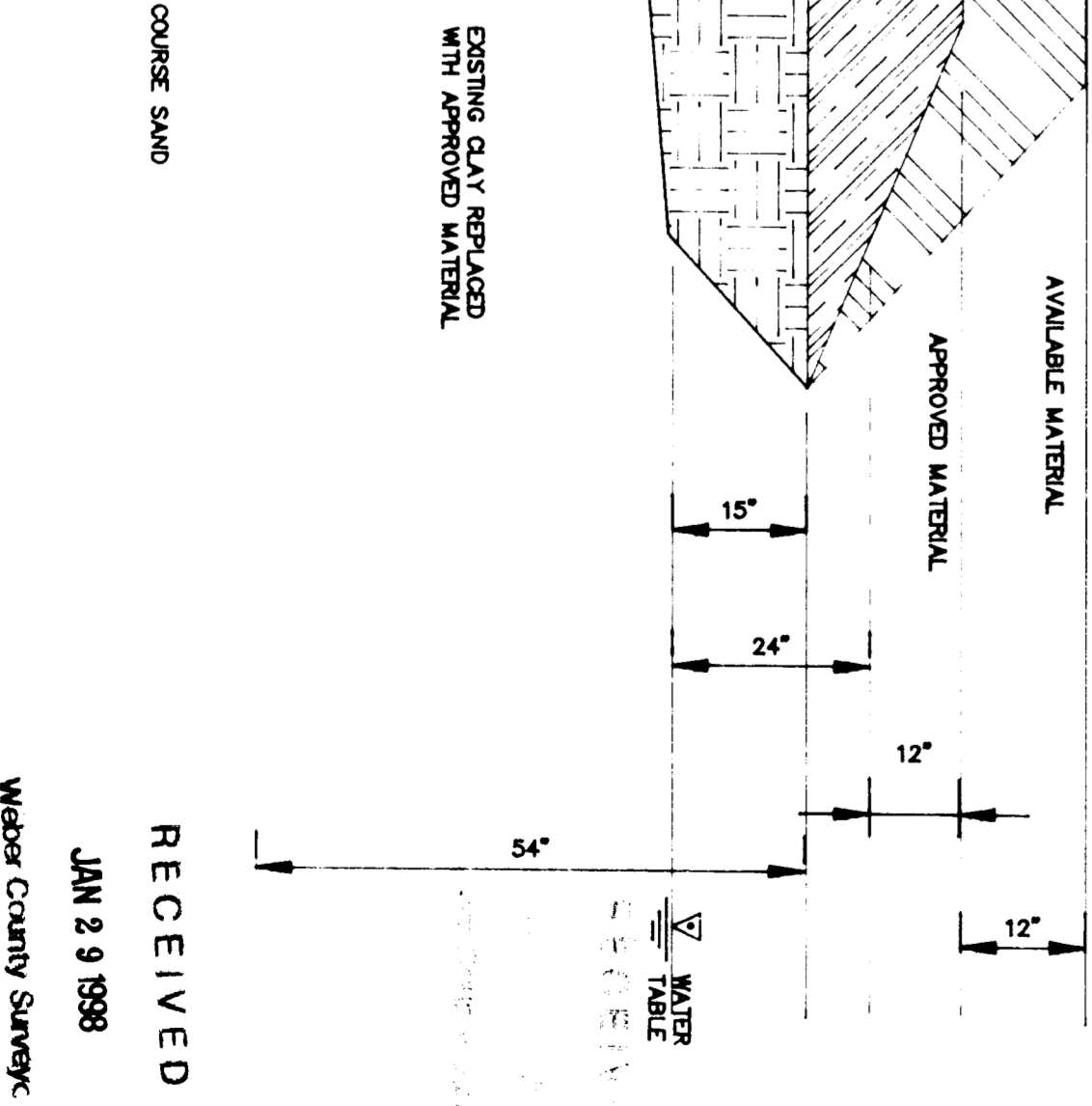

RECEIVED
 JAN 2 9 1998
 Wasatch County Sealer

ON-SITE WASTE TREATMENT SYSTEM
 300 NORTH 5900 WEST STREET
 WEST WARREN, UTAH,
 PART OF THE NW1/4 SECTION 3, T6N, R2W.

DESIGNED BY: WILLIAM HOLYOAK
 WILLIAM HOLYOAK
 ARCHITECT, INC.
 DATE: AUGUST, 1997

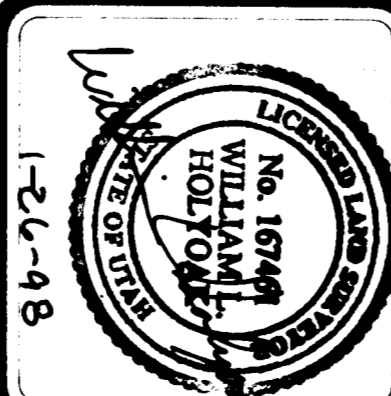

DATE	BY	REVISIONS	COMMENTS

MOUNTAIN ENGINEERING
 P.O. BOX 304
 MORGAN, UTAH 84201
 TEL (801) 952-7744