

BASIS OF BEARINGS
 THE BASIS OF BEARINGS OF THIS SURVEY IS THE TRUE LINE BETWEEN THE SOUTH QUARTER CORNER OF SAID SECTION 12 SHOWN HEREON AS WEST (INFORMATION TAKEN FROM THE MOUNTAIN WATERS SUBDIVISION)

NARRATIVE
 THE PURPOSE OF THIS PLAT IS TO DETERMINE THE BOUNDARY OF THE SUBJECT WESTLY SOUTH QUARTER CORNER AND THE SOUTHWEST CORNER OF SECTION 12 T.6N., R.1E., S.1&M. THE CASE ELECTED DURING THE DETERMINATION BY A DEPOSITION THE NORTH LINE FALLS NORTH OF AN EXISTING FENCE, BUT PROPERTY NORTH OF SAID FENCE HAS ON THE WEST LOST THROUGH ACTS OF POSSESSION IS THE FENCE BUT RECOMMENDATION IS EXCHANGED WITH THE ADJACENT TO MATCH THE SUBDIVISION BOUNDARY.

BOUNDARY DESCRIPTION
 PART OF THE SOUTHEAST QUARTER OF SECTION 12 T.6N., R.1W., S.1&M. U.S. SURVEY DESCRIBED AS FOLLOWS:
 BEGINNING AT A POINT ON THE EXTENSION OF A FENCE, SAID POINT BEING EAST ALONG THE SECTION LINE 194.54 FEET TO THE SOUTHWEST QUARTER CORNER OF SAID SECTION 12, THENCE S89°53'22"E 322.67' TO THE WEST END OF AN EAST-WEST FENCE, THENCE N88°36'55"E ALONG SAID FENCE 322.67 FEET, THENCE S89°53'22"E 98.37 FEET TO A POINT, THENCE S100°1'41"W 98.65' AND THENCE S02°38'59"E 444.77' TO THE POINT OF BEGINNING. SAID LINE 327.89 FEET TO THE POINT OF BEGINNING. CONTAINS: 4.27 ACRES

DEED DESCRIPTION
 A PART OF THE SOUTHWEST QUARTER OF SECTION 12, TOWNSHIP 6 NORTH, RANGE 1 EAST, S.1&M. U.S. SURVEY, BEGINNING AT A POINT 20.96 CHAINS EAST FROM THE WEST CORNER OF SAID QUARTER SECTION, THENCE NORTH 440.7 WEST 490.43 FEET, MORE OR LESS, TO MOST WEST NORTHWESTERLY CORNER OF PROPERTY CONVEYED BY THE BROWN WATER CONSERVANCY DISTRICT FORBIDDEN AUGUST 11, 1958 IN BOOK 587 OF RECORD PAGE 432, THENCE SOUTH 93°37' WEST 196.9 FEET ALONG SAID PROPERTY, THENCE SOUTH 43°37' EAST 303.1 FEET SECTION, THENCE WEST 333.24 FEET, MORE OR LESS, TO THE PLACE OF BEGINNING.

SURVEYOR'S CERTIFICATE
 I, RANDALL J. WILFORD, DEPOSE AND SAY THAT I AM A LICENSED PROFESSIONAL LAND SURVEYOR, MY LICENSE NUMBER IS 189437, AND THAT THE SURVEY AND PROPERTY DESCRIBED HEREON WAS PERFORMED BY ME OR UNDER MY DIRECTION, AND THAT THIS PLAT CORRECTLY DENOTES THE FINDINGS OF THE SURVEY.
 SIGNED THIS 26TH DAY OF APRIL 1998
 RANDALL J. WILFORD
 SURVEYOR
 189437
 Utah License Number

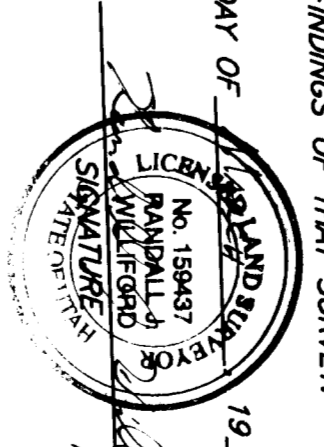

LEGEND
 -X-X- = EXISTING FENCE LINE
 - - - = CENTER LINE OF EXISTING DITCH
 [] = EXISTING PARKMENT

RECEIVED
 APR 14 1998
 Weber County Surveyor

WEST 327.89' (NORTH LINE OF CITY RIGHT-OF-WAY)

300 NORTH STREET

SOUTH QUARTER CORNER OF SECTION 12 T.6N., R.1E., S.1&M. EAST 1394.54'

REVISIONS

1		4
2		5
3		6

PROJECT NO. 304-01 SURVEYOR J. ANDERSON
 DATE 3-20-98 OWNER K. ANDERSON
 SCALE 1"=40' CHECKER

REEVE & ASSOCIATES, INC.
 ENGINEERS, PLANNERS & SURVEYORS
 3970 QUINCY AVE. SUITE 101
 (801) 421-0200 FAX (801) 421-2866
 (801) 421-0200 FAX (801) 421-2866
 TOLL-FREE 1-888-984-5100

RECORD OF SURVEY

SCOTT ANDERSON'S PROPERTY
 PART OF THE NORTHWEST QUARTER OF SECTION 12, T.6N., R.1E., S.1&M. U.S. SURVEY, MAP NO. 1898

SHEET 1 OF 1 SHEETS