

Contains 4.125 Acres

Twelfth Street

GIBSON AVENUE

**Description**

Beginning at a point on the South line of 12th Street, at a point North 89°03'15" West 1787.40 feet and South 0°40'15" West 33.0 feet from the Ogdan City Monument at the West Corporate City limit and 12th Street, said point also shown as being South 161.31 feet, more or less, East 893.05 feet, more or less, North 0°40'15" East 1271.25 feet, and South 89°03'15" East 14.0 feet from the West Quarter corner of Section 19, Township 6 North, Range 1 West, Salt Lake Base and Meridian, and running thence South 89°03'15" East 319.50 feet; thence South 0°40'15" West 563.15 feet; thence North 88°47'15" West 319.51 feet; thence North 0°40'15" East 561.66 feet to the point of beginning.

Contains 4.125 acres

**Narrative**

This survey was done at the request of Projects West in order to establish the boundaries to construct a fence. An Ogdan City Monument was found at the intersection of the West Corporate Limits and the monument line on 12th Street along with rebar at Gibson Avenue. A line extended through these points bearing North 89°03'15" West was used as a basis of bearings. The secondary tie to the Southwest corner of the Northwest Quarter Corner was omitted due to knowledge of corner being recently removed. The center of the Section was established by data from Ogdan City Plats. All Corners were monumented as depicted on the drawing.

**Certification**

I, Mark E. Babbitt, do hereby certify that I am a Registered Land Surveyor, and that I hold Certificate No. 166484, as prescribed by the Laws of the State of Utah, and I have made a survey of the above described property. I further certify that this plat correctly shows the true dimensions of the property surveyed.

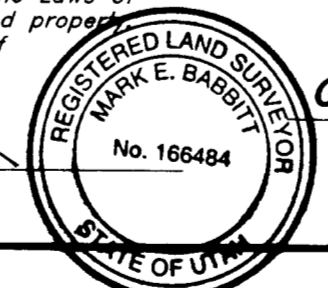

Date 1-20-98

Mark E. Babbitt

RECEIVED

APR 28 1998

Weber County Surveyor

<h1>Property Survey</h1>		<b>Projects West</b> I.R.S. Annex 1 Building 955 West 12th Street Ogdan, Utah, 84401 <small>A Part of the Northwest 1/4 of Section 19, T6N, R1W, SLB&amp;M.</small>	
 <b>GREAT BASIN ENGINEERING, INC.</b> CONSULTING ENGINEERS and SURVEYORS 3544 Lincoln Avenue, Ogdan, Utah, 84401 P.O. Box 9307, Ogdan, Utah, 84409 <small>Ogdan (801)384-4515 Salt Lake City (801)521-0222 Fax (801)382-7544</small>	DATE: 12 Dec, 1997	REVISIONS:	DRWG. NO.
	DRAWN: CT		PS-97-79
	SCALE: 1" = 40'	97-79	