

•SURVEYOR'S CERTIFICATE•

I, DOUG L. GRAHAM, A PROFESSIONAL LICENSED LAND SURVEYOR AS PRESCRIBED BY THE LAWS OF THE STATE OF UTAH AND HOLDING LICENSE NUMBER 172757 DO HEREBY CERTIFY THAT A SURVEY OF THE BELOW DESCRIBED PROPERTY WAS MADE UNDER MY DIRECTION AND THE PLAT HEREON IS A TRUE AND CORRECT REPRESENTATION OF SAID SURVEY, TO THE BEST OF MY KNOWLEDGE AND BELIEF.

DATE: JAN. 2nd 1998 SIGNED: [Signature]

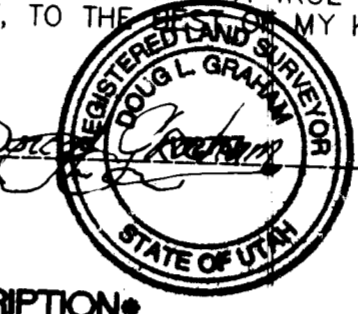

•BOUNDARY DESCRIPTION•

ALL OF LOTS 62 AND 63 IN PATIO SPRINGS SUBDIVISION, UNIT NO. 1, WEBER COUNTY, UTAH.

•NARRATIVE•

THE PURPOSE OF THIS SURVEY WAS TO SET THE PROPERTY BOUNDARY OF LOTS 62 AND 63 OF PATIO SPRINGS UNIT 1, AS A COMBINED PARCEL. EXISTING REBAR WERE FOUND AT THE CORNERS AS SHOWN, THE 1/2" REBAR APPEAR TO BE ORIGINAL TO THE LOTS, AND THE 5/8" REBAR A RESURVEY OF LOT 64. THE REBAR LOCATION TO THE DIMENSION AND BEARING OF THE ORIGINAL PLAT ARE AS SHOWN AND WERE ACCEPTED AS THE LOCATION OF THE PROPERTY CORNERS AND NO OTHERS WERE SET. BASIS OF BEARING IS PATIO SPRINGS SUBDIVISION BEARINGS BETWEEN FOUND STREET MONUMENTS.



SCALE - 1" = 50'

○ FOUND 1/2" REBAR
 ○ FOUND 5/8" REBAR, (REEVES ENCL)

LANDMARK SURVEYING
 A COMPLETE SURVEYING SERVICE
 2485 GRANT AVE. SUITE 818 DODD, UTAH 84401
 PH. 827-4014
 CLIENT: DONNA FRIZ
 2543 BONNEVILLE TERRACE DR.
 LOCATION: PATIO SPRINGS NO. 1
 SURVEYED: DEC. 20, 1997

REVISIONS:	DRAWN BY: DLG
	CHECKED BY:
	DATE: 12-20-97
	FILE: 1938

RECEIVED
 JUN 18 1998
 Weber County Surveyor