

SCALE: 1 INCH = 100 FEET

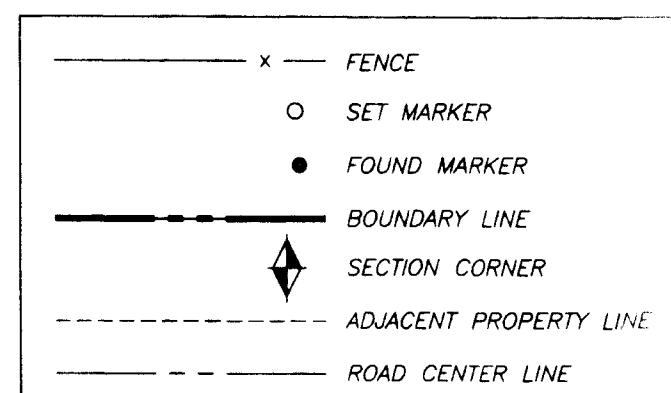

TAMI FOWERS
HOOPER, UT
PROJECT #98-267

LEGAL DESCRIPTION

SOUTH QUARTER CORNER, SECTION 18,
TOWNSHIP 5 NORTH, RANGE 2 WEST,
SALT LAKE BASE AND MERIDIAN
(BY COUNTY SURVEYOR RECORD)

PART OF THE SOUTHWEST QUARTER OF SECTION 18, TOWNSHIP 5 NORTH, RANGE 2 WEST, SALT LAKE BASE AND MERIDIAN DESCRIBED AS FOLLOWS:

BEGINNING NORTH 00°41'15" EAST ALONG THE WEST LINE OF THE SOUTHWEST QUARTER OF SAID SECTION 18, 794.13 FEET TO A POINT 50.00 FEET FROM THE CENTERLINE OF 5500 SOUTH STREET AND NORTH 89°50'30" EAST ALONG 5500 SOUTH STREET, 178.49 FEET FROM THE SOUTHWEST CORNER OF THE SOUTHWEST QUARTER OF SAID SECTION 18;
AND THENCE NORTH 89°50'30" EAST, 200.00 FEET;
THENCE SOUTH 00°58'40" WEST, 626.03 FEET;
THENCE NORTH 89°50'30" WEST, 200.00 FEET;
THENCE NORTH 00°58'40" EAST (N00°19'00" E BY RECORD), 626.03 FEET TO THE BEGINNING.

CONTAINING 2.87 ACRES +/-.

A 10.00 FEET WIDE EASEMENT WITH CENTERLINE DESCRIBED AS FOLLOWS:
BEGINNING NORTH 00°41'15" EAST ALONG THE WEST LINE OF THE SOUTHWEST QUARTER OF SAID SECTION 18, 794.13 FEET TO A POINT 50.00 FEET FROM THE CENTERLINE OF 5500 SOUTH STREET AND NORTH 89°50'30" EAST ALONG 5500 SOUTH STREET, 178.49 FEET FROM THE SOUTHWEST CORNER OF THE SOUTHWEST QUARTER OF SAID SECTION 18;
THENCE SOUTH 00°58'40" WEST, 626.03 FEET TO THE TERMINATION.

SURVEY NOTES:
1. BASIS OF BEARING FOR THIS SURVEY IS NORTH 00°03'01" EAST ALONG THE WEST LINE OF THE SOUTHWEST QUARTER OF SAID SECTION 18 AS INDICATED BY FOUND WEBER COUNTY WITNESS MONUMENTS.
2. THE PURPOSE OF THIS SURVEY IS TO DIVIDE THE PARCEL SHOWN FROM APPROXIMATELY 35 ACRES.
3. RETRACEMENT: THE WEST LINE OF THIS PARCEL ALLOWS RECORD DIMENSIONS TO WESTERLY PARCELS (GREAT BASIN, ANDERSON 1977). THERE IS A 0°39'40" CW ROTATION FROM ANDERSON TO CURRENT WEBER COUNTY.
THE NORTH LINE IS NEW ALLOWING 50.00 FEET FROM THE CENTERLINE OF 5500 SOUTH STREET. EAST LINE IS NEW USING THE SPECIFIED DIMENSION.
4. 2" RED AND PLASTIC AND SET AS SHOWN.

I, LAYNE J. SMITH, DO HEREBY CERTIFY THAT THIS IS A TRUE AND ACCURATE MAP OF LANDS SURVEYED UNDER MY SUPERVISION AND DIRECTION; AND THE MONUMENTS ARE FULLY AND CORRECTLY DESIGNATED THEREON.

LAYNE J. SMITH
LICENSE NO. 125801
STATE OF UTAH
DATE OF SURVEY: 12 JAN 1999

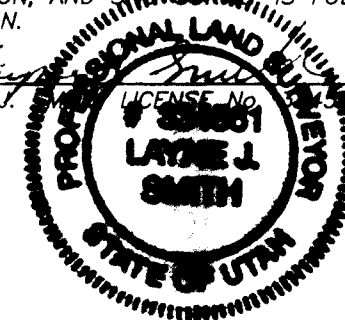

Knighnton and Crow P. C.
CIVIL AND STRUCTURAL ENGINEERING - LAND SURVEYING AND TESTING
50 West Golf Course Rd., Ogden, Utah 84421 Ph. (801) 732-4501 Fax. (801) 732-4507

5500 SO. 5500 W FOWERS BOUNDARY SURVEY

This document and the ideas incorporated herein, as an instrument of professional service, are the property of KNIGHTON AND CROW, P.C. and are not to be used in whole or in part, for any other project without the written authorization of an authorized representative of KNIGHTON AND CROW, P.C. Unauthorized use will be prosecuted to the fullest extent of the law.
Copyright © 1999 KNIGHTON AND CROW, P.C.

Project Number:	48-267
Drawn By:	L. SMITH
Date:	12 JAN 1999
Sheet Scale:	1" = 100'
Approved by:	
File Name:	C:\98-267\98-267.DWG

RECEIVED
MAR 30 1999
Weber County Surveyor

002183

002183