

NARRATIVE AND STATEMENT OF PURPOSE

THE PURPOSE OF THIS SURVEY IS TO DELINEATE THE ROY CITY PROPERTY BOUNDARIES, AND TO WRITE DESCRIPTIONS THAT BETTER DEFINE THE PROPERTY BY COMBINING FOUR DESCRIPTIONS INTO TWO.

DEED BEGINS WITH A POINT TO N 0°33'20"E, TO PROVIDE A BASIS FOR A SURVEY ON RECORD AT THE MOUNTAIN WEST PROFESSIONAL LAND SURVEYORS P.C. FOR ROY REDEVELOPMENT AGENCY WAS UTILIZED IN ESTABLISHING SOME OF THE BOUNDARIES.

SURVEYOR'S CERTIFICATE

I, DICK N. WICHMANN, A PROFESSIONAL LAND SURVEYOR NO. 155649 DO HEREBY CERTIFY THAT THIS PLAT WAS PREPARED FROM A SURVEY MADE ON THE GROUND BY ME AT THE REQUEST OF ROY CITY CORPORATION, AND IN BEHALF OF MOUNTAIN WEST PROFESSIONAL LAND SURVEYORS, L.L.C., AND IS TRUE AND CORRECT TO THE BEST OF MY KNOWLEDGE AND BELIEF.

DICK N. WICHMANN, P.L.S.
DATE: 10/9/99

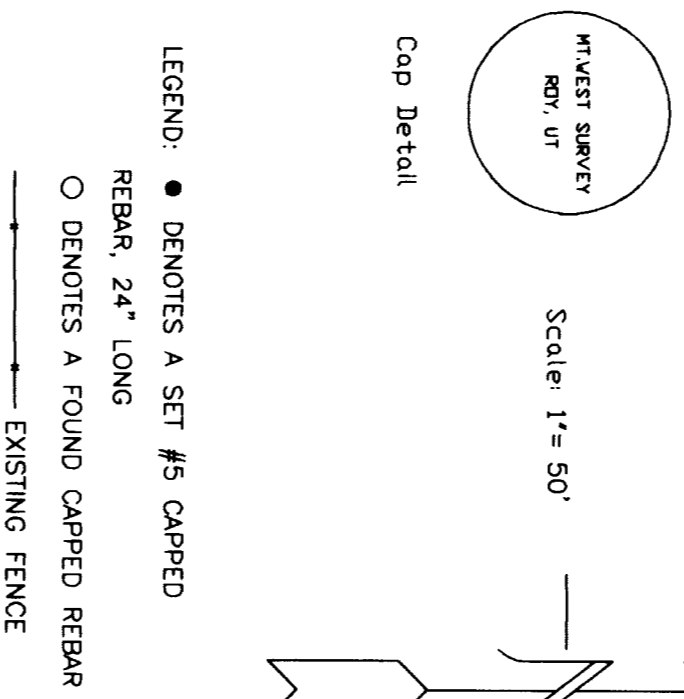

PROPERTY DESCRIPTION

BEGIN A PART OF THE NORTHWEST QUARTER OF SECTION 13, TOWNSHIP 5 NORTH, RANGE 2 WEST, SALT LAKE BASIN AND MERIDIAN AND DESCRIBED AS FOLLOWS:

1) BEGINNING AT A POINT WHICH IS N 0°33'20"E, 449.90 FEET AND S 89°28'40"E, 50.00 FEET AND S 89°28'40"E, 192.71 FEET FROM THE SOUTHWEST CORNER OF SAID NORTHWEST QUARTER OF SECTION 13, AND RUNNING: ALSO BEING THE SOUTHWEST CORNER OF PARCEL NUMBER 08-104-0019 AND RUNNING: N 0°33'20"E, ALONG THE EAST LINE OF SAID PARCEL, 210.14 FEET, TO THE SOUTH LINE OF HILLSIDE SUBDIVISION, LINE, THE FOLLOWING TWO COURSES:

- 1) S 89°12'58"E, 466.59 FEET;
- 2) N 44°47'52"E, 143.27 FEET;

THENCE, S 32°41'52"E, 123.56 FEET;

THENCE, S 89°12'58"E, 68.07 FEET, FOLLOWING THE COURSE OF SAID SOUTH LINE OF HILLSIDE SUBDIVISION, TO A CURVE TO THE RIGHT HAVING A RADIUS OF 75.25 FEET;

1) ALONG THE ARC OF SAID CURVE A DISTANCE OF 33.82 FEET, (LONG CHORD BEARS S 3°20'50" W, 54.5320 W, 20.00 FEET, TO A CURVE TO THE LEFT HAVING A RADIUS OF 124.75 FEET;

2) ALONG THE ARC OF SAID CURVE A DISTANCE OF 75.23 FEET, (LONG CHORD BEARS S 28°36'50" W, 74.09 FEET;

3) ALONG THE ARC OF SAID CURVE A DISTANCE OF 75.23 FEET, (LONG CHORD BEARS S 28°36'50" W, 74.09 FEET, TO THE NORTH LINE OF 5150 SOUTH STREET;

THENCE, N 89°08'40" W, ALONG SAID NORTH LINE, 627.29 FEET, TO THE POINT OF BEGINNING.

CONTAINS 3.45 ACRES, MORE OR LESS.

PROPERTY DESCRIPTION 5150 SOUTH STREET.

BEGIN A PART OF THE NORTHWEST QUARTER OF SECTION 13, TOWNSHIP 5 NORTH, RANGE 2 WEST, SALT LAKE BASIN AND MERIDIAN AND DESCRIBED AS FOLLOWS:

1) BEGINNING AT A POINT ON THE EAST LINE OF 1900 WEST STREET SAID POINT BEING THE POINT OF BEGINNING OF SAID WEST STREET, AND RUNNING: S 89°08'40"E, 819.80 FEET, TO THE WEST LINE OF 1750 WEST STREET;

2) THENCE, S 11°20'20" W, ALONG SAID WEST LINE, 61.02 FEET, TO THE NORTH LINE OF PARCEL NUMBER 08-104-0019;

3) THENCE, ALONG SAID NORTH LINE, 808.33 FEET, THENCE N 0°33'20"E, 60.00 FEET TO THE POINT OF BEGINNING.

CONTAINS 1.12 ACRES, MORE OR LESS.

RECORDED
OCT 9 1999

RECORD OF SURVEY

ROY CITY CORPORATION
for

Subd. Dec. 1999, No. JLD-01-59
 Located in the Northwest One-Quarter of Section 13, Township 5 North, Range 2 West, S.L.B.M.
 Mountain West Professional Land Surveyors, L.L.C.
 1825 V. 400 S. PO Box 207
 Provo, UT 84601
 Phone: (801) 733-5299 Fax: (801) 726-5201