

BASE OF BEARINGS

THE BASE OF BEARINGS FOR THIS PLAT IS THE UTM COORDINATE SYSTEM (1983) NORTH ZONE AS DETERMINED LOCALLY BY THE LINE BETWEEN THE 77N, R1E, S16&M, U.S. SURVEY SHOWN HEREON AS 8992244 W.

NARRATIVE PARCEL 'A'

THE PURPOSE OF THIS SURVEY IS TO DEFINE THE CORNER & CLARK BOUNDARY LINE WAS DETERMINED BY THE NORTHERN, RIGHT-OF-WAY LINE OF NORTH RIVER DRIVE. THE EASTERN LINE WAS DETERMINED BY THE 28 T1N, R1E. ALL OTHER LINES WERE DETERMINED BY DEEDS. CORNERS WERE MARKED WITH A 5/8" REBAR AND CAP UNLESS OTHERWISE NOTED ON THE PLAT.

NARRATIVE PARCEL 'B'

THE PURPOSE OF THIS SURVEY IS TO DEFINE THE CORNER & CLARK AND DONA S. CLARK PROPERTIES FOR TOWN CLARK. THE SOUTHERLY BOUNDARY LINE WAS DETERMINED BY THE NORTHERN, RIGHT-OF-WAY LINE OF STATE HIGHWAY 152. THE EASTERN LINE WAS DETERMINED BY THE 28 T1N, R1E. ALL OTHER LINES WERE DETERMINED BY DEEDS. CORNERS WERE MARKED WITH A 5/8" REBAR AND CAP UNLESS OTHERWISE NOTED ON THE PLAT.

NARRATIVE PARCEL 'C'

THE PURPOSE OF THIS SURVEY IS TO DEFINE THE CORNER & CLARK AND DONA S. CLARK PROPERTIES FOR TOWN CLARK. THE SOUTHERLY BOUNDARY LINE WAS DETERMINED BY THE NORTHERN, RIGHT-OF-WAY LINE OF STATE HIGHWAY 152. THE EASTERN LINE WAS DETERMINED BY THE 28 T1N, R1E. ALL OTHER LINES WERE DETERMINED BY DEEDS. CORNERS WERE MARKED WITH A 5/8" REBAR AND CAP UNLESS OTHERWISE NOTED ON THE PLAT.

SURVEYED DESCRIPTION PARCEL 'A'

PART OF THE SOUTHWEST QUARTER OF SECTION 28, T1N, R1E, S16&M, U.S. SURVEY, DESCRIBED AS FOLLOWS:
 BEGINNING AT A POINT ON THE NORTHERN, RIGHT-OF-WAY LINE OF STATE HIGHWAY 152, 771.17 FEET AND 16021.74' E 1905.53 FEET FROM THE SOUTHWEST CORNER OF SAID SECTION 28, THENCE NORTH 15°13'13" E 561.03 FEET, THENCE EAST 12°15'13" E 201.94 FEET, THENCE SOUTH 89°40'27" W 288.00 FEET, THENCE WEST 79°59'27" E 124.41 FEET, THENCE SOUTH AND 1°1' EAST SOUTH AND 1°1' EAST PROPERTY CORNER. THE EASTERN LINE WAS DETERMINED BY THE 28 T1N, R1E. ALL OTHER LINES WERE DETERMINED BY DEEDS. CORNERS WERE MARKED WITH A 5/8" REBAR AND CAP UNLESS OTHERWISE NOTED ON THE PLAT.

SURVEYED DESCRIPTION PARCEL 'B'

PART OF THE SOUTHWEST QUARTER OF SECTION 28, T1N, R1E, S16&M, U.S. SURVEY, DESCRIBED AS FOLLOWS:
 BEGINNING AT A POINT ON THE NORTHERN, RIGHT-OF-WAY LINE OF STATE HIGHWAY 152, 771.17 FEET AND 16021.74' E 1905.53 FEET FROM THE SOUTHWEST CORNER OF SAID SECTION 28, THENCE NORTH 00°44'25" E 339.46 FEET, THENCE EAST 00°17'14" W 596.53 FEET, THENCE SOUTH 5°04'17" W 497.86 FEET, THENCE WEST 12°15'13" E 561.03 FEET, THENCE SOUTH AND 1°1' EAST SOUTH AND 1°1' EAST PROPERTY CORNER. THE EASTERN LINE WAS DETERMINED BY THE 28 T1N, R1E. ALL OTHER LINES WERE DETERMINED BY DEEDS. CORNERS WERE MARKED WITH A 5/8" REBAR AND CAP UNLESS OTHERWISE NOTED ON THE PLAT.

SURVEYED DESCRIPTION PARCEL 'C'

PART OF THE SOUTHWEST QUARTER OF SECTION 28, T1N, R1E, S16&M, U.S. SURVEY, DESCRIBED AS FOLLOWS:
 BEGINNING AT A POINT ON THE NORTHERN, RIGHT-OF-WAY LINE OF STATE HIGHWAY 152, 771.17 FEET AND 16021.74' E 1905.53 FEET FROM THE SOUTHWEST CORNER OF SAID SECTION 28, THENCE NORTH 00°44'25" E 339.46 FEET, THENCE EAST 00°17'14" W 596.53 FEET, THENCE SOUTH 5°04'17" W 497.86 FEET, THENCE WEST 12°15'13" E 561.03 FEET, THENCE SOUTH AND 1°1' EAST SOUTH AND 1°1' EAST PROPERTY CORNER. THE EASTERN LINE WAS DETERMINED BY THE 28 T1N, R1E. ALL OTHER LINES WERE DETERMINED BY DEEDS. CORNERS WERE MARKED WITH A 5/8" REBAR AND CAP UNLESS OTHERWISE NOTED ON THE PLAT.

CURVE DATA

NUMBER	DELTA	CHORD	TANGENT	RAIUS	LENGTH	CHORD
01	1720.291	N 20°43'46" W	65.46	144.42	111.84	121.46
02	1720.291	S 69°42'19" E	127.83	326.28	142.90	148.15
03	1720.291	S 69°42'19" E	127.83	326.28	142.90	148.15
04	2219.571	S 67°42'46" E	281.37	1465.20	578.97	575.21
05	0945.926	S 67°29'46" E	92.51	1463.20	124.92	124.91
06	0945.926	S 67°29'46" E	92.51	1463.20	124.92	124.91
07	0046.526	S 69°12'07" E	18.50	3762.28	77.00	77.02
08	0714.271	S 72°25'10" E	92.74	1463.20	185.21	185.11
09	1923.570	S 64°50'32" E	198.69	1463.20	593.74	592.23

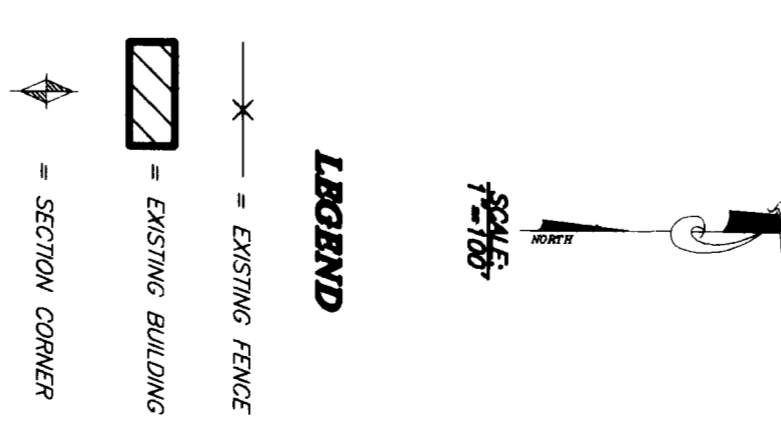

REVISIONS

1.		
2.		
3.		
4.		
5.		
6.		

PROJECT NO. 2812-014
DATE NOVEMBER 12, 1988
SCALE 1"=100'

DRAWN BY J. A. COOPER
CHECKED BY J. A. COOPER

REEVE & ASSOCIATES, INC.
 Civil Engineering • Structural Engineering
 Surveying • Land Planning • Landscape Architecture
 3670 QUINCY AVE. STE. #1
 CODEN, IOWA 50201
 (801) 521-5353 FAX (801) 621-2666
 89 W. 100.56, STE. #110
 LEXAKA, IOWA 52524
 (515) 265-5353 FAX (515) 792-2286

RECORD OF SURVEY

CLARKE PROPERTY
 PART OF THE SOUTHWEST QUARTER OF SECTION 28, T1N, R1E, S16&M, U.S. SURVEY
 DRAWN BY J. A. COOPER
 JULY, 1989

SHEET 1
SHEETS 1