

002663

SURVEYOR'S CERTIFICATE

I, RONALD J. WILLIAMS, DEPOSE AND SAY THAT I AM A LICENSED SURVEYOR IN THE STATE OF UTAH AND THAT THE SURVEY HEREON WAS PERFORMED BY ME OR UNDER MY DIRECTION, AND THAT THIS PLAN CORRECTLY DEPICTS THE FINDINGS HEREON.

SIGNED THIS 15TH DAY OF FEBRUARY 2002.

159437

UTAH LICENSE NUMBER

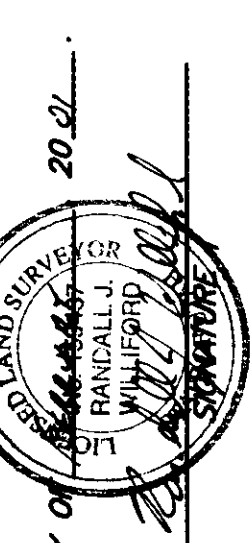

LEGEND

- = SECTION CORNER
- = EXISTING FENCE
- = EXISTING PAVEMENT
- = EXISTING BUILDING

BASIS OF BEARINGS

THE BASIS OF BEARINGS FOR THIS PLAN IS THE UTAH COORDINATE SYSTEM UTM ZONE 12N, EPOCH 1982. THE POINT OF BEGINNING IS THE SOUTHWEST CORNER AND THE SOUTHWEST CORNER OF SECTION 36, T.6N., R.2W., S.L.B.84, U.S. SURVEY, SHOWN HEREON AS: S891709.7W

NARRATIVE

THE PURPOSE OF THIS SURVEY IS TO DEFINE THE STATE OF UTAH DIVISION OF STATE LANDS INTEREST IN THE SOUTHWEST QUARTER OF SECTION 36, T.6N., R.2W., S.L.B.84, U.S. SURVEY, SHOWN HEREON AS: S891709.7W. THE SOUTH-EAST RIGHT-OF-WAY LINE OF MIDLAND DRIVE, THE EAST LINES WERE FIRED BY AN EXISTING FENCE AND BY DEED. THE SOUTH LINE WAS FIRED BY DEED. SET REBAR AND RED CAP MARKED 'REEVE & ASSOC.' AT ALL BOUNDARY CORNERS.

SURVEY DESCRIPTION

PART OF THE SOUTHWEST QUARTER OF SECTION 36, T.6N., R.2W., S.L.B.84, U.S. SURVEY, DESCRIBED AS FOLLOWS:
 BEGINNING AT A POINT ON A FENCE, SAID POINT BEING S891709.7W ALONG THE SECTION LINE 609.45 FEET AND N00°42'51"W, 832.23 FEET FROM THE SOUTHWEST CORNER OF SAID SECTION 36; THENCE N89°26'28"W, 616.27 FEET TO THE SOUTHEAST RIGHT-OF-WAY LINE OF MIDLAND DRIVE; THENCE S44°28'02"W, 41.00 FEET, THENCE N89°46'00"E, 28.05 FEET TO SAID EXISTING FENCE; THENCE ALONG SAID FENCE S00°15'43"W, 88.91 FEET AND S00°46'48"W, 399.23 FEET TO THE POINT OF BEGINNING.
 CONTAINS: 4.70 ACRES

DEED DESCRIPTION

BOOK: 1380 PAGE: 1673
 A PART OF THOSE PORTIONS OF LOT 1, IN THE SOUTHWEST QUARTER OF SECTION 36, T.6N., R.2W., S.L.B.84, U.S. SURVEY DESCRIBED AS FOLLOWS:
 BEGINNING AT A POINT EAST 824 FEET, MORE OR LESS, ALONG THE SOUTH LINE OF SAID SECTION 36, THE POINT OF BEGINNING BEING THE POINT OF BEGINNING OF SAID SECTION 36, THENCE S89°26'28"W, 616.27 FEET TO THE SOUTHEAST RIGHT-OF-WAY LINE OF MIDLAND DRIVE; THENCE S44°28'02"W, 41.00 FEET, MORE OR LESS, ALONG SAID FENCE; THENCE N89°46'00"E, 28.05 FEET, MORE OR LESS, TO THE 1/16 SECTION LINE FROM THE SOUTHWEST CORNER OF SAID SECTION 36 TO THE POINT OF BEGINNING; THENCE S00°15'43"W, 88.91 FEET, MORE OR LESS, TO THE EAST LINE OF SAID LOT 1; THENCE S00°46'48"W, 399.23 FEET, MORE OR LESS, TO A POINT SOUTH 89°52' EAST 608.98 FEET ALONG THE SECTION LINE AND NORTH 89°52' EAST 718.92 FEET ALONG THE SECTION LINE AND NORTH 89°52' EAST 718.92 FEET ALONG THE SECTION LINE TO THE SOUTHWEST CORNER OF SAID SECTION 36; THENCE NORTH 89°52' WEST 472.99 FEET, MORE OR LESS, TO THE SOUTHEASTLY RIGHT-OF-WAY LINE OF THE ABANDONED GREGG SHORT LINE RAILROAD; THENCE NORTH 83°00'30" EAST 682.82 FEET ALONG SAID RIGHT-OF-WAY LINE TO THE POINT OF BEGINNING.

RECEIVED

FEB 16 2001
 WEBER COUNTY SURVEY
 MONUMENT, PUBLIC CORNER #11,
 CONCRETE, 2" BECON SURFACE (1978)
 WEBER COUNTY SURV.

THESE PLANS AND SPECIFICATIONS ARE THE PROPERTY OF REEVE & ASSOC., INC., 3920 QUINCY AVE., GORSEN, UTAH. CHANGES AND SHALL NOT BE CORRECTED OR REDDED ON REPRODUCTION WITHOUT THEIR WRITTEN PERMISSION.

STATE OF UTAH DIVISION OF STATE LANDS
 PART OF THE SOUTHWEST QUARTER OF SECTION 36, T.6N., R.2W., S.L.B.84, U.S. SURVEY
 FEBRUARY, 2001

RECORD OF SURVEY

REEVE & ASSOCIATES, INC.
 Civil Engineering • Structural Engineering
 Surveying • Land Planning • Landscape Architecture
 3920 QUINCY AVE., SUITE 110
 GORSEN, UTAH 84403
 (801) 827-3100 FAX (801) 827-2666 (435) 792-3303 FAX (435) 792-2266

PROJECT NO. _____ SURVEYOR: RENEE L. GORSEN
 DATE: _____ DRAWN: _____
 SCALE: _____ CHECKED: _____

REVISIONS

1.	_____
2.	_____
3.	_____

002663

002663

