

BASIS OF BEARINGS
THE BASIS OF BEARINGS FOR THIS PLAT IS THE OGDEN CITY ATLAS, AS DETERMINED LOCALLY BY THE LINE BETWEEN THE TWO QUARTERS OF THE OGDEN CITY ATLAS, THE WEST HALF OF BIRNFORD AVENUE AND PIERCE AVENUE AND 29th STREET AND PIERCE AVENUE, SHOWN HEREON AS: S00°58'00"W

NARRATIVE
THE PURPOSE OF THIS PLAT IS TO DEFINE THE REAL PROPERTY FOR ALFRED E. SHAUCEO. ALL LINES WERE FIXED BY THE OGDEN CITY ATLAS PLAT D AS DETERMINED BY THE FOUND CITY MONUMENT IN PIERCE AVENUE.

SURVEYED DESCRIPTION
ORIGINAL SURVEY MAP NO. 102-50, PAGE 1803, THE EAST 1/2 FEET OF LOT 12 OF LOT 12 AND THE SOUTH HALF OF THE VACATED ALLEY TO THE NORTH IN NGR HILL ANNEX, OGDEN CITY, WEBER COUNTY, UTAH, AND ALSO PART OF THE U.S. SURVEY, MORE PARTICULARLY DESCRIBED AS FOLLOWS:
BEGINNING AT A POINT ON THE NORTH RIGHT-OF-WAY LINE OF 27th STREET, SAID POINT BEING S00°58'00"W ALONG THE CENTERLINE OF PIERCE AVENUE 382.47 FEET, S89°02'00"E 689.00 FEET AND N07°58'00"E 33.00 FEET FROM THE FOUND OGDEN CITY MONUMENT; THENCE S89°02'00"E 162.66 FEET; THENCE S89°02'00"E 70.00 FEET TO THE WEST RIGHT-OF-WAY LINE OF BUCHANAN AVENUE; THENCE S00°58'00"W ALONG SAID WEST RIGHT-OF-WAY LINE AND NORTH LINE OF SAID 27th STREET 118.86 FEET; THENCE S00°58'00"W AND NORTH LINE 70.00 FEET TO THE POINT OF BEGINNING.
CONTAINS: 11,886 SQUARE FEET

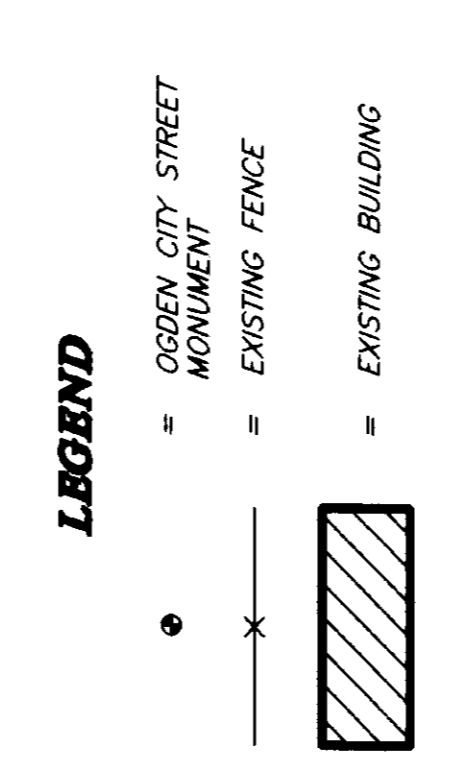

SURVEYOR'S CERTIFICATE
I, LYLE C. BASSINGER, DEPOSE AND SAY THAT I AM A LICENSED SURVEYOR IN THE STATE OF UTAH AND THAT THE SURVEY WAS PERFORMED BY ME OR UNDER MY DIRECTION, AND THAT THIS PLAT CORRECTLY DEPICTS THE FINDINGS OF SAID SURVEY.
SIGNED THIS 22nd DAY OF OCTOBER 2001
LYLE C. BASSINGER
UTAH LICENSE NUMBER 376082



REVISIONS

1			
2			
3			

REVEE & ASSOCIATES, INC.
Civil Engineering & Surveying
Surveying & Structural Engineering
EXECUTIVE BLDG. 4155 S. HARRISON BLVD. #710 S. 95 W. 100 S. STE. #427
OGDEN, UTAH 84403 LOCAL UTAH 8427
(801) 871-5167 FAX (801) 871-8666 (435) 752-3303 FAX (435) 752-2266

RECORD OF SURVEY

FISHER PROPERTY
PART OF THE NORTHEAST QUARTER OF SECTION 24, T.8N., R.7W., S.L.R.8M., U.S. SURVEY OGDEN CITY, JULY, 2001

RECEIVED
OCT 23 2001
Weber County Surveyors

THESE PLANS AND SPECIFICATIONS ARE THE PROPERTY OF REVEE & ASSOC. INC. 1670 QUINCY AVE. OGDEN, UTAH, 84403 AND SHALL NOT BE COPIED OR REPRODUCED WITHOUT THEIR WRITTEN PERMISSION.

SHEET 1
SHEETS 1