

SURVEYOR'S CERTIFICATE
 TO RESPECTIVE DESIGN, INC., AND FIRST AMERICAN TITLE INSURANCE COMPANY:
 THIS IS TO CERTIFY THAT THIS MAP OR PLAT AND THE SURVEY ON WHICH IT IS BASED
 WERE MADE (1) IN ACCORDANCE WITH MINIMUM STANDARD DETAILS REQUIREMENTS FOR
 ALTA/ASCM LAND TITLE SURVEYS, JOINTLY ESTABLISHED AND ADOPTED BY ALTA AND
 ASCM IN 1987 AND INCLUDES THE FOLLOWING ITEMS OF TABLE A THEREOF: 1, 2, 3, 4,
 5, 8, 9, 10, 11, AND (2) PURSUANT TO THE ACCURACY STANDARDS (AS ADOPTED BY
 ALTA AND ASCM AND IN EFFECT ON THE DATE OF THIS CERTIFICATION) OF URBAN
 SURVEY.

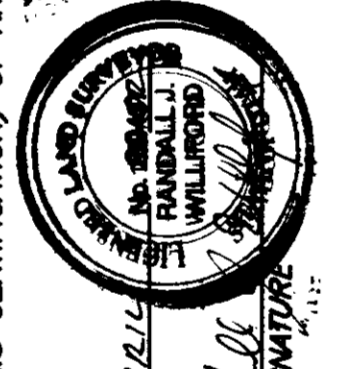

SIGNED THIS 19th DAY OF APRIL, 2002
 199437
 UTAH LICENSE NUMBER

BASIS OF BEARINGS
 THE BASIS OF BEARINGS FOR THIS PLAT IS THE OGDEN CITY ATLAS AS DETERMINED
 LOCALLY BY THE LINE BETWEEN THE TWO FOUND OGDEN CITY STREET MONUMENTS IN
 THE NE 1/4 OF SECTION 17, T.6N., R.1W., S.1B.M., U.S. THE SOUTH
 AVENUE SHOWN THEREON AS: S06°58'00\"/>

NARRATIVE
 THE PURPOSE OF THIS SURVEY IS TO CREATE AN ALTA / ASCM SURVEY OF A
 PORTION OF THE SOUTHWEST QUARTER OF SECTION 17, T.6N., R.1W., S.1B.M., U.S.
 LINE WAS TIED BY DEED AS DETERMINED BY A PREVIOUS REEVE AND ASSOCIATES
 SURVEY. ALL OTHER LINES WERE TIED BY CLIENT REQUEST.

TITLE DESCRIPTIONS

- TITLE ITEMS**
 FIRST AMERICAN TITLE INSURANCE COMPANY; UTAH DIVISION
 TITLE COMMITMENT NO. 00129343 DATED: FEBRUARY 4,
 2002
1. TAXES
 2. ANY FACTS, RIGHTS, INTERESTS, OR CLAIMS
 3. EASEMENTS, CLAIMS OF EASEMENTS OR ENCUMBRANCES WHICH ARE NOT SHOWN BY THE PUBLIC RECORDS.
 4. DISCREPANCIES, CONFLICTS IN BOUNDARY LINES.
 5. UNPATEMPTED MINING CLAIMS.
 6. LIENS
 7. DEFECTS, LIENS, ENCUMBRANCES, ADVERSE CLAIMS
 8. TAXES
 9. SAID PROPERTY IS LOCATED WITHIN THE BOUNDARIES OF WEBER BASIN WATER CONSERVANCY DISTRICT, AND IS SUBJECT TO THE CHARGES AND ASSESSMENTS LEVIED THEREUNDER.
 10. RIGHT-OF-WAY EASEMENT FOR HIGHWAY PURPOSES (RECORDED APRIL 28, 1938 AS BOOK: 131 AT PAGE: 21. EASEMENT IS CONTAINED WITHIN WALL AVENUE RIGHT-OF-WAY
 11. ACCESS TO AND FROM WALL AVENUE IS LIMITED TO THOSE AREAS PERMITTED BY THE STATE ROAD COMMISSION OF UTAH.
 12. TRUST DEED
 13. TRUST DEED
 14. TAXES
 15. TAXES
 16. TAXES
 17. JUDGMENT

LEGAL DESCRIPTION
 PART OF THE SOUTHWEST QUARTER OF SECTION 17, T.6N., R.1W., S.1B.M., U.S. SURVEY, DESCRIBED AS FOLLOWS:
 BEGINNING AT A POINT ON THE WEST RIGHT-OF-WAY LINE OF WALL AVENUE, SAID POINT BEING S00°58'00\"/>

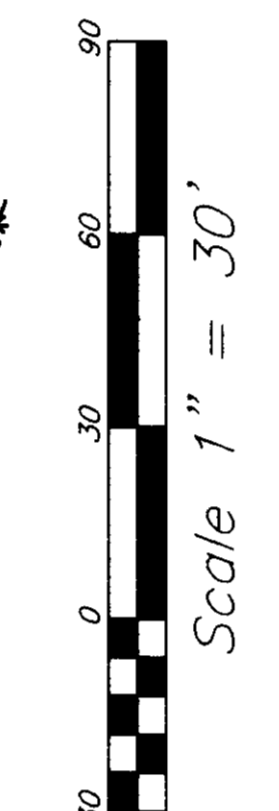

UTILITIES

NOTE:
 UTILITY LINES AND TELEPHONE LINES ARE ABOVE GROUND AND RUN ON POWER POLES

FOR LOCATIONS, CALL BLUE STAKES AT 1-801-532-5000
 ELECTRIC: PHOTOGRAPH 1439 N. 2560 S. OGDEN, UT. 84401 PHONE: (801) 629-4462
 TELEPHONE: US WEST (801) 629-5421
 GAS: OWEST 2974 WASHINGTON BLVD. OGDEN, UT 84401
 WATER & SEWER: OGDEN CITY PUBLIC WORKS 2484 WASHINGTON BLVD. OGDEN, UT. 84401 PHONE: (801) 629-8989
 ELECTRIC LINES AND TELEPHONE LINES ARE ABOVE GROUND AND RUN ON POWER POLES

ZONING & SETBACKS
 ZONE DESIGNATION: M-1
 FRONT YARD: 20'. INCLUDES BUILDINGS, PARKING, LOADING AND UNLOADING.
 - ALL 20' SHALL BE LANDSCAPED AND MAINTAINED BY PROPERTY OWNER

FLOOD ZONE DESIGNATION
 ZONE C
 PANEL NO-180189 0003 B
 EFFECTIVE DATE: 1-19-1983

LEGEND

- EXISTING BUILDING
- EXISTING PAVEMENT
- SIDE WALK
- GAS LINE
- WATER LINE
- SEWARY SEWER LINE
- STORM DRAIN LINE
- EXISTING SEWER MANHOLE
- STORM DRAIN CATCH BASIN
- FIRE HYDRANT
- POWER POLE
- GUARD POST

DETAILS

- RECEIVED
- APR 29 02
- Webb County Survey
- 002857

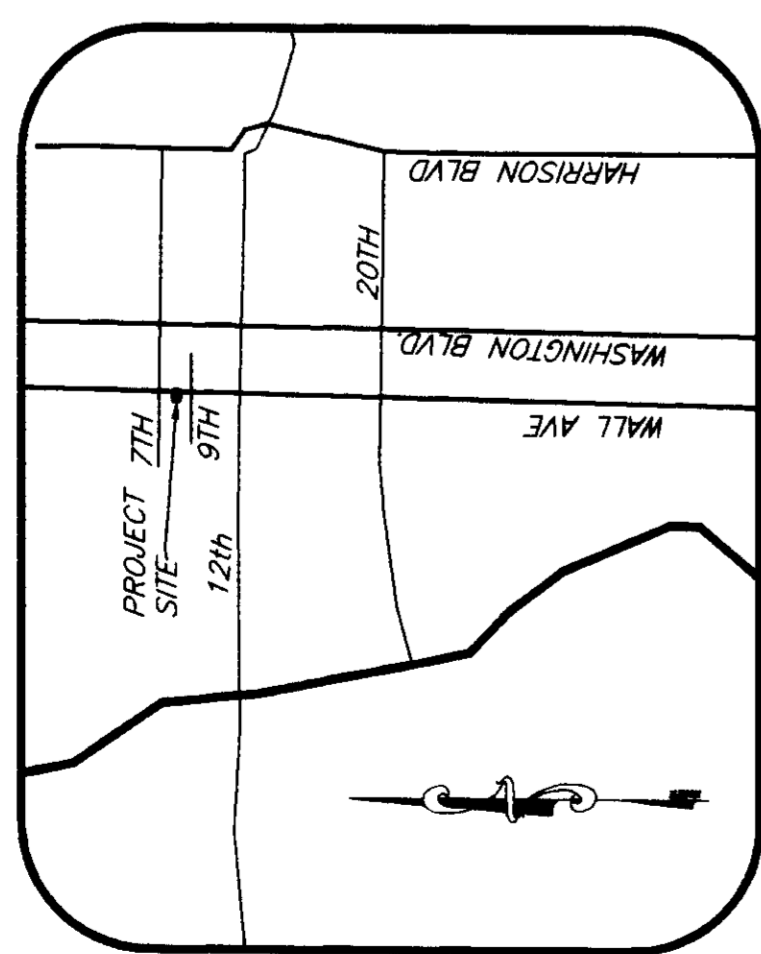

VICINITY MAP

SHEET 1

AQUA AIRE 'THE RAIN MAKERS' INC
 PART OF THE SOUTHWEST QUARTER OF SECTION 17, T.6N., R.1W., S.1B.M., U.S. SURVEY
 OGDEN CITY, WEBER COUNTY, UTAH
 MAP NO. 282

ALTA / ASCM

REEVE & ASSOCIATES, INC.
 Civil Engineering • Structural Engineering
 Surveying • Land Planning • Landscape Architecture
 EXECUTIVE BLDG. OGDEN, UTAH 84403 P.O. BOX 1710
 (801) 621-3100 FAX (801) 621-2666

PROJECT NO. _____ SURVEYOR _____
 DATE: 3-12-02 DRAWN: A. BERT
 SCALE: 1"=30' CHECKED: _____

REVISIONS

1.	_____
2.	_____
3.	_____
4.	_____
5.	_____
6.	_____