

Description PARCEL 1 Combined
 A portion of the Northeast Quarter of Section 23, Township 6 North, Range 3 West, Salt Lake Base and Meridian, the basis of bearing being South 89°14'17" East between the North Quarter Corner and the Northeast Corner of said Section 23, being more particularly described as follows:
 Commencing at a point located South 00°38'41" West 38.87 feet along quarter section line to the south line of the state road right-of-way as monumented from the North Quarter Corner of said Section 23,
 thence South 88°57'35" East 519.75 feet along said right-of-way line to a fence line extended,
 thence South 00°38'41" West 504.55 feet along a fence line,
 thence North 89°21'21" West 428.75 feet,
 thence North 00°38'36" East 85.00 feet,
 thence North 89°21'28" West 91.00 feet to quarter section line being evidenced by an existing old fence line,
 thence North 00°38'41" East 423.13 feet along said line to the point of beginning,
 Containing 5.8639 acres, more or less.

LEGEND
 FOUND CORNER (as labeled)
 SET REBAR & CAP (#5x24") Stamped WEBER COUNTY SURVEY
 PROPERTY LINES
 FENCE LINES
 DEED LINES
 RECORD DATA IN PARENTHESIS ()

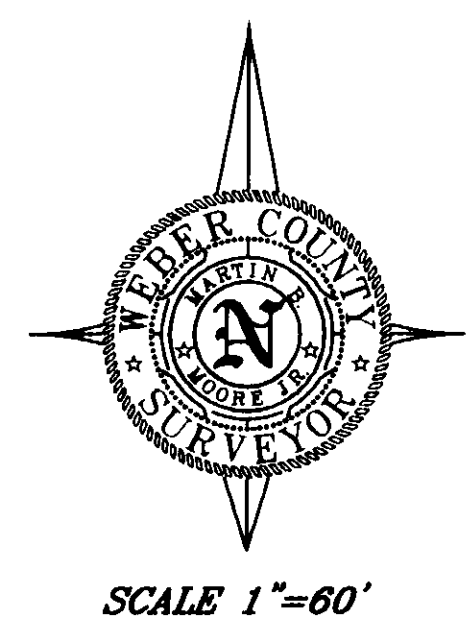

SCALE 1"=60'

WEBER COUNTY SURVEYOR'S CERTIFICATE
 I, ERNEST D. ROWLEY, HAVING BEEN DULY APPOINTED AS CHIEF DEPUTY WEBER COUNTY SURVEYOR, DO HEREBY DECLARE THAT WE, OF THE WEBER COUNTY SURVEYOR'S OFFICE, OF THE STATE OF UTAH, HAVE MADE A SURVEY OF THE TRACT OF LAND SHOWN HEREON. THIS PLAT HAS BEEN PREPARED FROM THE ORIGINAL FIELD NOTES MADE DURING THIS SURVEY AND HAS BEEN COMPILED AND DRAFTED AS AN ACCURATE RECORD OF THE SURVEY MADE.

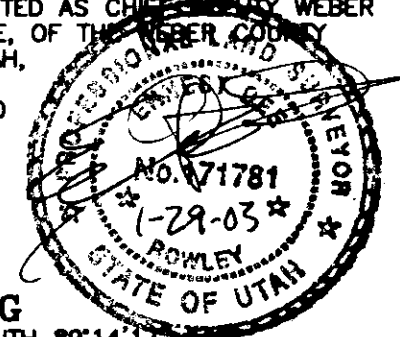

BASIS OF BEARING
 BETWEEN THE NORTH QUARTER CORNER AND THE NORTHEAST CORNER OF SECTION 23, TOWNSHIP 6 NORTH, RANGE 3 WEST, SALT LAKE BASE AND MERIDIAN, WHICH BASIS IS ON THE WEBER COUNTY STATE PLANE SYSTEM AS OF THE DATE OF THIS SURVEY.

NARRATIVE
 THIS SURVEY IS A CONTINUATION OF THE PARK PROPERTY AS PREVIOUSLY FILED IN THE OFFICE OF THE COUNTY SURVEYOR AS FILE NUMBER'S 001224 AND 001489. SEE THE NARRATIVE OF EACH FILING FOR DISCUSSION OF PROPERTY LINE DETERMINATIONS. SAID SURVEYS ARE BEING MADE A PART OF THIS FILING BY THIS REFERENCE.
 SINCE THE TIME OF THE PREVIOUS SURVEYS THE PARKS HAVE PURCHASED SOME ADDITIONAL PROPERTY FROM ELAINE STOREY. THE PURCHASE IS RECORDED AT BOOK 1873 PAGE 1652 IN THE DEED RECORDS OF WEBER COUNTY, UTAH. THE DESCRIPTIONS USED WERE TAKEN FROM THE TAX RECORDS OF THE COUNTY AND ONE BEING A REMAINING PARCEL DESCRIPTION WHICH CONTAINS ERRORS. THE DESCRIPTIONS HAVE BEEN ROTATED TO THE STATE PLANE BASIS THAT IT BEING USED IN THIS SURVEY.
 THE ONLY CORNERS OF THESE PROPERTIES THAT HAVE BEEN STAKED ARE THE ONES SHOWN HEREON. ONE OF THE PROPERTY CORNERS FELL IN THE LAWN OF AN ADJOINER AND RATHER THAN SETTING A REBAR IN THE LAWN WE SET TWO WITNESS CORNERS NEAR THE FENCE AS NOTED HEREON. THE PARKS DEPARTMENT WAS NOTIFIED OF THE LOCATION OF THE CORNER AND IT WAS SUGGESTED THAT THEY CONTACT THE PROPERTY OWNER AND NEGOTIATE A LAND TRADE TO THE FENCES.
 WE ALSO SURVEYED THE LOCATION OF A BARN THIS TIME FOR GRAPHIC PLOTTING PURPOSES TO SHOW ITS LOCATION IN RELATION TO THE FENCING AND THE DEED LINE.
 WE WERE ONLY REQUESTED TO SET THE SOUTH LINE OF THE PARKS OWNERSHIP AS PURCHASED. NO ATTEMPT HAS BEEN MADE IN THIS SURVEY TO CLEAR ANY CLOUD WHICH MAY EXIST DUE TO THE GAP PROBLEM NORTH OF THE 91 FOOT COURSE AS SHOWN HEREON.
 A SINGLE DESCRIPTION OF THE PARK PROPERTY HAS BEEN WRITTEN AND INCLUDED ON THIS PLAT WHICH COULD BE USED TO COMBINE THE SEPERATE DESCRIPTIONS AND BOUNDARY LINE AGREEMENT INTO ONE PARCEL.

RECEIVED
 JAN 29 2005
 Weber County Surveyors

PROPERTY LINE SURVEY FOR COUNTY PARK
 PART OF THE NE 1/4 OF SECTION 23,
 TOWNSHIP 6 NORTH, RANGE 3 WEST,
 SALT LAKE BASE AND MERIDIAN

Plot Prepared By
 Ernest D. Rowley P.S.L.
 Chief Deputy Surveyor

WEBER COUNTY
 2510 Washington Blvd. Mezz. #1
 Ogden, Utah 84401
 (801) 399-8371

SURVEY FILING BLOCK
 RECEIVED ON THE _____
 DAY OF _____
 19____

002987
 FILING NUMBER

FENCE CORNER 1
 SEE NARRATIVE
 FROM RECORD OF
 SURVEY #001224 &
 # 001489

NO FENCES WERE SURVEYED
 SOUTH OF THIS POINT ON THE
 WEST SIDE OF THE STREET

WEBER COUNTY SURVEYOR'S OFFICE - AUTOMATIC TRACKING SYSTEM - FILE - 001489