

**Utility Company Information**

**AT&T**  
U.S. West Communications  
1000 West 10th Street  
Irvine, CA 92610  
Phone: (949) 251-5555  
Attention: Joe Sawyer

**Southern California Gas**  
1000 West 10th Street  
Irvine, CA 92610  
Phone: (949) 251-5555  
Attention: Joe Sawyer

**Water**  
City of Irvine  
1000 West 10th Street  
Irvine, CA 92610  
Phone: (949) 251-5555  
Attention: Joe Sawyer

**Electric**  
Southern California Edison  
1000 West 10th Street  
Irvine, CA 92610  
Phone: (949) 251-5555  
Attention: Joe Sawyer

**Telephone**  
Southern California Edison  
1000 West 10th Street  
Irvine, CA 92610  
Phone: (949) 251-5555  
Attention: Joe Sawyer

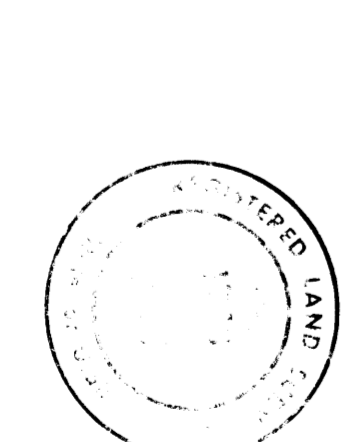

**DESCRIPTION**

A part of Lots 7-8 and 16-20, Block 4, Woodhams's Main Street Addition to Ogden City, Weber County, Utah:

Beginning at the Southwest Corner of said Lot 18; running thence North 0°58' East 137.00 feet (137.10 feet) along the East line of Washington Boulevard; thence South 89°02' East 194.30 feet; thence South 0°58' West 19.00 feet (19.01 feet); thence South 9°58' East 100.00 feet to the West line of Ogden Avenue; thence North 9°58' West 100.00 feet (50.04 feet) along said West line; thence North 89°02' West 129.30 feet; thence South 0°58' West 68.00 feet (68.05 feet) to the South line of said Lot 9; thence North 89°02' West 165.00 feet along said line to the point of beginning.

Contains 29,649 Square Feet or 0.681 Acre

**TO AUTOZONE, INC., AND FIRST AMERICAN ASSOCIATED TITLE COMPANY:**

This is to certify that this map or plat and the survey on which it is based were made in accordance with "Minimum Standard Detail Requirements for ALTA/ACSM Land Title Surveys." Jointly established and adopted by ALTA and ACSM in 1988, meets the accuracy requirements of a Class A Survey, as defined therein, and includes Items 1-15 of Table 3 thereof. For purposes of identifying encumbrances, rights-of-way and private restrictive covenants or record, the undersigned has relied upon title insurance commitment No. W1720 issued by Associated Title Company and dated October 23, 1989.

Date: 11-7-89

*Henry L. Howard*  
Henry L. Howard  
Surveyor No. 9718

**Notes:**

This property lies within zone C of the Flood Insurance Rate Map (FIRM) No. 90101A0010, dated January, 1985. Zone C is an area of moderate flooding (10 stories).

**Survey:**

Primary Station: 7200 - 42472  
Secondary Station: 420 - 4240  
4 - 44 have copper (these places)

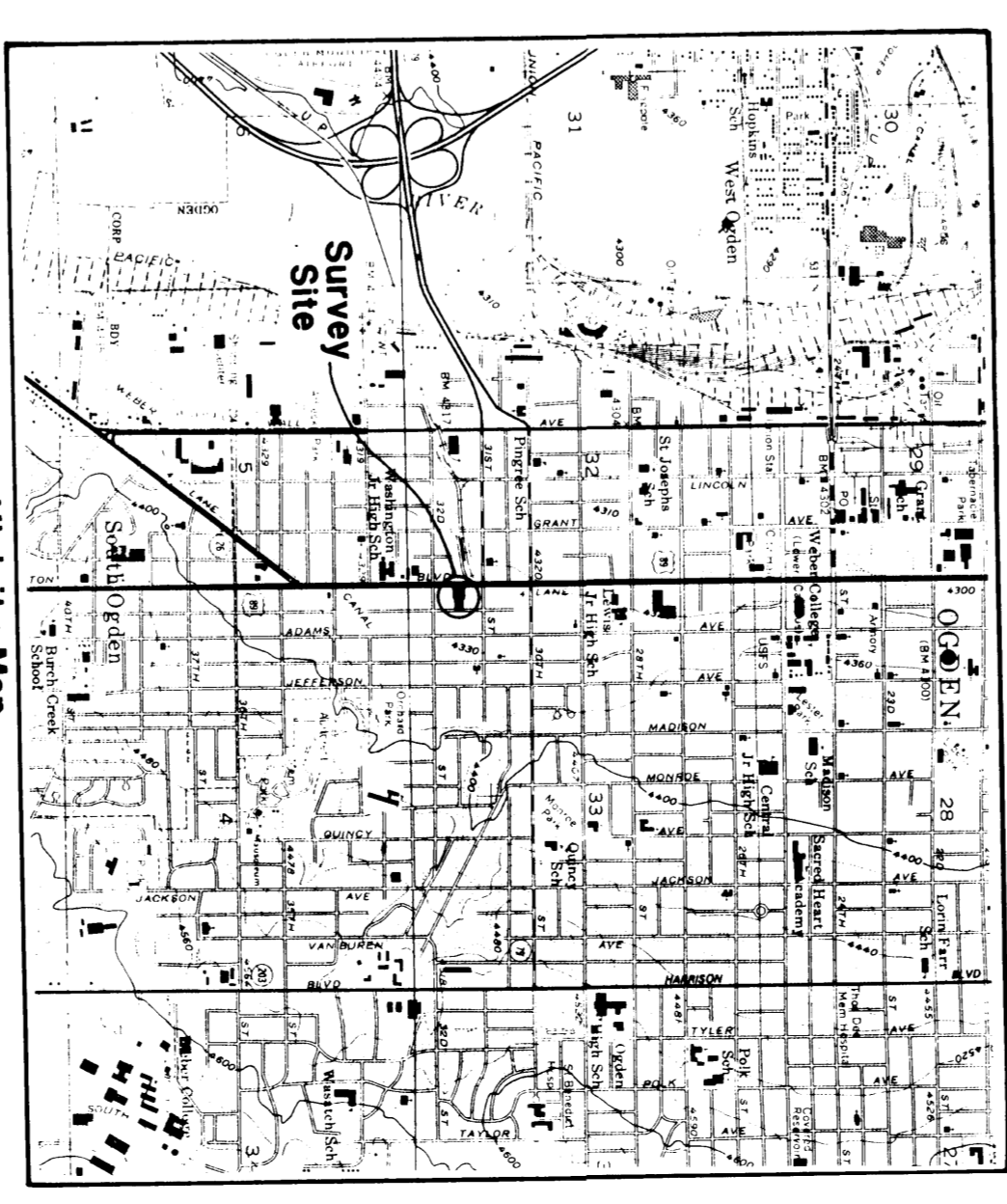

**Scale: 1" = 20'**

0 10 20 40

**North Arrow**

**Notes:**

The boundary shown for this survey is the Ogden City Standard 1/4" = 1" scale map. The boundary shown for this survey is the Ogden City Standard 1/4" = 1" scale map. The boundary shown for this survey is the Ogden City Standard 1/4" = 1" scale map.

**Public Road:**

As shown on the subdivision map, the public road is required to be wider than 50.000 feet. The public road is shown as 50.000 feet wide and is shown to be wider than 50.000 feet wide.

**Mobile Office:**

Mobile Office Building

**House:**

House

**Utility Information:**

Utility Information

**Legend:**

Legend

**Scale:**

Scale: 1" = 20'

**Vicinity Map:**

Vicinity Map