

SURVEYORS GENERAL NOTE

I, Bryan B. Buchanan, do hereby certify that I am a Registered Land Surveyor and that I hold my Certificate No. 338339 as provided by the State of Utah, and that I have conducted a survey on the ground as shown on this plat.

006103

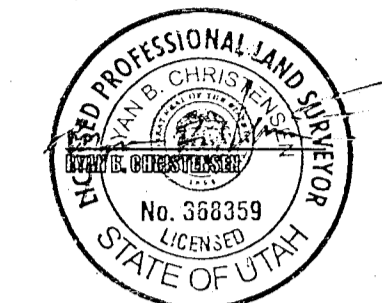

SURVEYORS NARRATIVE

THE PURPOSE OF THIS SURVEY WAS TO MONUMENT THE EXTERIOR OF MR. LOFTUS' PROPERTY AND THEN TO MONUMENT AND PREPARE LEGAL DESCRIPTIONS FOR THE RE-CONFIGURATION OF THIS PROPERTY AS SHOWN ON THIS RECORD OF SURVEY. TO DETERMINE THE LOCATION OF THE WILCOX CAMPING AND BOATING RESORT IT WAS NECESSARY TO FIND THE SOUTH 1/4 CORNER OF SECTION 16. WITH THE HELP OF VARIOUS WEBCAM COUNTY SURVEYOR OFFICE DATA WE WERE ABLE TO FIND THE LOCATION OF THIS WITHIN CORNER FOR THE SOUTH 1/4 CORNER OF SECTION 16 AS SHOWN. THIS POSITION OF THIS 1/4 CORNER AS IT WAS WHEN THIS SUBDIVISION WAS PLATTED WAS THEN ABLE TO BE DETERMINED. THEY DETERMINED THAT THE WASTERLY LINE OF WILCOX CAMPING AND BOATING RESORT WAS INTENDED TO PARALLEL THE SOUTHERLY SECTION LINE OF SECTION 16. THIS WAS THE BASIS OF BEARING FOR THIS SURVEY AS SHOWN. UPON PROCEEDING WITH THIS SURVEY IT WAS DISCOVERED THE BOUNDARY OF SAID SECTION 16 DID NOT CLOSE MATHEMATICALLY AND ALL BECAME MASTERED INTO THE CLOSING BEARING. MANY OTHER PROBLEMS WERE DISCOVERED ON THE INTERIOR OF SAID SURVEY. THESE PROBLEMS WERE INTENDED TO INTERPRET THE INTENT OF THIS PLAT. I BELIEVE THE INTENT WAS FOR ALL LOT LINES TO RUN 88°30'00" W FROM THE SOUTHERLY BOUNDARY OF THIS SECTION TO THE INTERSECTION OF THE WESTERLY BOUNDARY. ANY DISTANCE DISCREPANCIES ALONG THE WESTERLY BOUNDARY WERE PROPORTIONED. THESE BEARING ANGLES AND DISTANCE POINTS IN THIS SURVEY WERE MADE TO USE THE DISTANCES SHOWN ON THIS SUBDIVISION PLAT FOR LOT DEPTH AND ANY GAP WOULD BE CONSIDERED THE 1/4 RIGHT OF WAY. THERE IS AN ACCESS ROAD SHOWN ON THE RECORD OF SURVEY THAT HAS BEEN USED FOR THE PURPOSES OF ACCESS AND EGRESS BY PROPERTY OWNERS UP THE CANYON FROM THIS PROPERTY. THIS ROAD MAY HAVE REFINED INTO A PROSCRIPTIVE EASEMENT.

DESCRIPTION FOR PARCEL A

ALL OF LOTS 1 AND 2 AND PART OF LOT 3, WILCOX CAMPING AND BOATING RESORT MORE PARTICULARLY DESCRIBED AS FOLLOWS: BEGINNING AT A REBAR AND CAP AT THE NE CORNER OF LOT 1, WILCOX CAMPING AND BOATING RESORT, RUNNING THENCE S87°41'14" W 154.45' ALONG THE EASTERLY LINE OF SAID WILCOX CAMPING AND BOATING RESORT TO A REBAR AND CAP; THENCE S74°11'41" W 172.33' TO A REBAR AND CAP ON THE EASTERLY SIDE OF A 16' RIGHT OF WAY; THENCE N31°48'41" W 70.21' ALONG SAID RIGHT OF WAY TO A REBAR AND CAP; THENCE N49°25'34" W 109.25' ALONG SAID RIGHT OF WAY TO A REBAR ON THE NORTHERLY LINE OF SAID WILCOX CAMPING AND BOATING RESORT; THENCE S89°44' E 178.17' ALONG THE NORTHERLY LINE OF SAID WILCOX CAMPING AND BOATING RESORT TO THE POINT OF BEGINNING. SUBJECT TO ANY WRITTEN OR UNWRITTEN EASEMENTS THAT MAY EXIST ON THE PROPERTY.

CONTAINS 0.57 ACRES, 24841.74 SQUARE FEET, AND 667.26' AROUND PERIMETER

DESCRIPTION FOR PARCEL B

PART OF LOT 3, ALL OF LOT 4 AND PART OF LOT 5, WILCOX CAMPING AND BOATING RESORT MORE PARTICULARLY DESCRIBED AS FOLLOWS: BEGINNING AT A REBAR AND CAP AT THE SE CORNER OF PARCEL A, SAID POINT BEING S87°15' E 194.00' ALONG THE EASTERLY LINE OF SAID WILCOX CAMPING AND BOATING RESORT FROM THE NE CORNER OF LOT 1; THENCE S87°15' E 119.25' ALONG THE EASTERLY LINE OF SAID WILCOX CAMPING AND BOATING RESORT TO A REBAR AND CAP; THENCE S51°33' 43" W 48.45' TO A ROCK WALL; THENCE 3 COURSES ALONG SAID WALL AS FOLLOWS: S73°38'17" W 18.49', N8°38'44" W 31.21', N86°01'14" W 31.21'; THENCE S66°04'51" W 86.29' TO A REBAR AND CAP ON THE EASTERLY SIDE OF A 16' RIGHT OF WAY; THENCE S69°07'41" W 64.69' ALONG SAID RIGHT OF WAY TO A REBAR AND CAP; THENCE N59°15'46" W 68.63' ALONG SAID RIGHT OF WAY TO A REBAR AND CAP AT THE SW CORNER OF PARCEL A; THENCE N7°41'41" E 115.81' ALONG THE SOUTHERLY LINE OF SAID PARCEL A TO THE POINT OF BEGINNING. SUBJECT TO ANY WRITTEN OR UNWRITTEN EASEMENTS THAT MAY EXIST ON THE PROPERTY.

CONTAINS 1.49 ACRES, 21404.46 SQUARE FEET, AND 619.83' AROUND PERIMETER

DESCRIPTION FOR PARCEL C

PART OF LOTS 6, 4 AND 7, WILCOX CAMPING AND BOATING RESORT MORE PARTICULARLY DESCRIBED AS FOLLOWS: BEGINNING AT A REBAR AND CAP AT THE SE CORNER OF PARCEL B, SAID POINT BEING S87°15' E 282.25' ALONG THE EASTERLY LINE OF SAID WILCOX CAMPING AND BOATING RESORT FROM THE NE CORNER OF LOT 1; THENCE S87°15' E 272.80' ALONG THE EASTERLY LINE OF SAID WILCOX CAMPING AND BOATING RESORT TO A REBAR AND CAP; THENCE S23°28' 39" W 47.49' TO A REBAR AND CAP ON THE EASTERLY SIDE OF A 16' RIGHT OF WAY; THENCE ALONG SAID RIGHT OF WAY N48°06'00" W 73.16' TO A REBAR AND CAP AT THE SW CORNER OF PARCEL B, RUNNING THENCE N40°06'00" W 82.03' TO A ROCK WALL; THENCE 3 COURSES ALONG SAID WALL AS FOLLOWS: S86°10'14" E 31.21', S18°38'44" E 11.49', N73°32'17" E 12.49'; THENCE N52°45' E 46.45' ALONG THE SOUTHERLY LINE OF SAID PARCEL B TO THE POINT OF BEGINNING. SUBJECT TO ANY WRITTEN OR UNWRITTEN EASEMENTS THAT MAY EXIST ON THE PROPERTY.

CONTAINS 0.17 ACRES, 7701.12 SQUARE FEET, AND 435.11' AROUND PERIMETER

DESCRIPTION FOR PARCEL D

PART OF LOTS 6, 7, AND 8, WILCOX CAMPING AND BOATING RESORT MORE PARTICULARLY DESCRIBED AS FOLLOWS: BEGINNING AT A REBAR AND CAP AT THE SE CORNER OF PARCEL C, SAID POINT BEING S87°15' E 330.25' ALONG THE EASTERLY LINE OF SAID WILCOX CAMPING AND BOATING RESORT FROM THE NE CORNER OF LOT 1; THENCE S87°15' E 327' ALONG THE EASTERLY LINE OF SAID WILCOX CAMPING AND BOATING RESORT TO A REBAR AND CAP; THENCE S64°47' 58" W 127.45' TO A REBAR AND CAP ON THE EASTERLY SIDE OF A 16' RIGHT OF WAY; THENCE ALONG SAID RIGHT OF WAY N48°06'00" W 64.63' TO A REBAR AND CAP AT THE SW CORNER OF PARCEL C, RUNNING THENCE N54°25'04" E 159.25' ALONG THE SOUTHERLY LINE OF SAID PARCEL C TO THE POINT OF BEGINNING. SUBJECT TO ANY WRITTEN OR UNWRITTEN EASEMENTS THAT MAY EXIST ON THE PROPERTY.

CONTAINS 0.18 ACRES, 7989.54 SQUARE FEET, AND 388.25' AROUND PERIMETER

DESCRIPTION FOR PARCEL E

PART OF LOTS 8 AND 9, WILCOX CAMPING AND BOATING RESORT MORE PARTICULARLY DESCRIBED AS FOLLOWS: BEGINNING AT A REBAR AND CAP AT THE SE CORNER OF PARCEL D, SAID POINT BEING S87°15' E 390' ALONG THE EASTERLY LINE OF SAID WILCOX CAMPING AND BOATING RESORT FROM THE NE CORNER OF LOT 1; THENCE S87°15' E 380' ALONG THE EASTERLY LINE OF SAID WILCOX CAMPING AND BOATING RESORT TO A REBAR AND CAP AT THE SE CORNER OF LOT 9 SAID WILCOX CAMPING AND BOATING RESORT; THENCE S48°30' W 124.00' TO A REBAR AND CAP ON THE EASTERLY SIDE OF A 16' RIGHT OF WAY; THENCE ALONG SAID RIGHT OF WAY N48°06'00" W 43.69' TO A REBAR AND CAP AT THE SW CORNER OF PARCEL D; RUNNING THENCE N54°25'04" E 154.45' ALONG THE SOUTHERLY LINE OF SAID PARCEL D TO THE POINT OF BEGINNING. SUBJECT TO ANY WRITTEN OR UNWRITTEN EASEMENTS THAT MAY EXIST ON THE PROPERTY.

CONTAINS 0.16 ACRES, 7014.38 SQUARE FEET, AND 367.34' AROUND PERIMETER

DESCRIPTION FOR PARCEL F

PART OF LOTS 6, 7, AND 8, WILCOX CAMPING AND BOATING RESORT MORE PARTICULARLY DESCRIBED AS FOLLOWS: BEGINNING AT A REBAR AND CAP AT THE SE CORNER OF PARCEL C, SAID POINT BEING S87°15' E 386.88' ALONG THE EASTERLY LINE OF SAID WILCOX CAMPING AND BOATING RESORT FROM THE NE CORNER OF LOT 1; THENCE S87°15' E 49.32' ALONG THE EASTERLY LINE OF SAID WILCOX CAMPING AND BOATING RESORT TO A REBAR AND CAP; THENCE S64°47' 58" W 127.45' TO A REBAR AND CAP ON THE EASTERLY SIDE OF A 16' RIGHT OF WAY; THENCE ALONG SAID RIGHT OF WAY N48°06'00" W 43.69' TO A REBAR AND CAP AT THE SW CORNER OF PARCEL C; RUNNING THENCE N54°25'04" E 147.93' ALONG THE SOUTHERLY LINE OF SAID PARCEL C TO THE POINT OF BEGINNING. SUBJECT TO ANY WRITTEN OR UNWRITTEN EASEMENTS THAT MAY EXIST ON THE PROPERTY.

CONTAINS 0.16 ACRES, 6805.96 SQUARE FEET, AND 383.06' AROUND PERIMETER

RECORD OF SURVEY FOR:
NOLAN LOFTUS
PART OF THE SE 1/4 OF SECTION 16
T6 N R 2 E, SALT LAKE BASE AND MERIDIAN
PREPARED BY:
CHRIS-CORP
2779 E 2450 N,
LAYTON, UT, 84040
(801)544-6526

003136

RECEIVED
OCT 30 03
Weber County Surveyor

003136