

**BOUNDARY LINE AGREEMENT**

BEGINNING AT A POINT ON THE QUARTER SECTION LINE SAID POINT BEING LOCATED NORTH 00°49'38" EAST ALONG THE QUARTER SECTION LINE 823.29 FEET TO A POINT SOUTH 00°49'38" WEST 501.02 FEET FROM THE NORTH LINE OF THE SOUTH HALF OF THE SOUTHWEST QUARTER OF SAID SOUTHWEST CORNER OF THE SOUTHWEST QUARTER OF SECTION 7, TOWNSHIP 7 NORTH, RANGE 1 EAST, SALT LAKE BASE AND MERIDIAN; RUNNING THENCE NORTH TO A POINT SOUTH 00°25' WEST 493.51 FEET TO THE NORTHWEST CORNER OF THE SOUTH 1/2 OF SAID SOUTHWEST QUARTER; THENCE NORTH 85°43' EAST 1058.36 FEET; THENCE NORTH 36°19' WEST 241.42 FEET; THENCE NORTH 38°07' WEST 117.00 FEET; THENCE NORTH 33°30' WEST 172.00 FEET; THENCE NORTH 40 FEET TO THE NORTH LINE OF THE SOUTH 1/2 OF SAID QUARTER SECTION; THENCE NORTH 85°43' EAST ALONG SAID NORTH LINE 413.12 FEET; THENCE SOUTH 36°46' EAST 166 FEET; THENCE SOUTH 53°15' WEST 290.03 FEET; THENCE SOUTH 36°45' EAST 150 FEET; THENCE NORTH 53°15' WEST 300 FEET, MORE OR LESS, TO THE WEST RIGHT OF WAY LINE OF ROAD AS CONVEYED BY QUIT CLAIM DEED RECORDED IN BOOK 951, PAGE 76; THENCE SOUTHEASTERLY ALONG SAID WEST RIGHT OF WAY LINE TO A POINT NORTH 58°06'02" WEST 171.84 FEET AND NORTH 49°52'02" WEST 369.41 FEET FROM THE SOUTH SECTION LINE; THENCE SOUTH 40°07'58" WEST 501.43 FEET TO SAID SECTION LINE; THENCE WESTERLY ALONG SAID SECTION LINE TO THE POINT OF BEGINNING.

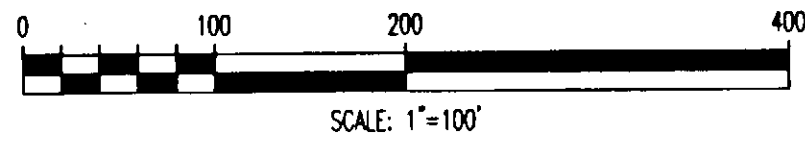
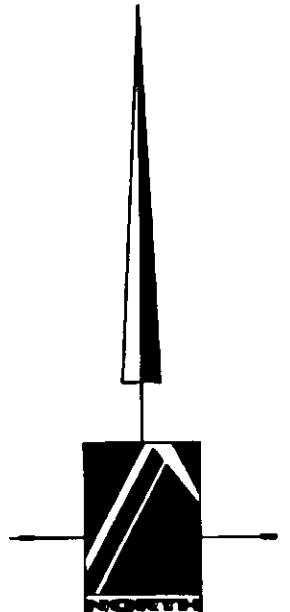

**LEGAL DESCRIPTION 220040026 (DEED)**

PART OF THE SOUTH 1/2 OF THE SOUTHWEST QUARTER OF SECTION 7, TOWNSHIP 7 NORTH, RANGE 1 EAST, SALT LAKE BASE AND MERIDIAN, U.S. SURVEY; BEGINNING AT A THE SOUTHWEST CORNER OF SAID SOUTHWEST QUARTER AND RUNNING THENCE NORTH TO A POINT SOUTH 00°25' WEST 493.51 FEET FROM THE NORTHWEST CORNER OF THE SOUTH 1/2 OF SAID SOUTHWEST QUARTER; THENCE NORTH 85°43' EAST 1058.36 FEET; THENCE NORTH 36°19' WEST 241.42 FEET; THENCE NORTH 38°07' WEST 117.00 FEET; THENCE NORTH 33°30' WEST 172.00 FEET; THENCE NORTH 40 FEET TO THE NORTH LINE OF THE SOUTH 1/2 OF SAID QUARTER SECTION; THENCE NORTH 85°43' EAST ALONG SAID NORTH LINE 413.12 FEET; THENCE SOUTH 36°46' EAST 166 FEET; THENCE SOUTH 53°15' WEST 290.03 FEET; THENCE SOUTH 36°45' EAST 150 FEET; THENCE NORTH 53°15' WEST 300 FEET, MORE OR LESS, TO THE WEST RIGHT OF WAY LINE OF ROAD AS CONVEYED BY QUIT CLAIM DEED RECORDED IN BOOK 951, PAGE 76; THENCE SOUTHEASTERLY ALONG SAID WEST RIGHT OF WAY LINE TO A POINT NORTH 58°06'02" WEST 171.84 FEET AND NORTH 49°52'02" WEST 369.41 FEET FROM THE SOUTH SECTION LINE; THENCE SOUTH 40°07'58" WEST 501.43 FEET TO SAID SECTION LINE; THENCE WESTERLY ALONG SAID SECTION LINE TO THE POINT OF BEGINNING.

CONTAINS - 41.31 ACRES

**LEGAL DESCRIPTION 220040051 (DEED)**

PART OF THE SOUTH HALF OF THE SOUTHWEST QUARTER OF SECTION 7, TOWNSHIP 7 NORTH, RANGE 1 EAST, SALT LAKE BASE AND MERIDIAN, U.S. SURVEY; BEGINNING AT A POINT WHICH IS SOUTH 00°11' EAST 65.06 FEET AND NORTH 58°23' WEST 323.00 FEET AND NORTH 50°09' WEST 438.18 FEET AND NORTH 47°10' WEST 924.45 FEET AND NORTH 36°45' WEST 256.80 FEET AND SOUTH 85°43' WEST 452.23 FEET FROM THE SOUTHWEST CORNER OF SAID SECTION 7, SAID POINT BEING ON THE NORTH LINE OF THE SOUTH HALF OF SAID SOUTHWEST QUARTER SECTION AND ON THE CENTERLINE OF THE LIBERTY IRRIGATION CO. DITCH, RUNNING THENCE SOUTH 85°43' WEST 743.76 FEET ALONG THE QUARTER SECTION LINE TO THE WEST LINE OF SAID SOUTHWEST QUARTER SECTION; THENCE SOUTH 00°25' WEST 493.51 FEET ALONG SAID WEST LINE; THENCE NORTH 85°43' EAST 1058.36 FEET TO THE CENTERLINE OF THE LIBERTY IRRIGATION COMPANY DITCH; THENCE NORTH 36°19' WEST 241.42 FEET ALONG SAID CENTERLINE; THENCE NORTH 38°07' WEST 117.00 FEET ALONG SAID CENTERLINE; THENCE NORTH 33°30' WEST 172.00 FEET ALONG SAID CENTERLINE; THENCE NORTH 40.0 FEET TO THE POINT OF BEGINNING.

CONTAINS - 10.00 ACRES

TOGETHER WITH A RIGHT-OF-WAY FOR PURPOSES OF INGRESS AND EGRESS ALONG AND ACROSS THE EXISTING ROAD, RUNNING FROM THE NORTHEAST CORNER OF THE ABOVE DESCRIBED PROPERTY EASTERLY ALONG THE NORTH LINE OF GRANTORS REMAINING PROPERTY TO GRANTORS NORTHEAST PROPERTY CORNER, AND TO WEBER COUNTY'S RECORDED ROAD RIGHT-OF-WAY.

**LEGEND**

- BOUNDARY LINE
- - - CENTERLINE
- - - OHP OVERHEAD POWER LINE
- - - W EXISTING WATER LINE
- - - OCCUPATION LINE
- - - EXISTING DITCH
- - - EDGE OF ASPHALT
- - - EXISTING FENCE
- - - SECTION LINE
- ◆ CALCULATED SECTION CORNER
- ◆ FOUND SECTION CORNER
- CONTROL POINT
- (E) EXISTING
- CORNER TO BE SET WITH A 5/8" REBAR W/ ORANGE CAP STAMPED "PINNACLE LS 191517"
- - - EXISTING CONTOURS

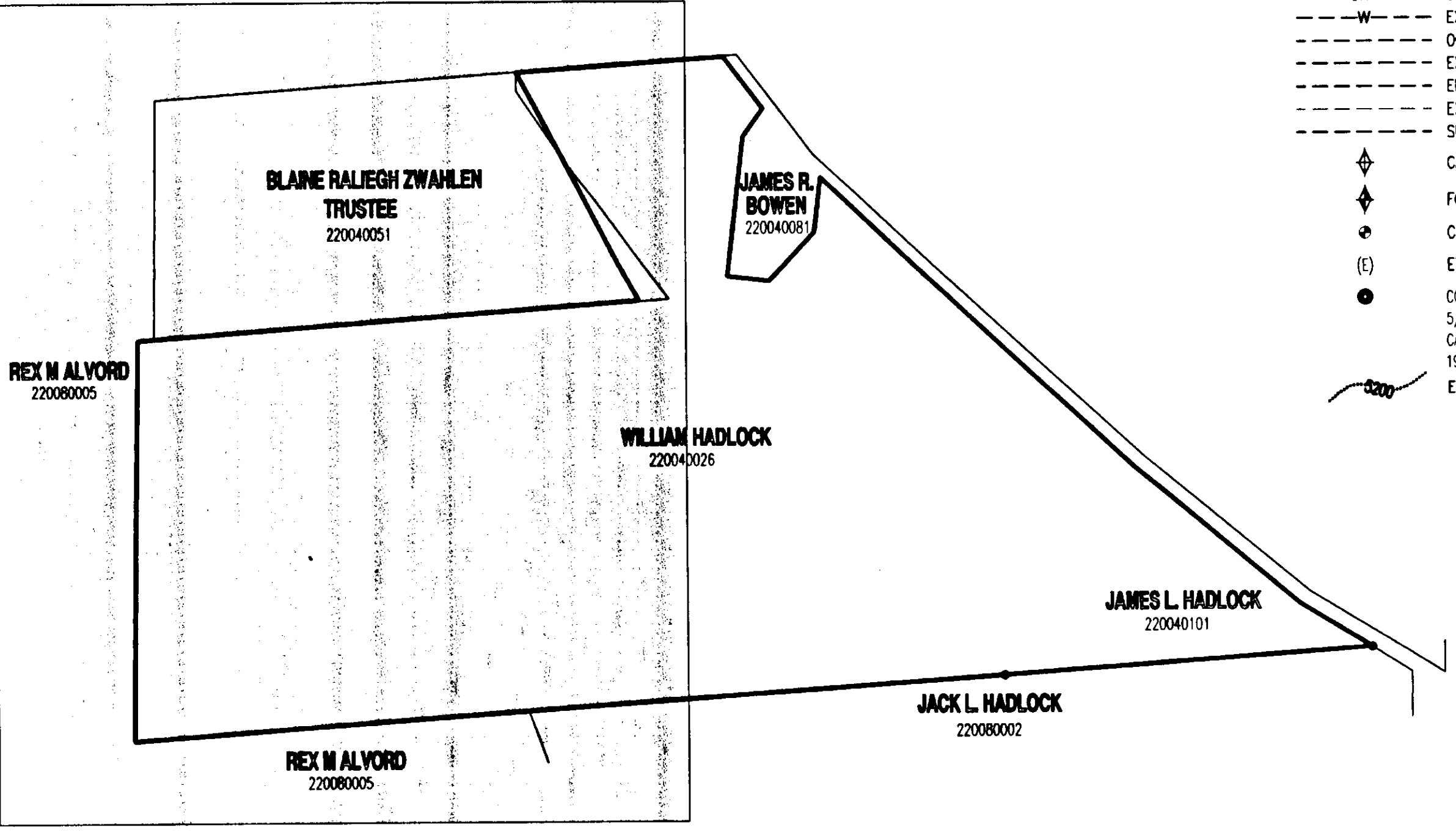

**PINNACLE**  
Engineering & Land Surveying, Inc.  
Phone: (801) 628-7271  
Fax: (801) 544-9651  
1513 North Hillfield Rd., Suite #2  
Layton, UT 84041

**OVERLAND HOMES - EDEN**  
BOUNDARY LINE AGREEMENT  
OVERLAND HOMES  
P.O. BOX 154  
KAYSVILLE, UT 84037  
JOB# 04-036

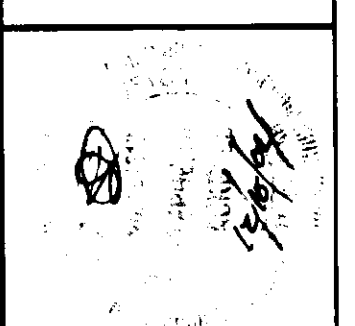

SURVEYED BY	DATE	REVISION	BY DATE	
			DATE	DATE
SJB	4/26/04			
DESIGNED BY	Today			
DRAWN BY	DATE			
RPB	11/2004			
APPROVED BY	DATE			
SJB	11/2004			

RECORDED  
MAR 06 2004  
WEBER COUNTY