

Scale: 1" = 60'

LEGEND:

- PROPERTY LINE
- - - CENTERLINE
- EDGE OF PAVEMENT
- - - DITCH
- x - - - FENCE LINE
- - - - STREET MONUMENT
- - - - SET 5/8" REBAR W/ CAP
- - - - SET 08/28/06

Narrative

The purpose of this survey was to establish and set the property corners of the parcels as shown and described hereon. The survey was ordered by Tom Moore. The control used to establish the property corners was the existing Ogden City Survey Monumentation surrounding Block 27 of Plat "C" Located in the NE Quarter of Section 4, T5N, R1W, S1B2M. The basis of bearing is the Centerline of Van Buren Ave. from the monument at 28th street to the monument at 25th street assumed to bear North 00°58'00" East. The land owners on this block are occupying to the center of the alley which runs north to south through the center of the block, but the deeds for this parcel do not show vacation and/or ownership of the "half alley".

020240037 As Recorded Description

ALL OF LOTS 17, 18, 19 AND 20, COREY'S SUBDIVISION OF THE WEST HALF OF BLOCK 27, PLAT "C", OGDEN CITY SURVEY, WEBER COUNTY, UTAH.

020240035 As Recorded Description

ALL OF LOTS 13 AND 14, COREY'S SUBDIVISION OF THE WEST HALF OF BLOCK 27, PLAT "C", OGDEN CITY SURVEY, WEBER COUNTY, UTAH.

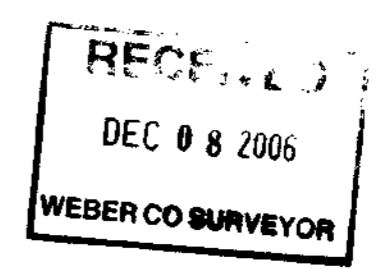

SURVEY CERTIFICATE

I, K. Greg Hansen, do hereby certify that I am a Registered Land Surveyor, and that I hold Certificate No. 167819 as prescribed by the Laws of the State of Utah, and that I have made and/or Supervised the survey of the property shown and described hereon and that this plat is a true and correct representation of said survey to the best of my knowledge and belief.

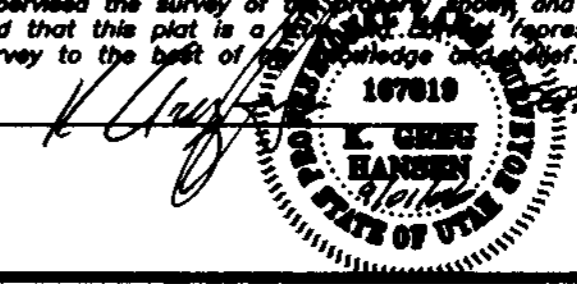

HANSEN & ASSOCIATES, INC.
 Consulting Engineers and Land Surveyors
 538 North Main Brigham City, Utah 84302
 67 East 100 North Logan, Utah 84321
 Brigham City Ogden (435) 752-8197
 (435) 723-3491 (801) 399-4005 (435) 752-8272

PROPERTY SURVEY FOR
Tom Moore
 2544, 2558 & 2564 Van Buren Ave.
 Ogden, Weber County, Utah
 A Part of the Northeast Quarter of
 Section 4, T 5 N., R 1 W., S.L.B.2M.

Drawn By: Kath Date: 07/22/06
 Designed By: _____
 Checked By: _____
 Approved By: _____
 Scale: 1" = 60'
 Drawing File: 06-3-129.dwg
 JOB NUMBER: 06-3-129

SHEET **1** OF **1** SHEETS

003747

003747