

LEGAL DESCRIPTION

A PART OF THE NORTHWEST QUARTER OF SECTION 34, TOWNSHIP 6 NORTH, RANGE 1 WEST, SALT LAKE BASE AND MERIDIAN, UNITED STATES SURVEY; BEGINNING AT A POINT 676.46 FEET N. 89° 02' W. AND 245.09 FEET N. 0° 58' E. FROM THE SOUTHEAST CORNER OF SAID QUARTER SECTION, SAID POINT BEING ON THE EAST LINE OF ROOSEVELT AVENUE (NOW VIRGINIA WAY) 443 FEET (S. 0° 58' W.) S. 0° 57' 24" W. FROM THE SOUTH LINE OF 28TH STREET, AND RUNNING THENCE N. 0° 57' 24" E. (S. 0° 58' E.) 55.00 FEET, THENCE S. 89° 02' 36" E. (S. 89° 02' E.) 121.30 FEET, THENCE S. 0° 57' 24" W. (S. 0° 58' W.) 55.00 FEET, THENCE N. 89° 02' 36" W. (N. 89° 02' W.) 121.30 FEET TO THE PLACE OF BEGINNING

SURVEYOR'S CERTIFICATE

I, CYNTHIA L. ROBINETT DO HEREBY CERTIFY THAT I AM A REGISTERED LAND SURVEYOR, AND THAT I HOLD CERTIFICATE No. 7511 AS PRESCRIBED BY THE LAWS OF THE STATE OF UTAH, AND THAT I HAVE MADE A SURVEY ON THE GROUND, AND FROM RECORDS OF THE WEBER COUNTY RECORDERS OFFICE AND AS DESCRIBED ABOVE AND SHOWN PER THIS PLAT.

3/07/90
DATE

Cynthia L. Robinett
CYNTHIA L. ROBINETT
R.L.S. 7511

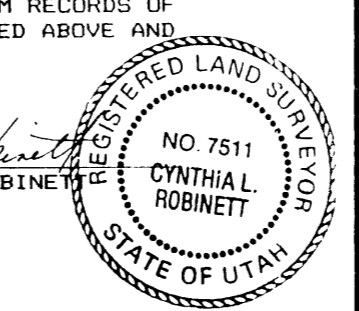

NARRATIVE

THE PURPOSE OF THIS SURVEY WAS TO MARK THE SOUTH BOUNDARY LINE OF KATHRYN JONES PROPERTY LOCATED IN OGDEN AT 2866 VIRGINIA WAY. BASIS OF BEARINGS FOR THIS SURVEY WAS OGDEN CITY MONUMENTS ALONG 28TH STREET (N. 89° 02' W.) BETWEEN POLK AVE. AND TAYLOR AVE. NO PROPERTY CORNERS WERE SET AT THIS TIME. IT WAS FOUND THAT HER GARAGE ENCRDACHED ON HER NEIGHBORS NORTH LINE. NO EVIDENCE WAS FOUND THAT THE O.C.S. MONUMENTS WERE NOT IN THE CORRECT LOCATION.

NOTE:

IT IS POSSIBLE THAT THE PROPERTY ENCRDACHED UPON BY THE GARGAGE ON THE ADJACENT PROPERTY TO THE SOUTH OF KATHRYN JONES MAY HAVE CAUSED AN ACQUISITION OF PROPERTY BY PRESCRIPTION DUE TO THE LENGTH OF TIME PROPERTY HAS BEEN OCCUPIED.

CONSTRUCTION & LAND SURVEYORS INC.	
1500 N. 6900 W. OGDEN, UTAH 84404 (801) 751-1131	
CLIENT:	KATHRYN JONES
SURVEY LOCATION:	N.W. 1/4 SEC. 34, TOWNSHIP 6 NORTH, RANGE 1 WEST, SALT LAKE BASE & MERIDIAN.
SURVEY DATE:	3-7-90
JOB No.	P.S.89-33

RECEIVED
JUL 25 1990
Weber County Surveyor