

- LEGEND**
- ▲ Set Nail & Washer
 - ⊙ Set Rebar & Cap w/ Fencepost
 - Set Hub & Tack
 - ⊕ Monument to be set
 - (Rad.) Radial Line
 - (N/R) Non-Radial Line

NARRATIVE

This survey was requested by Mr. Quinn McKay in order to establish the common line between Lots 2 and 3. Brass Cap monuments were found at the Northwest Corner and the West 1/4 Corner of Section 6, T6N, R2E, SLB&M, U.S. Survey. A line bearing N 0°16'36" E Between those two Monuments was used as the Basis of Bearings. Property Corners were monumented as depicted in this drawing.

BOUNDARY DESCRIPTION

All of Lots 2 and 3 of Middle Fork Ranches, according to the Official Plat thereof, on record in the Weber County Surveyor's Office.

SURVEYOR'S CERTIFICATE

I, Andy Hubbard, do hereby certify that I am a Registered Professional Land Surveyor, and that I hold Certificate No. 6242920, in accordance with Title 58, Chapter 22, of the Professional Engineers and Surveyors Licensing Act, and I have made a survey of the above described property according to Section 17-23-17 and that the above plat correctly shows the true dimensions of the property surveyed.

Date 9-10-2009

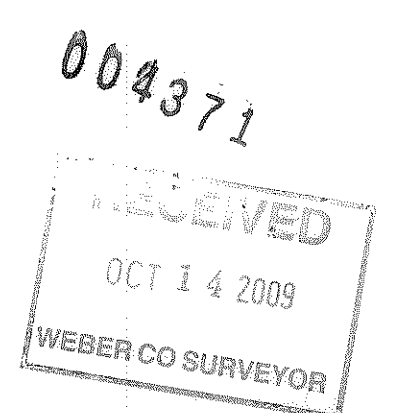
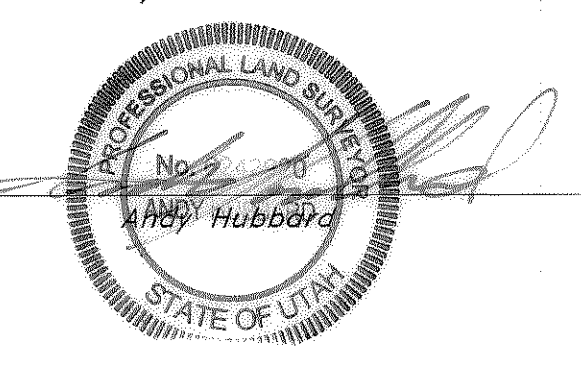

| | | | |
|------------------------|--|---|------------|
| Property Survey | | McKay Middle Fork All of Lots 2 & 3, Middle Fork Ranches, Weber County And a part of Section 6, T6N, R2E, SLB&M, U.S. Survey Weber County, Utah | |
| | SCALE: 1" = 50' | DATE: 2 Sep, 2009 | DRWG. NO. |
| | GREAT BASIN ENGINEERING NORTH CONSULTING ENGINEERS AND SURVEYORS 5746 South 1475 East - Suite 200 Ogden, Utah 84403 P.O. Box 150048, Ogden, Utah 84415 Ogden (801)334-4515 Salt Lake City (801)521-0222 Fax (801)334-7544 | DRAWN: DH | REVISIONS: |
| | | 09N724 | |

