

SIGNED THIS 4th DAY OF December, 2010.

150228-2201
UTAH LICENSE NUMBER

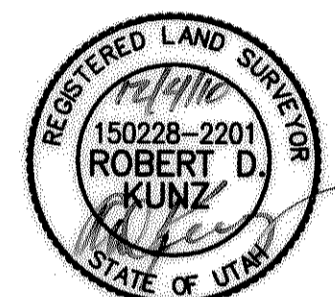

Robert D. Kunz
ROBERT D. KUNZ

SURVEYOR'S CERTIFICATE

I, ROBERT D. KUNZ, DO HEREBY CERTIFY THAT I AM A REGISTERED PROFESSIONAL LAND SURVEYOR IN THE STATE OF UTAH IN ACCORDANCE WITH TITLE 58, CHAPTER 22, PROFESSIONAL ENGINEERS AND LAND SURVEYORS ACT; AND THAT I HAVE COMPLETED A SURVEY OF THE PROPERTY DESCRIBED ON THIS PLAT IN ACCORDANCE WITH SECTION 17-23-17 AND HAVE VERIFIED ALL MEASUREMENTS, AND HAVE PLACED MONUMENTS AS REPRESENTED ON THIS PLAT. I FURTHER CERTIFY THAT THIS PLAT IS A CORRECT REPRESENTATION OF THE LAND SURVEYED AND HAS BEEN PREPARED IN CONFORMITY WITH THE MINIMUM STANDARDS AND REQUIREMENTS OF THE LAW.

REVISIONS	DESCRIPTION
DATE	

RIGHT-OF-WAY MARKER SUMMARY

POINT #	STATION		DESIGN COORDINATES		AS-BUILT COORDINATES	
	STATION	OFFSET	NORTHING	EASTING	NORTHING	EASTING
1250	100+08.93	136.27 RT	3,596,985.307	1,492,113.770	3596985.307	1492113.770
1251	100+89.31	84.56 LT	3,597,151.960	1,492,279.456	3597151.960	1492279.456
1252	101+10.00	55.00 LT	3,597,116.446	1,492,285.825	3597116.446	1492285.825
1253	101+30.00	55.00 RT	3,597,008.218	1,492,257.777	3597008.218	1492257.777
1254	105+86.77	55.00 LT	3,597,022.222	1,492,719.090	3597022.222	1492719.090
1255	105+86.77	55.00 RT	3,596,912.490	1,492,726.763	3596912.492	1492726.764
1256	111+00.00	55.00 LT	3,597,058.023	1,493,231.070	3597058.025	1493231.070
1257	111+00.00	55.00 RT	3,596,948.291	1,493,238.743	3596948.293	1493238.743
1258	113+04.28	85.00 LT	3,597,102.200	1,493,432.762	3597102.201	1493432.740
1259	113+26.00	55.00 RT	3,596,964.056	1,493,464.192	3596964.056	1493464.192
1260	113+50.00	80.00 RT	3,596,940.791	1,493,489.878	3596940.793	1493489.878
1261	117+50.00	111.46 LT	3,597,159.685	1,493,875.548	3597159.689	1493875.548
1262	119+12.42	120.00 RT	3,596,940.121	1,494,053.719	3596940.123	1494053.718
1263	119+96.58	120.00 RT	3,596,945.992	1,494,137.678	3596945.994	1494137.673
1264	120+76.97	87.94 LT	3,597,159.034	1,494,203.359	3597159.035	1494203.362
1265	121+30.03	155.00 LT	3,597,229.631	1,494,251.616	3597229.633	1494251.615
1266	122+14.66	155.00 LT	3,597,235.534	1,494,336.035	3597235.536	1494336.039
1267	124+95.87	146.71 RT	3,596,954.179	1,494,637.611	3596954.177	1494637.610
1268	127+13.82	183.93 LT	3,597,299.217	1,494,831.963	3597299.215	1494831.965
1269	128+03.20	163.15 RT	3,596,959.219	1,494,945.340	3596959.216	1494945.339
1270	128+37.87	165.00 RT	3,596,959.787	1,494,980.054	3596959.789	1494980.053
1271	129+91.00	200.00 LT	3,597,334.580	1,495,107.349	3597334.581	1495107.349
1272	130+32.89	165.00 RT	3,596,973.391	1,495,174.600	3596973.331	1495173.710
1273	130+92.83	106.92 LT	3,597,248.831	1,495,215.423	3597248.831	1495215.424
1274	131+11.34	90.00 LT	3,597,233.242	1,495,235.070	3597233.244	1495235.069
1275	131+32.95	71.70 RT	3,597,073.443	1,495,267.906	3597073.445	1495267.906
1276	132+86.22	165.00 RT	3,596,991.062	1,495,427.312	3596991.064	1495427.311
1277	133+06.36	90.00 LT	3,597,246.846	1,495,429.616	3597246.848	1495429.614
1278	134+35.05	210.00 LT	3,597,375.531	1,495,549.624	3597375.532	1495549.620
1279	135+00.00	155.00 RT	3,597,016.410	1,495,642.087	3597016.410	1495642.087
1280	137+76.72	115.00 RT	3,597,094.937	1,495,924.283	3597094.939	1495924.284
1281	138+45.59	210.00 LT	3,597,426.874	1,495,926.906	3597426.876	1495926.904
1282	141+97.50	210.00 LT	3,597,514.744	1,496,239.610	3597514.745	1496239.608
1283	145+55.10	210.00 LT	3,597,644.167	1,496,543.237	3597644.169	1496543.235
1284	146+26.63	138.00 LT	3,597,611.339	1,496,635.942	3597611.340	1496635.942

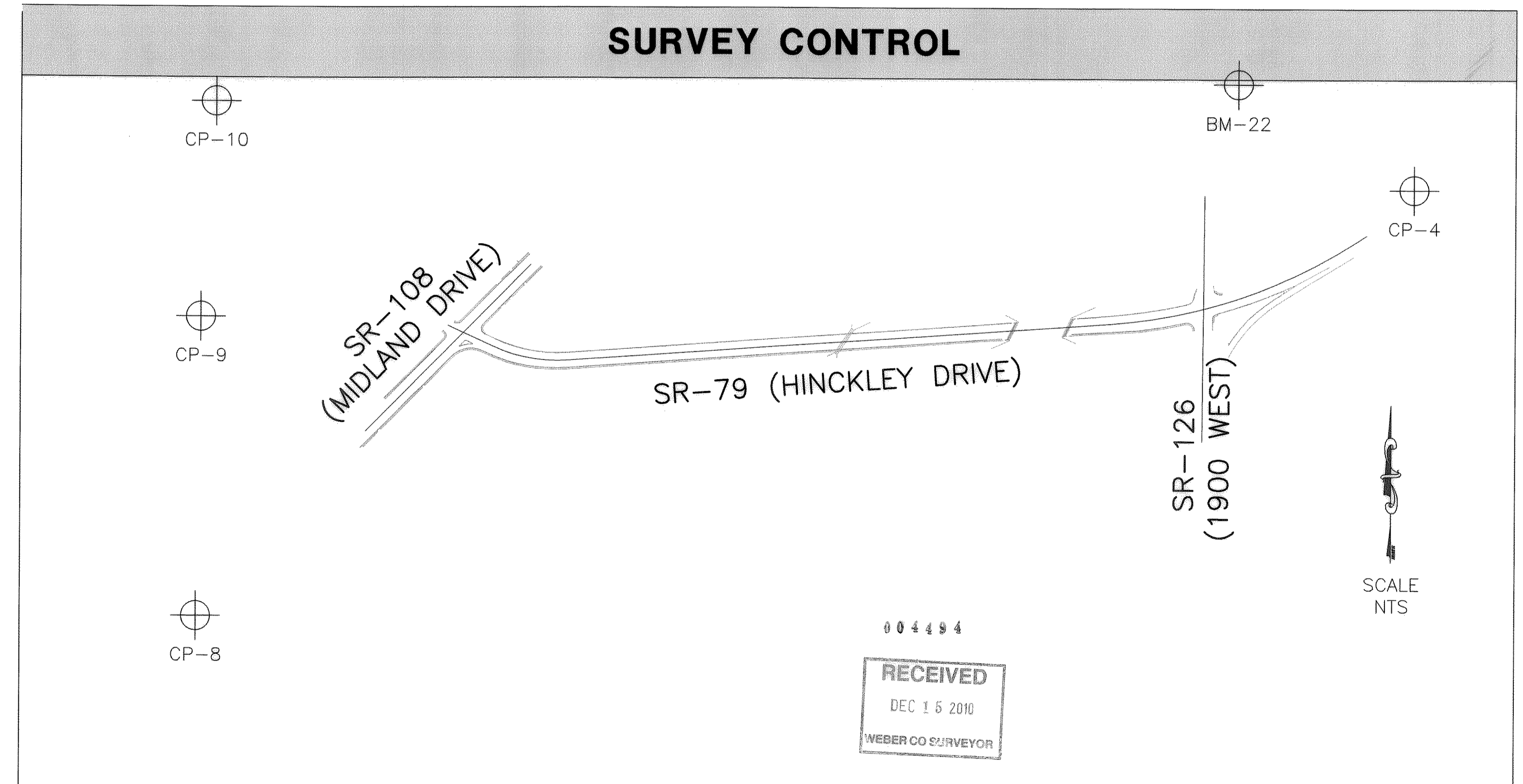

CONTROL POINT	PROJECT NORTHING	PROJECT EASTING	LATITUDE	LONGITUDE	ELEVATION	CONTROL POINT DESCRIPTION
CP-4	3,597,879.889	1,497,200.317	41°11'59.5873"N	112°01'18.4466"W	4431.754	REBAR & CAP HORROCKS ENG.
CP-8	3,595,609.021	1,490,750.562	41°11'36.7651"N	112°02'42.6116"W	4311.053	PK-NAIL
CP-9	3,597,195.531	1,490,773.286	41°11'52.4377"N	112°02'42.4442"W	4297.738	WE. CO. MON. BR. CAP SEC. COR.
CP-10	3,599,840.213	1,490,813.051	41°12'18.5635"N	112°02'42.1411"W	4274.462	WE. CO. MON. BR. CAP SEC. COR.
BM-22	3,599,941.153	1,496,228.954	41°12'19.8903"N	112°01'31.3134"W	4327.240	WE. CO. MON. BR. CAP SEC. COR.

Reeve & Associates, Inc.
4155 S. HARRISON BLVD. SUITE 310, OGDEN, UTAH 84403
TEL: (801) 821-3100 FAX: (801) 821-2888 WWW.REEVE-ASSOC.COM
LAND PLANNERS • CIVIL ENGINEERS • LAND SURVEYORS
TRAFFIC ENGINEERS • STRUCTURAL ENGINEERS • LANDSCAPE ARCHITECTS

RIGHT-OF-WAY MARKERS
WEBER COUNTY, UTAH
SR-79 (HINCKLEY DRIVE)

Project Info.
Surveyor: R. KUNZ
Designer: N. ANDERSON
Begin Date: 10-27-10
Name: HINCKLEY DR. R.O.W. MRKRS. R.O.S.
Scale: 1"=200'
Checked: _____
Number: 5778-01