

25th Street

24th Street

Lincoln Avenue

Wall Avenue

ALLEY

DEPOT

PARCEL A
CONT. 26,440 SQ. FT.
0.607 ACRES

PARCEL B
CONT. 33,603 SQ. FT.
0.776 ACRES

PARCEL C
CONT. 65,406 SQ. FT.
1.302 ACRES

PARCEL D
CONT. 9,940 SQ. FT.
0.228 ACRES

PARCEL E
CONT. 32,634 SQ. FT.
0.749 ACRES

NOTES

1. This survey was done at the request of James W. Stacy to establish the boundaries of the subject property, GORDEN CITY MONUMENTS WERE FOUND AS SHOWN AND USED FOR SURVEY CONTROL. THE CORNER AND BENCHMARKS BETWEEN MONUMENTS AND THE GREAT BRASS CORNER FROM THE LACK OF PROVISION IN THE GREAT BRASS CORNER.

REGISTERED LAND SURVEYOR

1989 REVISIONS - DUPLICATE PROPERTY INTO PARCELS A, B, C, & D AS SHOWN

JAMES W. STACY
A portion of Block 23, Plat 4,
Gorden City Survey, Open Utah

INTERMOUNTAIN SURVEYING
Bld. 318 (1170)
R. E. CLAY, D.D.
JAN 23 1989 41
Water County Surveyor

DATE: APRIL, 1988 **SCALE: 1" = 40'** **PG. 89 - 74**

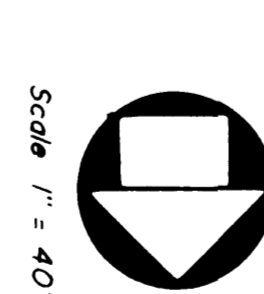

FIRST SECURITY BANK
BURTON WALKER LUMBER PROPERTY

A PART OF LOTS 3, 5, 6, 7, 8, 9, AND 10 BLOCK 23, PLAT A, GORDEN CITY SURVEY, GORDEN CITY, UTAH, BEGINNING AT A POINT WHICH IS NORTH AND RUNNING THENCE SOUTH 0°58'1" WEST 123.60 FT., THENCE SOUTH 89°07'59" EAST 34.14 FT. ALONG AN EXISTING BUILDING WALL TO A BUILDING CORNER, THENCE SOUTH 0°52'02" OF EAST 22.75 THENCE SOUTH 89°07'36" EAST 212.35 FT. ALONG SAID NORTH LINE TO THE NORTH EAST CORNER OF SAID LOT 8, THENCE SOUTH 0°58'1" WEST 325.53 FT. TO A CORNER OF SAID LOT 10, THENCE NORTH 89°04'48" WEST 419.00 FT. TO THE NORTH LINE OF SAID LOT 4, THENCE NORTH 89°04'48" WEST 419.00 FT. TO THE NORTH LINE OF SAID LOT 4, THENCE NORTH 89°06'12" WEST 29.45 FT. ALONG THE NORTH LINE OF SAID LOT 4, THENCE NORTH 0°58'1" EAST 54.50 FT., THENCE NORTH 89°06'12" WEST 115.45 FT. TO A POINT 54.50 FT. SOUTH OF THE POINT OF BEGINNING, THENCE SOUTH 89°09'1" THENCE SOUTH 89°09'1" EAST 3.20 FT. TO A POINT OF CURVE, THENCE EAST 158.82 FT. TO THE POINT OF CURVE, THENCE S 89°09'1" E 158.82 FT. TO THE POINT OF BEGINNING.

CONTAINS 3.62 ACRES

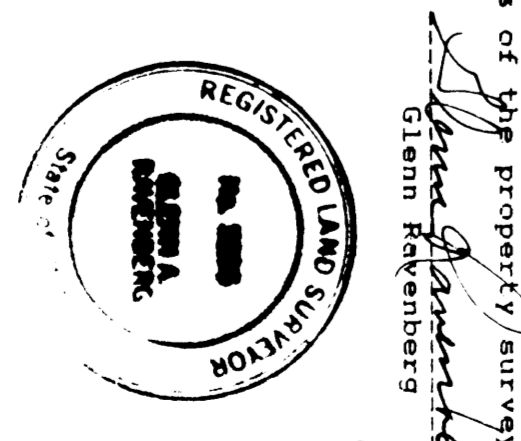

NOTES

1. G.S. - Great Basin Engineering

THIS SURVEY WAS DONE AT THE REQUEST OF JAMES STACY TO ESTABLISH THE BOUNDARIES OF THE SUBJECT PROPERTY, GORDEN CITY MONUMENTS WERE FOUND AS SHOWN AND USED FOR SURVEY CONTROL. THE CORNER AND BENCHMARKS BETWEEN MONUMENTS AND THE GREAT BRASS CORNER FROM THE LACK OF PROVISION IN THE GREAT BRASS CORNER.