

WEST 1/4 COR. SEC. 23
T6N, R2W, SLB&M
WEBER CO. BRASS CAP

N89°21'08"W
658.12'

(N89°21'08"W) (1316.24')

24'

SURVEYOR'S CERTIFICATE

I, DALLAS K. BUTTARS, HOLDING LICENSE NUMBER 167594 IN ACCORDANCE WITH TITLE 58, CHAPTER 22, PROFESSIONAL ENGINEERS AND LAND SURVEYORS LICENSING ACT, HAVE COMPLETED A SURVEY OF THE PROPERTY DESCRIBED ON THE PLAT IN ACCORDANCE WITH SECTION 17-23-17 AND HAVE VERIFIED ALL MEASUREMENTS AND PLACED MONUMENTS AS REPRESENTED ON THE PLAT.

SIGNED THIS 25th DAY OF May 2011.

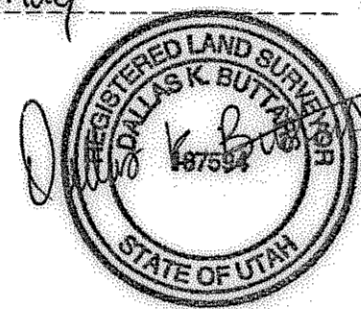

RECORD BOUNDARY DESCRIPTION

PART OF THE SOUTHWEST QUARTER OF SECTION 23, TOWNSHIP 6 NORTH, RANGE 2 WEST, SALT LAKE BASE AND MERIDIAN, U.S. SURVEY; BEGINNING AT THE AT A POINT 264 FEET NORTH OF THE SOUTHEAST CORNER OF SAID NORTHEAST QUARTER OF THE SOUTHWEST QUARTER, RUNNING THENCE NORTH 515 FEET, THENCE WEST 130 FEET, THENCE NORTH 171 FEET, THENCE WEST 530 FEET, THENCE SOUTH 686 FEET, THENCE EAST 660 FEET TO THE PLACE OF BEGINNING, TOGETHER WITH A RIGHT OF WAY 20 FEET WIDE FOR INGRESS AND EGRESS, THE CENTER LINE OF WHICH BEGINS AT A POINT 80 FEET WEST OF THE SOUTHEAST CORNER OF SAID SOUTHWEST QUARTER OF SECTION 23, AND RUNS NORTH 428 FEET, THENCE NORTH 45° EAST 98 FEET, MORE OR LESS TO A POINT 10 FEET WEST OF THE EAST LINE OF SAID SOUTHWEST QUARTER, THENCE NORTH PARALLEL TO SAID EAST LINE 1093 FEET, MORE OR LESS, TO A POINT 16 RODS NORTH OF THE SOUTHEAST CORNER OF THE NORTHEAST QUARTER OF SAID SOUTHWEST QUARTER OF SECTION 23. CONTAINS 9.9 ACRES

NARRATIVE

THIS SURVEY WAS PERFORMED AT THE REQUEST OF WEST HAVEN CITY. THE SECTION LINES HAVE BEEN REBUILT USING OLD FENCELINE EVIDENCE AND DEED RESEARCH OF THE AREA. A SURVEY PERFORMED ON THE WEST BOUNDARY OF THIS PARCEL WAS MADE ONE YEAR EARLIER FOR WENDELL PETERSON. THE SOUTH BOUNDARY WAS HELD TO THE PEPPERIDGE ESTATES SUBDIVISION BOUNDARY. THE EAST BOUNDARY WAS DETERMINED FROM THE SECTION REBUILD BREAK DOWN. THE BASIS OF BEARING IS AS SHOWN BETWEEN THE SECTION CORNERS AND IS USING THE STATE PLANE GRID BEARING SYSTEM AS PER WEBER COUNTY RECORDS IN 2010.

15-061-0041

15-061-0042

15-061-0034
9.89 ACRES

15-061-0043

SCALE: 1" = 60'

○ = 5/8"Ø x 24" LENGTH REBAR WITH CAP STAMPED 167594



N00°41'28"E 2636.69' (BASIS OF BEARING)
(1318.35')

(1318.35')

(1318.35')

SW COR. SEC. 23
T6N, R2W, SLB&M
WEBER CO. BRASS CAP

N89°16'49"W 2637.73'

EXIST. FENCE (TYP)

GATE

ACCESS ROAD

(WEST 530.0')
S89°20'03"E
528.30'

(NORTH 171.0')
S00°34'38"W
171.00'

(WEST 130.0')
S89°20'03"E
130.00'

ACCESS ROAD

CENTERLINE
20' R.O.W.

N45°00'00"E
100.00'

P.O.B.
N0°34'38"E 1584.0'
FROM SOUTH 1/4 COR.
SEC.23, T6N, R2W

(EAST 660.0')
N89°44'30"W
658.66'

PEPPER RIDGE ESTATES
SUBDIVISION

S00°34'38"W
428.00'

N89°16'49"W
80.00'

S00°34'38"W
1084.32'

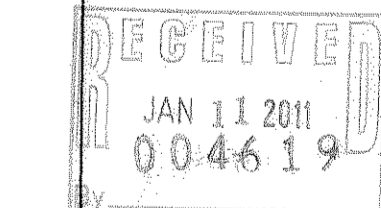

SOUTH 1/4 COR.
SEC. 23
T6N, R2W, SLB&M
WEBER CO. BRASS
CAP

REVISIONS	
1.) _____	5.) _____
2.) _____	6.) _____
3.) _____	7.) _____
4.) _____	8.) _____

DRAWN BY: D.B.	DATE: 05-16-11
CHECKED BY: D.B.	SCALE: AS SHOWN
JOB NO. 3160	

LANDMARK SURVEYING, INC.
A COMPLETE LANDSURVEYING SERVICE
4646 S. 3500 W. #A-3, WEST HAVEN, UTAH 84401
PHONE 801-731-4075 FAX 801-731-8506

RECORD OF SURVEY
15-061-0042
WEST HAVEN CITY

LOCATED IN
A PART OF THE NW 1/4 & SW 1/4 OF SECTION 23,
T.6N., R.2W., S.L.B.&M.
WEBER COUNTY, UTAH

SHEET
1
SHEETS
1