

SURVEYOR'S CERTIFICATE:

I, DARREN R. WILLIAMS, DO HEREBY CERTIFY THAT I AM A PROFESSIONAL LAND SURVEYOR, AND THAT I HOLD CERTIFICATE NO. 4975981 AS PRESCRIBED BY THE LAWS OF THE STATE OF UTAH. I FURTHER CERTIFY THAT BY AUTHORITY OF THE OWNERS, I HAVE MADE A SURVEY OF THE TRACT OF LAND SHOWN ON THIS MAP AND THAT SAME HAS BEEN CORRECTLY SURVEYED AND STAKED ON THE GROUND AS SHOWN.

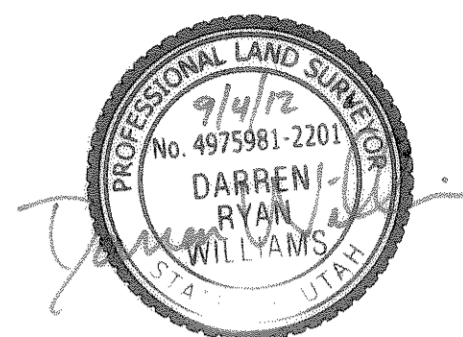

DATE: 9/4/12
DARREN R. WILLIAMS LICENSE # 4975981

BOUNDARY DESCRIPTION:

A PARCEL OF LAND LOCATED IN THE SOUTHWEST QUARTER OF SECTION 23, TOWNSHIP 6 NORTH, RANGE 1 EAST, SALT LAKE BASE AND MERIDIAN, MORE PARTICULARLY DESCRIBED AS FOLLOWS:

BEGINNING AT A POINT ON THE NORTHWEST CORNER OF BRANCH SUBDIVISION WHICH IS 1680.00 FEET NORTH 89°35'27" WEST, 107.04 FEET NORTH 00°48'08" EAST, 375.33 FEET NORTH 75°07'12" WEST, 360.00 FEET SOUTH 77°48'08" WEST, 847.02 FEET SOUTH 85°48'08" WEST, AND 552.92 FEET SOUTH 54°13'13" WEST FROM THE EAST QUARTER CORNER OF SAID SECTION 23. THENCE SOUTH 33°48'08" WEST 799.99 FEET TO THE NORTHERLY LINE OF BERG WEISS SUBDIVISION; THENCE ALONG SAID NORTHERLY LINE OF BERG WEISS SUBDIVISION NORTH 81°43'41" EAST 775.98 FEET TO THE WESTERLY LINE OF SNOW BASIN ROAD; THENCE ALONG SAID WESTERLY LINE OF SNOW BASIN ROAD TWO (2) COURSES DESCRIBED AS FOLLOWS: NORTH 01°03'13" EAST 96.00 FEET TO A POINT OF CURVATURE AND NORTHEASTERLY ALONG THE ARC OF A 172.46 FOOT RADIUS CURVE TO THE RIGHT A DISTANCE 125.66 FEET (CENTRAL ANGLE EQUALS 41°44'57" AND LONG CHORD BEARS NORTH 21°55'42" EAST 122.90 FEET) TO THE WESTERLY LINE OF BRANCH SUBDIVISION; THENCE ALONG SAID WESTERLY LINE OF BRANCH SUBDIVISION NORTH 47°11'52" WEST 504.99 FEET TO THE POINT OF BEGINNING.

THE ABOVE DESCRIBED PARCEL OF LAND CONTAINS 274,439 SQUARE FEET OR 6.300 ACRES

NARRATIVE:

THIS SURVEY WAS CONDUCTED AT THE REQUEST OF GADDIS INVESTMENTS FOR THE PURPOSE OF LOCATING PROPERTY LINES PRIOR TO SITE EXCAVATION. REBAR AND CAPS SET BY GREAT BASIN ENGINEERING FOR THE BERG WEISS SUBDIVISION WERE FOUND BUT DID NOT MATCH THE RECORD LOCATION SHOWN ON THE SUBDIVISION PLAT. THE DIFFERENCES ARE SHOWN ON THIS PLAT.

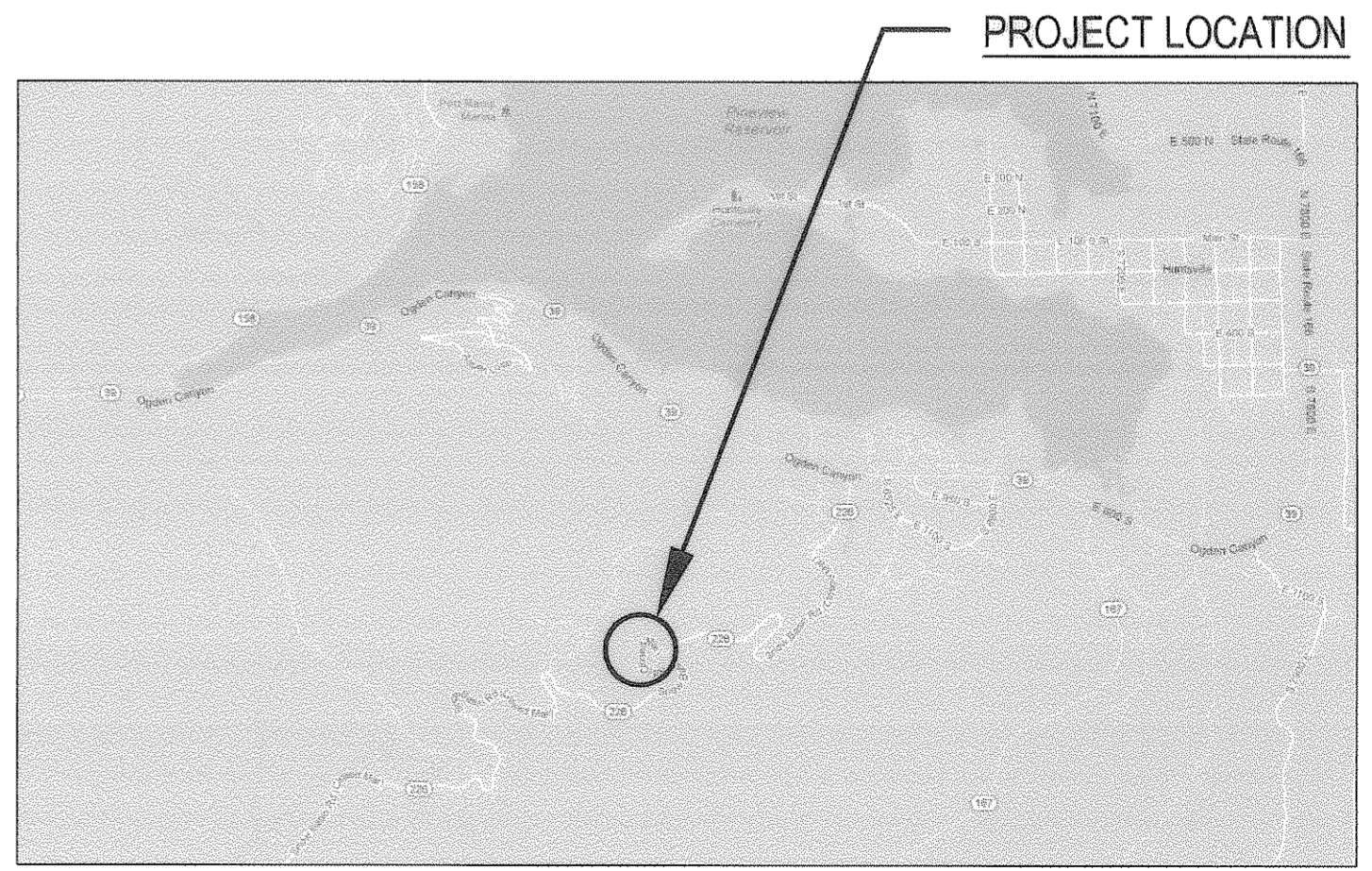

LEGEND:

- SECTION CORNER
- SET REBAR & CAP
- FOUND REBAR & CAP
- PROPERTY OF REFERENCE
- ADJACENT LOT LINES
- SECTION LINE
- TIE LINE
- CENTERLINE
- ASPHALT



S00°48'08"W 2629.65' (MONUMENT TO MONUMENT)

SOUTHEAST QUARTER CORNER OF SECTION 23, T6N, R1E, SLB&M (FOUND BRASS CAP)

FILE PATH AND NAME: P:\2012\120866_Gaddis_Investm_Snowbasin_Road_Lot_Survey\Drawings\Record of Survey.dwg
PLOT DATE AND TIME: 9/4/2012 11:46 AM
TAB: 24x36 DWF

<p>RECORD OF REVISIONS</p>	<p>IF THE ABOVE SCALE BAR DOES NOT MEASURE 1 INCH IN LENGTH, DO NOT USE THIS DRAWING FOR SCALING PURPOSES. DIMENSIONS AND MEASUREMENTS SPECIFIED IN THE DRAWING TAKE PRECEDENCE TO SCALED MEASUREMENTS.</p> <p>THE INFORMATION CONTAINED IN THIS DRAWING IS THE PROPERTY OF CRS ENGINEERS AND IS NOT TO BE REPRODUCED, MODIFIED OR USED FOR ANY OTHER PROJECT OR EXTENSION OF THIS PROJECT EXCEPT BY AGREEMENT WITH CRS ENGINEERS.</p> <p>© 2012</p>	<p>PRINCIPAL: PAUL J. HIRST</p> <p>PROJECT MANAGER: DARREN WILLIAMS</p> <p>CHECKED BY: DARREN WILLIAMS</p> <p>DRAWN BY: TRAVIS WILLIAMS</p> <p>DRAWING SCALE: 1" = 80'</p> <p>ISSUE DATE: SEPTEMBER 4, 2012</p>	<p>CALDWELL RICHARDS SORENSEN ANSWERS TO INFRASTRUCTURE</p>
----------------------------	--	---	--

SALT LAKE CITY OFFICE:
2060 EAST 2100 SOUTH
SALT LAKE CITY, UTAH 84109
PHONE: 801.359.5565
FAX: 801.359.4272
www.crsengineers.com

GADDIS INVESTMENTS
RECORD OF SURVEY
LOCATED IN THE SOUTHWEST QUARTER OF SECTION 23,
TOWNSHIP 6 NORTH, RANGE 1 EAST,
SALT LAKE BASE & MERIDIAN

5850 SNOW BASIN ROAD HUNTSVILLE, UTAH

120866	
1	1
SHEET NUMBER	
V-1.0	