

**BOUNDARY SURVEY FOR
JAMES MAUL
6088 NORTH 2250 EAST
PART OF THE SOUTHEAST QUARTER OF SECTION 1,
TOWNSHIP TOWNSHIP 7 NORTH, RANGE 1 WEST,
SALT LAKE BASE AND MERIDIAN
WEBER COUNTY, UTAH**

**PARCEL A
BOUNDARY DESCRIPTION**
ALL OF LOT 12 COBBLECREEK PARK SUBDIVISION PHASE 1

SCALE	1"=40'
DATE	4/16/13
DESIGN	-----
DRAWN	KHW
CHECKED	KHW

NARRATIVE:

THE PURPOSE OF THE SURVEY WAS TO RESURVEY THE BOUNDARY OF LOT 12 COBBLECREEK SUBDIVISION PHASE 1 AS SHOWN AND DESCRIBED HEREON. THE SURVEY WAS ORDERED BY JAMES MAUL. THE CONTROL USED TO ESTABLISH THE BOUNDARY WAS THE EXISTING WEBER COUNTY SURVEY MONUMENTATION AS SHOWN AND NOTED HEREON AND THE EXISTING ORIGINAL SUBDIVISION MONUMENTATION. THE BASIS OF BEARING IS THE EAST LINE OF THE SOUTHEAST QUARTER OF SECTION 1, TOWNSHIP 7 NORTH, RANGE 1 WEST, OF THE SALT LAKE BASE AND MERIDIAN WHICH BEARS SOUTH 0°00'00" WEST RECORD BEARING FROM THE DEDICATED PLAT OF SAID COBBLECREEK PARK SUBDIVISION PHASE 1.



L=24.84, R=375.82
D=3°47'15\"/>

EAST QUARTER CORNER SEC. 1,
T7N, R1W, S.L.B.&M. (FOUND REBAR
AT BASE OF FENCE POST)

243.04'
S00°00'00\"/>

SOUTHEAST CORNER SEC. 1,
T1N, R1W, S.L.B.&M. (FOUND
BRASS CAP MONUMENT 1981
GOOD CONDITION)

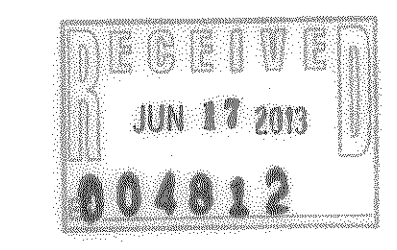

SURVEYOR'S CERTIFICATE

I, KLINT H. WHITNEY, DO HEREBY CERTIFY THAT I AM A LICENSED PROFESSIONAL LAND SURVEYOR IN THE STATE OF UTAH AND THAT I HOLD CERTIFICATE NO. 8227228 IN ACCORDANCE WITH TITLE 53, CHAPTER 22, OF THE PROFESSIONAL ENGINEERS AND LAND SURVEYORS ACT; I FURTHER CERTIFY THAT BY AUTHORITY OF THE OWNERS I HAVE COMPLETED A SURVEY OF THE PROPERTY DESCRIBED ON THIS RECORD OF SURVEY PLAT IN ACCORDANCE WITH SECTION 17-23-17 AND HAVE VERIFIED ALL MEASUREMENTS; THAT THE REFERENCE MONUMENTS SHOWN ON THIS RECORD OF SURVEY PLAT ARE LOCATED AS INDICATED AND ARE SUFFICIENT TO RETRACE OR REESTABLISH THIS SURVEY; AND THAT THE INFORMATION SHOWN HEREIN IS SUFFICIENT TO ACCURATELY ESTABLISH THE LATERAL BOUNDARIES OF THE HEREIN DESCRIBED TRACT OF REAL PROPERTY.

SIGNED THIS 28th DAY OF May, 2013.

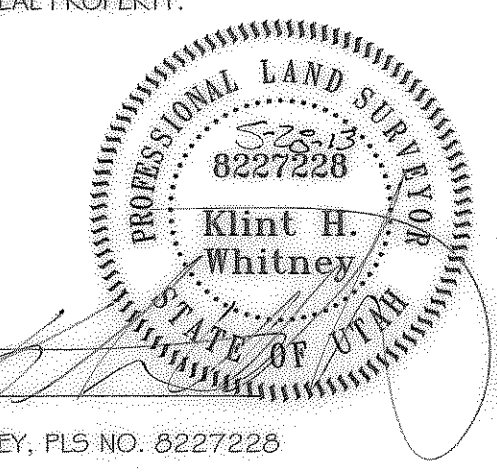

KLINT H. WHITNEY, PLS NO. 8227228

- WEBER COUNTY MONUMENT AS NOTED
- SET 24\"/> REBAR AND CAP MARKED GARDNER ENGINEERING
- PROPERTY LINE
- ADJACENT PARCEL
- SECTION LINE
- EXISTING IRON PIPE FENCE
- EXISTING FENCE

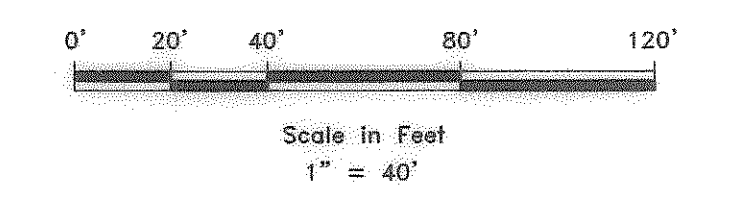
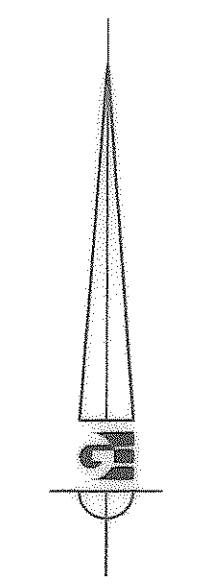

**PROPERTY SURVEY FOR JAMES MAUL
6088 NORTH 2250 EAST
LOCATED IN THE SOUTHWEST QUARTER OF SECTION 1,
TOWNSHIP 7 NORTH, RANGE 1 WEST, S.L.B. AND M.**

GARDNER ENGINEERING
CIVIL - LAND PLANNING
MUNICIPAL - LAND SURVEYING

S1

1