

CALL BLUESTAKES @ 1-800-862-4111 AT LEAST 48 HOURS PRIOR TO THE COMMENCEMENT OF ANY CONSTRUCTION.



LAYTON
1485 West Hillfield Rd.
Suite 204
Layton UT 84041
Phone: 801.547.1100
Fax: 801.593.6315

SALT LAKE CITY
Phone: 801.255.0529

TOOELE
Phone: 435.843.3590

CEDAR CITY
Phone: 435.865.1453

RICHFIELD
Phone: 435.590.0187

WWW.ENSIGNUTAH.COM

FOR:
ROLAYNE COLLINS
970 MAPLE STREET
OGDEN, UTAH 84403

CONTACT:
ROLAYNE COLLINS
PHONE: 801-864-1138
FAX:

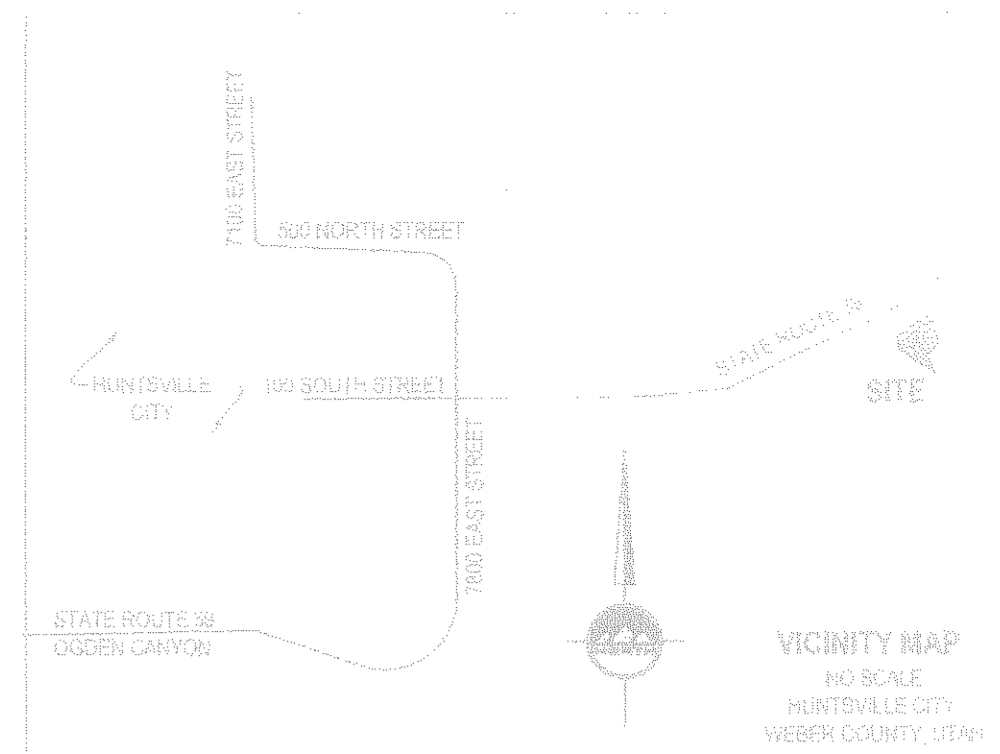

SURVEYOR'S CERTIFICATE

I, Keith R. Russell, do hereby represent that I am a Professional Land Surveyor and that I hold Certificate no. 164386 as prescribed by the laws of the State of Utah and I have made a survey of the following described property. The purpose of this survey is to show the boundary of the parcel and the improvements that determine the boundary as well as the improvements within the parcel. Great Basin Engineering had completed a survey of property that surrounds this parcel of the north, west and south, which survey I have honored and used to establish the boundary lines of this parcel. Information from the Great Basin Engineering survey, where applicable has been noted hereon. The fence line on the north side of the property, and the rock along the southwesterly side of the property is referenced in the description of the neighboring property by the Great Basin Survey. I have honored those calls and physical monuments.

The Basis of Bearing is from found Weber County Section Corner Survey Monuments at the Southwest and Northwest Corners of Section 12, Township 6 North, Range 2 East, Salt Lake Base and Meridian. The section breakdown into aliquot parts was taken from the Great Basin Engineering survey referenced herein.

Deed Description
Heritage Lodge, LLC and Lowell Collins
Tax ID no. 21-016-0001

Part of the Southwest Quarter of the Southwest Quarter of Section 12, Township 6 North, Range 2 East, Salt Lake Base and Meridian, U.S. Survey;
Beginning at a point that is 68.2 feet West and 346 feet South from the Center of the Southwest Quarter of said Section 12, and running:
Thence South 78° West 10 feet;
Thence South 14° West 31.5 feet to a rock wall;
Thence South 49°30' East along said rock wall 152 feet more or less to the northwesterly bank of South Fork River;
Thence in a northerly direction along the said bank of South Fork River to a point that is North 78° East 74 feet from the point of beginning;
Thence South 78° West 74 feet, to the point of beginning.

Together with a right-of-way along the Old Highway, the center line of which said right-of-way described as follows:
Beginning at a point that is 68.2 feet West and 346 feet South from the Center of the Southwest Quarter of said Section 12, and running;
Thence North 14°27' West 230 feet, more or less, to the State Road.

Excepting therefrom the above described piece or parcel of land that portion thereof lying within the boundaries of the Southwest Quarter of the Southwest Quarter of Section 12, Township 6 North, Range 2 East, Salt Lake Base and Meridian, U.S. Survey.

Surveyed Boundary Description

Part of the Southwest Quarter of the Southwest Quarter of Section 12, Township 6 North, Range 2 East, Salt Lake Base and Meridian, U.S. Survey;
Beginning at the intersection of a fence line extension and the west bank of the South Fork of the Ogden River, said point being South 0°03'31" West 328.62 feet along the sixteenth line (331.71 feet on Great Basin Survey) to the extension of a fence line and South 79°14'59" West 21.05 feet (South 78°40'36" West on Great Basin Survey) from the Center of the Southwest Quarter of said Section 12, and running:
Thence South 79°14'59" West 86.55 feet to and along a fence line to a fence corner;
Thence South 35°07'31" East 52.33 feet along the northeasterly side of a rock wall to an angle point in said wall;
Thence South 48°08'23" East 33.15 feet along the northeasterly side of a rock wall to an angle point in said wall;
Thence South 61°48'59" East 17.54 feet along the northeasterly side of a rock wall to an angle point in said wall;
Thence South 77°12'17" East 14.90 feet along the northeasterly side of a rock wall to an angle point in said wall;
Thence South 53°48'55" East 48.73 feet along the northeasterly side of a rock wall, through an existing shed and beyond the end of the rock wall to the sixteenth line;
Thence North 0°03'31" East 20.32 feet along the sixteenth line to the west top bank of the South Fork of the Ogden River;
Thence North 18°34'20" West 18.93 feet along the west top bank to an angle point in said bank of the South Fork of the Ogden River;
Thence North 12°59'02" East 27.73 feet along the west top bank of the South Fork of the Ogden River to the sixteenth line;
Thence North 0°03'31" East 41.29 feet along the sixteenth line to the west top bank of the South Fork of the Ogden River;
Thence North 28°46'16" West 24.12 feet along the west top bank to an angle point in the said bank of the South Fork of the Ogden River;
Thence North 18°11'30" West 28.89 feet along the west top bank of the South Fork of the Ogden River to the point of beginning.

Contains 12,060 square feet, 0.277 acres.

Date: October 18, 2013
Keith R. Russell
License no. 164386

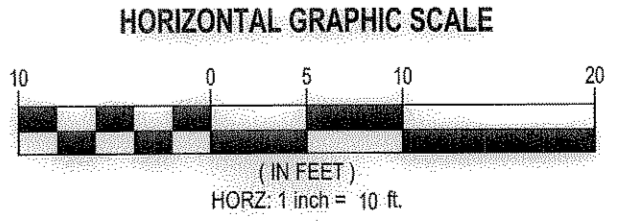
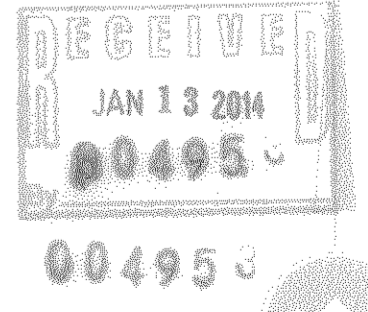

LOCATED IN THE SOUTH WEST QUARTER OF SECTION 12 TOWNSHIP 6 NORTH, RANGE 2 EAST SALT LAKE BASE AND MERIDIAN

HERITAGE LODGE SURVEY
11351 EAST HIGHWAY 39
HUNTSVILLE, UTAH 84317

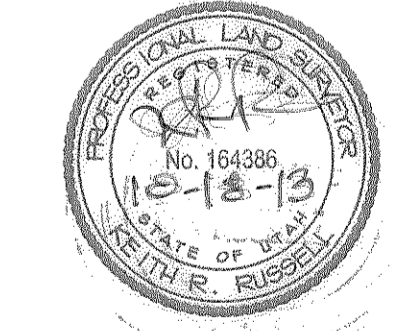

NO.	DATE	REVISION	BY
1		FOR REVIEW	
2			
3			
4			
5			
6			
7			

BOUNDARY SURVEY

PROJECT NUMBER: L2126
DATE: 1/10/14
DRAWN BY: A. SHELBY
CHECKED BY: K. RUSSELL
PROJECT MANAGER: K. RUSSELL

