

SURVEYOR'S CERTIFICATE

I, **JERRY FLETCHER**, DO HEREBY CERTIFY THAT I AM A REGISTERED PROFESSIONAL LAND SURVEYOR IN THE STATE OF UTAH IN ACCORDANCE WITH TITLE 58, CHAPTER 22, PROFESSIONAL ENGINEERS AND LAND SURVEYORS' ACT; AND THAT I HAVE SUPERVISED A SURVEY OF THE PARCEL DESCRIBED ON THIS PLAT IN ACCORDANCE WITH SECTION 17-23-17 AND HAVE VERIFIED ALL MEASUREMENTS AS REPRESENTED ON THIS PLAT. I FURTHER CERTIFY THAT THIS PLAT IS A CORRECT REPRESENTATION OF THE LAND SURVEYED AND HAS BEEN PREPARED IN CONFORMITY WITH THE MINIMUM STANDARDS AND REQUIREMENTS OF THE LAW.

SIGNED THIS 24th DAY OF December, 2013.

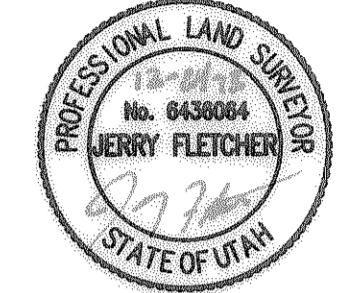

6436064
UTAH LICENSE NUMBER

JERRY FLETCHER

BASIS OF BEARINGS

THE BASIS OF BEARINGS FOR THIS PLAT IS THE SECTION LINE BETWEEN THE SOUTHEAST CORNER AND THE EAST QUARTER CORNER OF SECTION 18, TOWNSHIP 5 NORTH, RANGE 2 WEST, SALT LAKE BASE AND MERIDIAN BEING NORTH AS SHOWN ON THIS PLAT.

NARRATIVE

THE PURPOSE OF THIS PLAT IS TO LOCATE AND MARK ON THE GROUND WEBER COUNTY PARCEL NO. 09-078-0015 AS SHOWN ON THIS PLAT.

PARCEL DESCRIPTION

PARCEL 09-078-0015 (ENTRY NO. 2272572)
PART OF THE SOUTHEAST QUARTER OF SECTION 18, TOWNSHIP 5 NORTH, RANGE 2 WEST, SALT LAKE MERIDIAN, U.S. SURVEY, BEGINNING AT A POINT ON THE WEST LINE OF THE COUNTY ROAD 13.01 CHAINS (858.66 FEET) NORTH AND 33 FEET WEST FROM THE SOUTHEAST CORNER OF SAID QUARTER SECTION; RUNNING THENCE NORTH ALONG SAID WEST LINE 210.89 FEET TO AN EXISTING FENCELINE; THENCE NORTH 89D 45' WEST 231.7 FEET ALONG SAID FENCELINE; THENCE SOUTH PARALLEL TO THE WEST LINE OF SAID COUNTY ROAD 210.89 FEET TO A POINT NORTH 89D 45' WEST FROM THE POINT OF BEGINNING; THENCE SOUTH 89D 45' EAST 231.7 FEET TO THE POINT OF BEGINNING. (OVERLAPS PROPERTY ON THE NORTH 55.89 FEET).

LEGEND

- ◆ = SECTION CORNER
- = SET 5/8" REBAR AND PLASTIC CAP STAMPED "REEVE & ASSOCIATES"

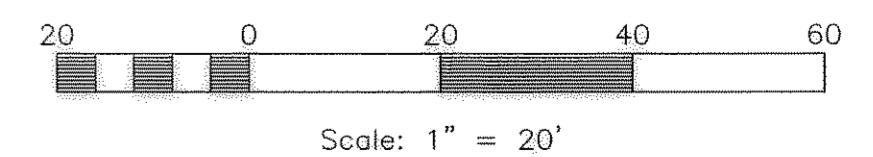
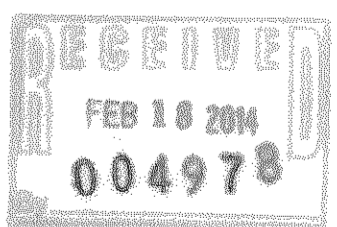

Reeve & Associates, Inc.
 830 CHIMBRES STREET SUITE 100
 P.O. BOX 1601 621-2606 reeve@ra-inc.com
 TEL: (801) 621-2606
 SURVEYORS • ENGINEERS • ARCHITECTS

| REVISIONS | DESCRIPTION |
|-----------|-------------|
| | |
| | |
| | |
| | |
| | |
| | |
| | |
| | |
| | |

RECORD OF SURVEY
 PART OF THE SOUTHEAST QUARTER OF SECTION 18, T.5N., R.2W., S.L.B.&M., U.S. SURVEY
 5110 WEST 5500 SOUTH, HOOPER, WEBER COUNTY, UTAH

BONNIE SAVOIE

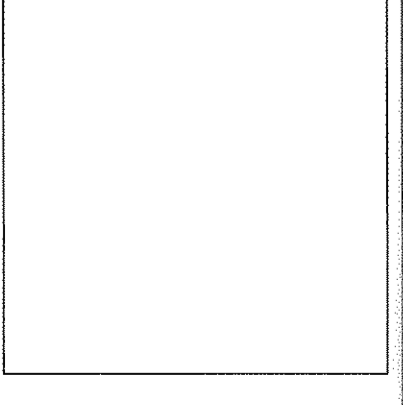

Project Info.

Surveyor: J. FLETCHER

Designer:

Date: 12-24-13

Name: BONNIE SAVOIE

Scale: 1"=20'

Checked:

Number: 6278-01