

EAMES SUBDIVISION

A PART OF THE S.E. 1/4 OF SECTION 7, T.5N., R1W., S.L.B. and M.

RIVERDALE CITY, WEBER COUNTY, UTAH

JUNE 2014
RECORD OF SURVEY

SURVEYOR'S CERTIFICATE

I, DALLAS K. BUTTARS, HOLDING PROFESSIONAL LAND SURVEYOR LICENSE #167594, IN ACCORDANCE WITH TITLE 58, CHAPTER 22 OF THE PROFESSIONAL ENGINEERS AND LAND SURVEYORS LICENSING ACT, HAVE COMPLETED A SURVEY OF THE PROPERTY DESCRIBED ON THE PLAT IN ACCORDANCE WITH SECTION 17-23-17 AND HAS VERIFIED ALL MEASUREMENTS AND PLACED MONUMENTS AS REPRESENTED ON THE PLAT.

SIGNED THIS _____ DAY OF _____ 20__

R.L.S. # 167594 *Dallas K. Buttars*
6-30-14

OWNER'S DEDICATION

~~WE, THE UNDERSIGNED OWNERS OF THE HEREIN DESCRIBED TRACT OF LAND, DO HEREBY SET APART AND SUBDIVIDE THE SAME INTO LOTS AS SHOWN ON THE PLAT AND NAME SAID TRACT EAMES SUBDIVISION AND GRANT AND DEDICATE A PERPETUAL RIGHT AND EASEMENT OVER, UPON AND UNDER THE LANDS DESIGNATED ON THE PLAT AS PUBLIC UTILITY EASEMENTS FOR THE INSTALLATION, MAINTENANCE AND OPERATION OF PUBLIC UTILITY SERVICE LINES WITH NO BUILDINGS OR STRUCTURES BEING ERRECTED WITHIN SUCH EASEMENTS.~~

~~SIGNED THIS _____ DAY OF _____ 20__~~

ACKNOWLEDGMENT

~~STATE OF UTAH)
COUNTY OF WEBER) ss
ON THIS _____ DAY OF _____ 20__ PERSONALLY APPEARED
BEFORE ME, THE UNDERSIGNED NOTARY PUBLIC, THE SIGNERS OF THE ABOVE
OWNER'S DEDICATION IN NUMBER, WHO DULY ACKNOWLEDGED TO
ME THAT THEY SIGNED IT FREELY AND VOLUNTARILY AND FOR THE PURPOSES
THEREIN MENTIONED.~~

BOUNDARY DESCRIPTION

~~A PART OF THE SOUTHEAST QUARTER OF SECTION 7, TOWNSHIP 5 NORTH, RANGE 2 WEST, SALT LAKE BASE AND MERIDIAN, U.S. SURVEY; BEGINNING AT THE SOUTHEAST CORNER OF LOT 6, GLENN COVE P.R.U.D. PHASE NO 1 AMENDED, AS RECORDED IN THE WEBER COUNTY RECORDERS OFFICE; RUNNING THENCE SOUTH 0°02'40" WEST 90.11 FEET TO THE NORTH RIGHT OF WAY LINE OF 4400 SOUTH STREET THENCE ALONG SAID RIGHT OF WAY LINE NORTH 86°22'27" WEST 109.96 FEET, THENCE NORTH 0°02'40" EAST 90.11 FEET TO THE SOUTH LINE EXTENDED OF SAID GLENN COVE P.R.U.D., THENCE ALONG SAID SOUTH LINE SOUTH 86°22'27" EAST 109.96 FEET TO THE POINT OF BEGINNING.
CONTAINS 9,884 S.F., 0.227 ACRES~~

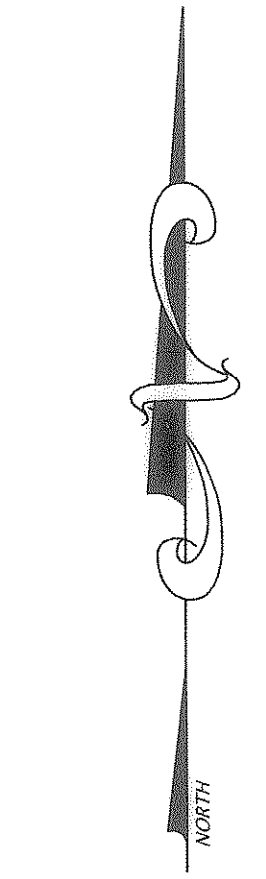
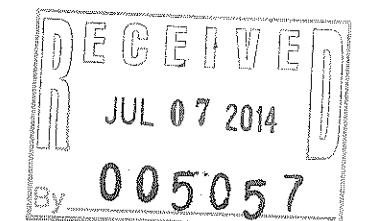

SCALE: 1" = 30'

- = 5/8"Ø x 24" LENGTH REBAR WITH CAP STAMPED 167594
- ⊕ = CITY MONUMENT
- ⊕ = SECTION CORNER
- EXISTING FENCE
- EXISTING FIRE HYDRANT
- EXISTING POWER POLE

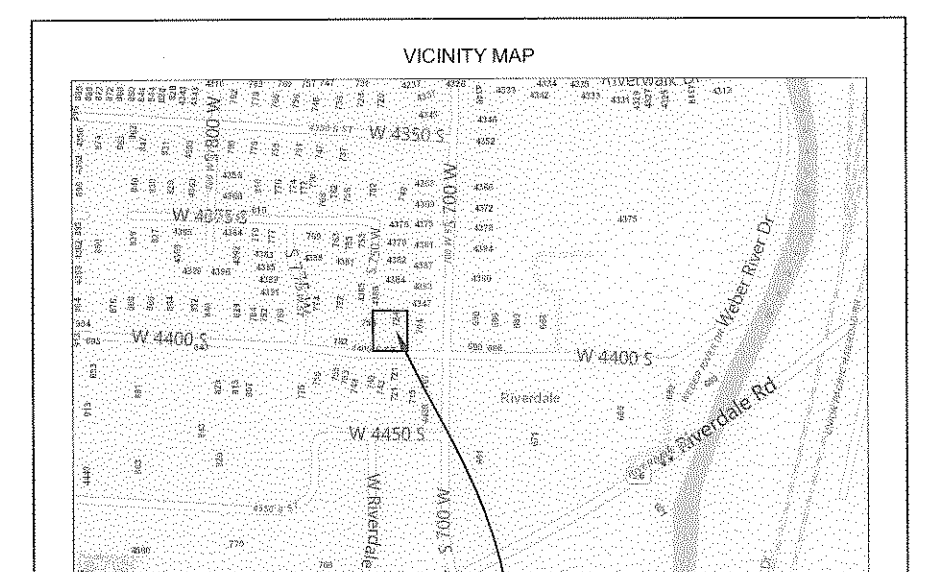

Project Location

FOUND RIVERDALE CITY BRASS CAP MONUMENT

FOUND RIVERDALE CITY BRASS CAP MONUMENT

RIVERDALE CITY ATTORNEY

~~I HEREBY CERTIFY THAT THE REQUIREMENTS OF ALL APPLICABLE STATUTES AND ORDINANCES PREREQUISITE TO APPROVAL BY THE ATTORNEY OF THE FOREGOING PLAT DEDICATIONS HAVE BEEN COMPLIED WITH.
DATED THIS _____ DAY OF _____ 20__
signature~~

RIVERDALE CITY APPROVAL

~~THIS IS TO CERTIFY THAT THIS SUBDIVISION PLAT AND THE DEDICATION OFFERED HEREIN ARE APPROVED AND ACCEPTED BY THE CITY COUNCIL OF RIVERDALE CITY, WEBER COUNTY, UTAH THIS _____ DAY OF _____ 20__
MAYOR, RIVERDALE CITY
ATTEST: _____
Rivdale City Recorder~~

RIVERDALE CITY ENGINEER

~~I HEREBY CERTIFY THAT I HAVE CAREFULLY INVESTIGATED THE LINE OF SURVEY OF THE FOREGOING PLAT AND LEGAL DESCRIPTION OF THE LAND ENCOMPASSED THEREIN AND FIND THEM TO BE CORRECT AND AGREE WITH LINES AND MONUMENTS OF RECORD IN THIS OFFICE.
SIGNED THIS _____ DAY OF _____ 20__
Rivdale City Engineer~~

RIVERDALE CITY PLANNING COMMISSION APPROVAL

~~THIS IS TO CERTIFY THAT THIS SUBDIVISION PLAT WAS DULY APPROVED BY THE RIVERDALE CITY PLANNING COMMISSION ON THE _____ DAY OF _____ 20__
CHAIRMAN, RIVERDALE PLANNING COMMISSION~~

 LANDMARK SURVEYING A COMPLETE SURVEYING SERVICE 4646 S 3500 W SUITE 3, WEST HAVEN, UT 84401 PH. 801-731-4075	WEBER COUNTY RECORDER ENTRY # _____ FEE _____ FILED FOR RECORD & RECORDED THIS _____ DAY OF _____ 20__ AT _____ IN BOOK _____ OF _____ PAGE _____ WEBER COUNTY RECORDER BY _____ DEPUTY
	CLIENT: Aaron Eames LOCATION: PART OF THE S.E. 1/4 OF SEC. 7, T.5N., R.1W., S.L.B.&M. SURVEYED: 2013
	REVISIONS: _____ DRAWN BY: TK CHECKED BY: DB DATE: 6-5-2014 FILE: 3358

Developer:
Aaron Eames
AJE Investments, LLC
801-622-0752