

**PARCEL A
BOUNDARY DESCRIPTION**

ALL OF LOT 1, THE WEST 69 FEET OF LOT 2, AND THE EAST 2 FEET OF THE NORTH 17 FEET OF LOT 2 REEVES ADDITION, OGDEN CITY, WEBER COUNTY, UTAH.

NARRATIVE:

THE PURPOSE OF THIS SURVEY WAS TO ESTABLISH AND SET THE PROPERTY CORNERS OF THE PARCEL AS SHOWN AND DESCRIBED HEREON. THE SURVEY WAS ORDERED BY STEVE BOYLE. THE BASIS OF BEARING IS A LINE BETWEEN THE CENTERLINE INTERSECTION MONUMENTS AT 22ND STREET AND WALL AVENUE AND 22ND STREET AND PINGREE AVENUE WHICH BEARS NORTH 89°02'00" WEST OGDEN CITY RECORD BEARING.

SURVEYOR'S CERTIFICATE

I, KLINT H. WHITNEY, DO HEREBY CERTIFY THAT I AM A LICENSED PROFESSIONAL LAND SURVEYOR IN THE STATE OF UTAH AND THAT I HOLD CERTIFICATE NO. 8227228 IN ACCORDANCE WITH TITLE 56, CHAPTER 22, OF THE PROFESSIONAL ENGINEERS AND LAND SURVEYORS ACT; I FURTHER CERTIFY THAT BY AUTHORITY OF THE OWNERS I HAVE COMPLETED A SURVEY OF THE PROPERTY DESCRIBED ON THIS RECORD OF SURVEY PLAT IN ACCORDANCE WITH SECTION 17-23-17 AND HAVE VERIFIED ALL MEASUREMENTS; THAT THE REFERENCE MONUMENTS SHOWN ON THIS RECORD OF SURVEY PLAT ARE LOCATED AS INDICATED AND ARE SUFFICIENT TO RETRACE OR REESTABLISH THIS SURVEY; AND THAT THE INFORMATION SHOWN HEREIN IS SUFFICIENT TO ACCURATELY ESTABLISH THE LATERAL BOUNDARIES OF THE HEREIN DESCRIBED TRACT OF REAL PROPERTY.

SIGNED THIS 19TH DAY OF MARCH, 2014.

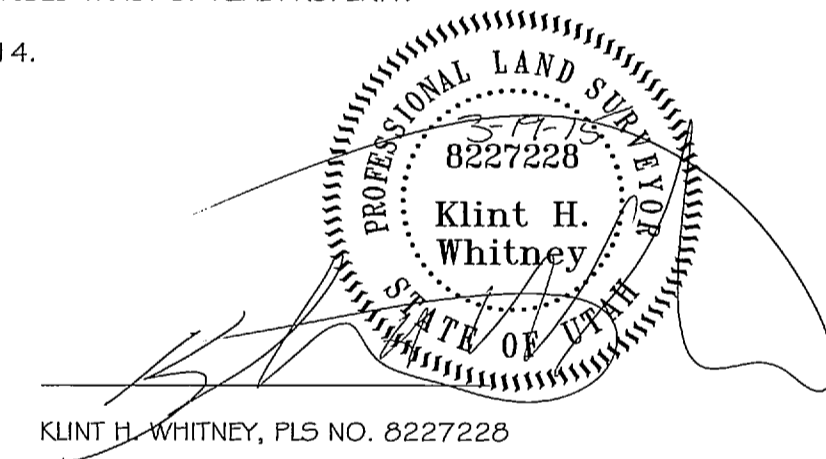

KLINT H. WHITNEY, PLS NO. 8227228

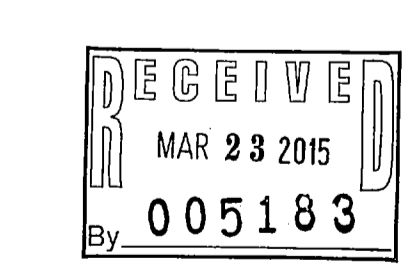
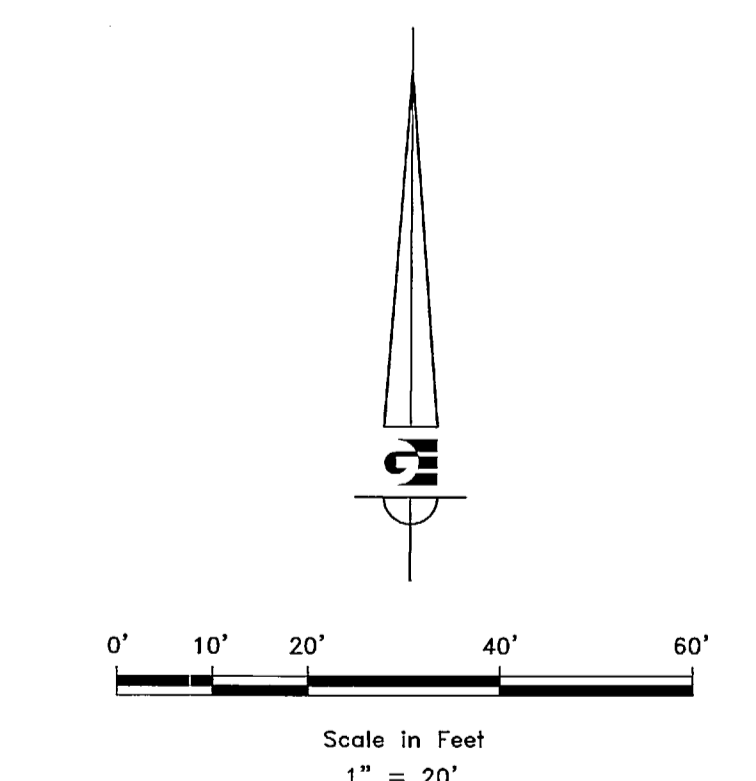

- OGDEN CITY CENTERLINE MONUMENT
- SET 24" REBAR AND CAP MARKED GARDNER ENGINEERING
- PROPERTY LINE
- ADJACENT PARCEL
- CENTERLINE OF RIGHT-OF-WAY
- ORIGINAL LOT LINE
- EXISTING FENCE

REVISIONS	DATE	DESCRIPTION

SCALE	1"=20'
DATE	4/16/13
DESIGN	
DRAWN	KHW
CHECKED	KHW

PROPERTY SURVEY FOR ZIONS BANK
REEVES ADDITION, OGDEN CITY, WEBER COUNTY, UTAH
LOCATED IN THE NORTHWEST QUARTER OF SECTION 29,
TOWNSHIP 6 NORTH, RANGE 1 WEST, S.L.B. AND M.

GARDNER ENGINEERING
CIVIL - LAND PLANNING
MUNICIPAL - LAND SURVEYING

51
1

DWG. 13A2288 - BOYLE APPLIANCE SURVEY (OWNERS RECORD OF SURVEY) BOYLE BOUNDARY.DWG