

North 1/4 of Section 14 T5N, R1W, SLB&M U.S. Survey (Calculated)

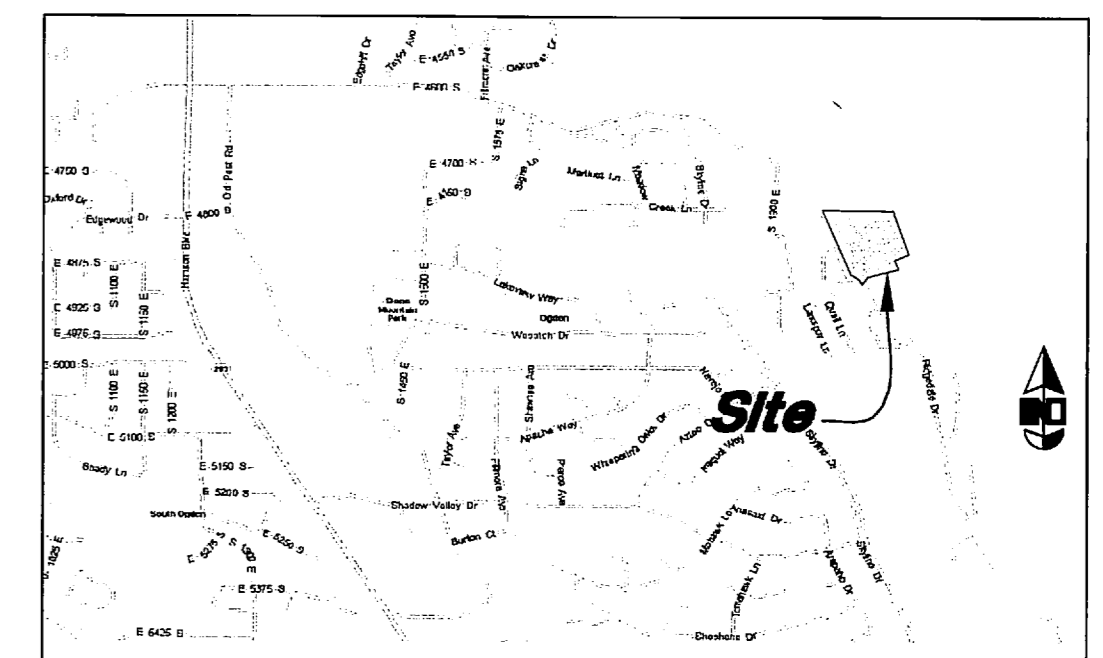

VICINITY MAP
Not to Scale

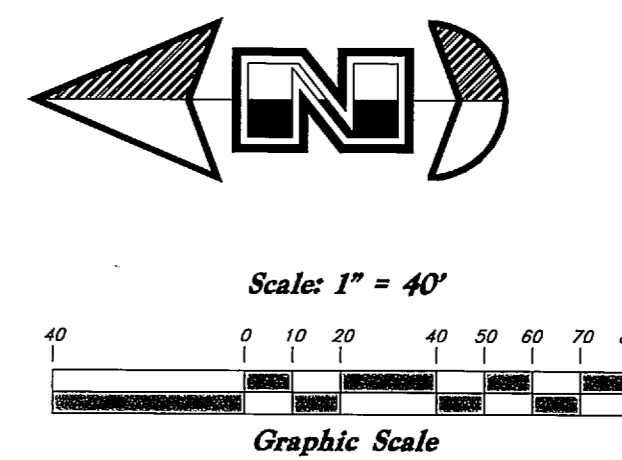

LEGEND

- | | | | |
|-------|-------------------------|--------|--------------------------|
| -C- | Centerline | TA | Top of Asphalt |
| -UGT- | Buried Telephone line | EA | Edge of Asphalt |
| -OHT- | Overhead Telephone line | NG | Natural Ground |
| -OHP- | Overhead Power line | LG | Lip of Gutter |
| -UP- | Underground Power line | SP | Service Pole |
| -S- | Sanitary Sewer line | LP | Light Pole |
| -W- | Culinary Water line | PP | Power Pole |
| -G- | Gas line | TP | Telephone Pole |
| -SD- | Storm Drain line | FH | Fire Hydrant |
| -DW- | Secondary Waterline | DIT | Flowline of Ditch |
| -LD- | Land Drain line | TOE | Top of Slope |
| -IW- | Irrigation Waterline | TOP | Top of Slope |
| -X-X- | Fence | CO | Cleanout |
| ⊕ | Power Pole | FU | Fence |
| ⊕ | DMH | DMH | Drain Manhole |
| ⊕ | Water Meter | FW | Flowline |
| ⊕ | Gas Meter | CE | Contour |
| ⊕ | Telephone Box | x99.00 | Spot Elevation |
| ⊕ | Sewer Manhole | ASPH | Asphalt |
| ⊕ | Drain Manhole | CONC | Concrete |
| ⊕ | Water Manhole | BUILD | Building |
| ⊕ | Cleanout Box | CATCH | Catch Basin |
| ⊕ | SW | C.M.P. | Corrugated Metal Pipe |
| ⊕ | GAS | R.C.P. | Reinforced Concrete Pipe |
| ⊕ | GUY | CONC | Edge of Concrete |
| ⊕ | BLDG | RWALL | Retaining Wall |
| ⊕ | Building Corner | SMH | Sewer Manhole |
| ⊕ | Natural Ground | WV | Water Valve |
| ⊕ | Edge of Concrete | WP | Water Valve |
| ⊕ | Retaining Wall | CB | Catch Basin |
| ⊕ | Sewer Manhole | DV | Diversion Box |
| ⊕ | Water Valve | TC | Top of Curb |
| ⊕ | Light Pole | | |
| ⊕ | Power Pole w/guy | | |
| ⊕ | Deciduous Tree | | |
| ⊕ | Coniferous Tree | | |

BOUNDARY DESCRIPTION

A part of the Northwest Corner of Section 14, Township 5 North, Range 1 West, Salt Lake Base and Meridian, U.S. Survey, South Ogden City, Weber County, Utah

Beginning at the Northwest Section Corner of Section 14, Township 5 North, Range 1 West, South Ogden City, Weber County, Utah being 534.48 feet South 89°31'05" East from the Northwest Corner of said Section 14, and running thence South 89°31'05" East 2100 feet along the North line of Knollwood Condominiums Phase IV and Knollwood Condominiums Phase V, Ogden City, Weber County Utah; Four (4) courses along the Easterly and Southerly line of said Knollwood Condominiums Phase V as follows (1) South 20°30'00" East 402.00 feet; (2) South 65°39'55" West 134.00 feet; (3) South 24°20'05" East 81.59 feet and (4) South 75°38'45" West 274.57 feet; to a point on the Southerly line of said Knollwood Condominiums Phase IV, thence South 37°04'21" West 84.48 feet to a point on the Northeastery line of Ridgedale Drive and to a point of curvature; thence Northwesterly along said Northeastery line of Ridgedale Drive and the arc of a 216.60 foot Radius curve to the left a distance of 130.79 feet (Delta Angle equals 34°35'48", Center bears South 56°33'53" West, and Long Chord bears North 50°43'59" West 128.81 feet); to the Westerly line of said Knollwood Condominiums Phase IV, thence North 24°20'05" West 620.38 feet along said Westerly Line to the point of beginning.

Contains: 7.193 acres

NARRATIVE

This Property and Topographic Survey was requested by Mr. Ron Martinez for the purpose of establishing the boundaries and prepare the property for development.
A Brass Cap Monument was found at the Northwest corner of Section 14, T5N, R1W, SLB&M U.S. Survey and several Rebar and Cap were found at several corners of the subject property.
Basis of Bearings for this survey is South 66°51'23" East along a line between said Northwest corner of Section 14, and a Rebar and Cap set by Gardner Engineering at a point on the West boundary of subject property as shown hereon.
Property corners were set as indicated.

SURVEYOR'S CERTIFICATE

I, Andy Hubbard do hereby certify that I am a Professional Land Surveyor, and that I hold Certificate No. 6242920, in accordance with Title 58, Chapter 22, of the Professional Engineers and Surveyors Licensing Act, and I have made a survey of the above described property according to Section 17-23-17 and that the above plat correctly shows the true dimensions of the property surveyed.

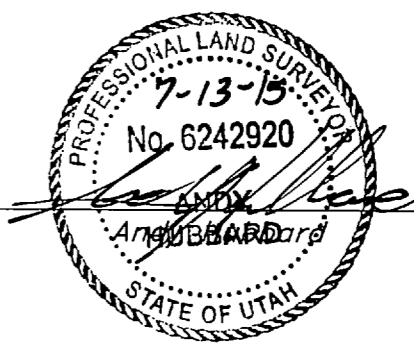
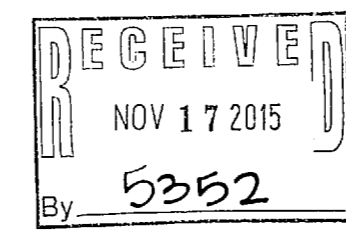

2721.53' Rec. W.C.S.

West 1/4 of Section 14 T5N, R1W, SLB&M U.S. Survey (Record)

Drager, Anne C.

Stephen G. and Susan E. Denkers Trustees

Knollwood Condominium Phase V

Knollwood Condominium Phase IV

Knollwood Condominium Phase 1

Knollwood Condominium Phase 1

United States of America

(Found Rebar and Cap)

Point of Beginning (Found Rebar and Cap)

Northwest Corner of Section 14 T5N, R1W, SLB&M U.S. Survey (Found Brass Cap)

GREAT BASIN ENGINEERING
5746 SOUTH 1475 EAST OGDEN, UTAH 84403
MAIN (801)594-4515 S.L.C (801)521-0222 FAX (801)392-7544
WWW.GREATBASINENGINEERING.COM

Martinez - Landmasters Property
Topographic Survey
A part of Section 14, T5N, R1W, SLB&M, U.S. Survey

13 July, 2015

SHEET NO. 1

15N815