

**NARRATIVE**

This Survey was requested by Mr. Lyle Waters of Waters Construction for the purpose of depicting the current conditions of this property.

A line between Center line monuments located in Anasazi Drive and the Intersection of Anasazi Drive and Arapaho Drive with a bearing of North 77°44'31" East was used as the Basis of Bearings for this Survey.

Property corners were set as depicted on this survey.

**BOUNDARY DESCRIPTION**

All of Lot 214, Shadow Valley Estates No. 18, Ogden City, Weber County, Utah.

**SURVEYOR'S CERTIFICATE**

I, Andy Hubbard do hereby certify that I am a Professional Land Surveyor, and that I hold Certificate No. 6242920, in accordance with Title 58, Chapter 22, of the Professional Engineers and Surveyors Licensing Act, and I have made a survey of the above described property according to Section 17-23-17 and that the above plat correctly shows the true dimensions of the property surveyed.

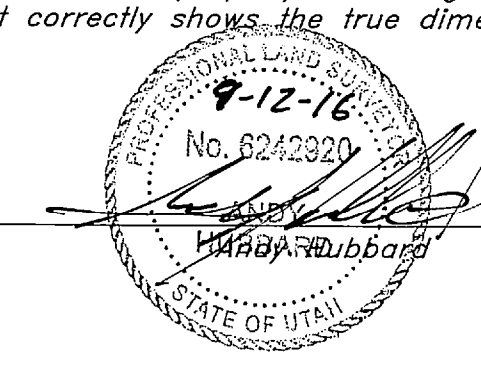

**Legend**

- (Note: All items may not appear on drawing)
- San. Sewer Manhole
  - Water Manhole
  - Storm Drain Manhole
  - Cleanout
  - Electrical Manhole
  - Catch Basins
  - Exist. Fire Hydrant
  - Fire Hydrant
  - Fire Department Connection
  - Post Indicator Valve
  - Exist. Water Valve
  - Water Valve
  - Sanitary Sewer
  - Culinary Water
  - Gas Line
  - Irrigation Line
  - Storm Drain
  - Telephone Line
  - Secondary Waterline
  - Power Line
  - Fire Line
  - Land Drain
  - Power pole
  - Power pole w/guy
  - Light Pole
  - Fence
  - Flowline of ditch
  - Overhead Power line
  - Corrugated Metal Pipe
  - Concrete Pipe
  - Reinforced Concrete Pipe
  - Ductile Iron
  - Polyvinyl Chloride
  - Top of Asphalt
  - Edge of Asphalt
  - Centerline
  - Flowline
  - Finish Floor
  - Top of Curb
  - Top of Wall
  - Top of Walk
  - Top of Concrete
  - Natural Ground
  - Finish Grade
  - Match Existing
  - Fire Department Connection
  - Finish Contour
  - Exist. Contour
  - Finish Grade
  - Exist. Grade
  - Ridge Line
  - Direction of Flow
  - Existing Asphalt
  - Existing Concrete
  - Tree

|   |                                       |
|---|---------------------------------------|
| <b>GREAT BASIN ENGINEERING</b>  |                                       |
| 5746 SOUTH 1475 EAST OGDEN, UTAH 84403<br>MAIN (801)394-4515 S.L.C (801)521-0222 FAX (801)392-7544<br>WWW.GREATBASINENGINEERING.COM |                                       |
| <b>Record of Survey</b>   | <b>Shadow Valley No. 18 - Lot 214</b> |
| A part of Section 15, T5N, R1W, S18&M, U.S. Survey  |                                       |
| <b>21 Mar, 2016</b>   |                                       |
| SHEET NO. <b>1</b>  |                                       |
| RECEIVED<br>OCT 13 2016<br>BY: 5581   |                                       |