

**PARCEL 080320007
BOUNDARY DESCRIPTION**

A PART OF THE SOUTHEAST QUARTER OF SECTION 3, TOWNSHIP 5 NORTH, RANGE 2 WEST, OF THE SALT LAKE BASE AND MERIDIAN, MORE PARTICULARLY DESCRIBED AS FOLLOWS: BEGINNING AT A POINT ON THE EAST LINE OF SAID SOUTHEAST QUARTER BEING LOCATED SOUTH 0°51'36" WEST 355.05 FEET ALONG SAID EAST LINE FROM THE EAST QUARTER CORNER OF SAID SECTION; RUNNING THENCE ALONG SAID EAST LINE SOUTH 0°51'36" WEST 85.00 FEET; THENCE NORTH 89°01'33" WEST 544.62 FEET TO THE EAST LINE OF THE CLAY'S RANCHETTES SUBDIVISION; THENCE ALONG SAID LINE NORTH 1°14'01" EAST 85.00 FEET; THENCE SOUTH 89°01'33" EAST 544.07 FEET TO THE POINT OF BEGINNING. CONTAINING 46,270 SQ. FT. 1.062 ACRES, MORE OR LESS.

**PARCEL 080330004
BOUNDARY DESCRIPTION**

ALL OF LOT 4, CLAY'S RANCHETTES, WEST HAVEN CITY, WEBER COUNTY, UTAH. ACCORDING TO THE OFFICIAL PLAT THERE OF.

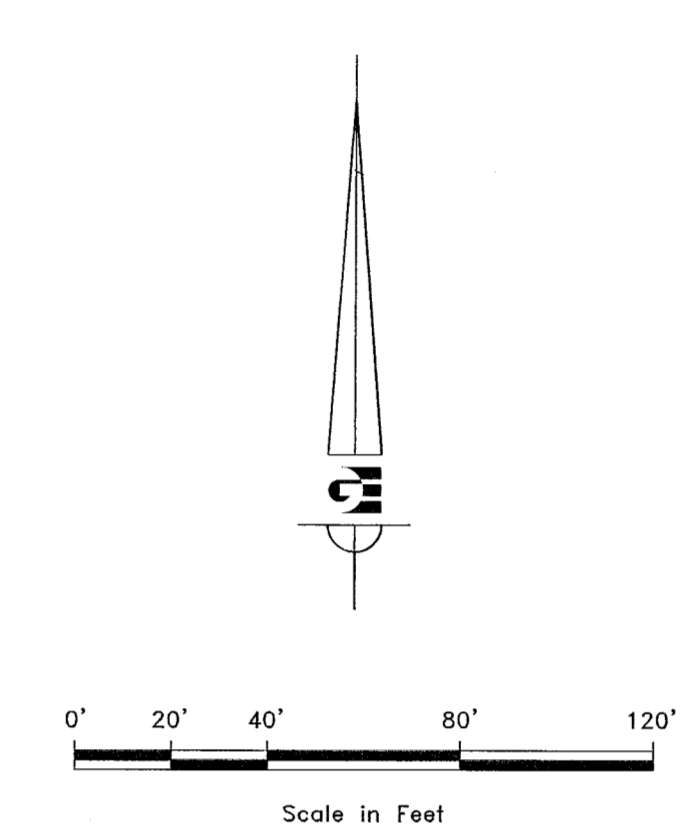

- LEGEND**
- ◆ WEBER COUNTY MONUMENT AS NOTED
 - SET 24" REBAR AND CAP MARKED GARDNER ENGINEERING
 - SUBDIVISION BOUNDARY
 - - - LOT LINE
 - - - ADJACENT PARCEL
 - - - SECTION LINE
 - - - EASEMENT
 - × EXISTING FENCE LINE

NARRATIVE

THE PURPOSE OF THIS SURVEY WAS TO ESTABLISH AND SET THE PROPERTY CORNERS OF THE PARCEL AS SHOWN AND DESCRIBED HEREON. THE SURVEY WAS ORDERED BY DANIEL SORENSON AND NATALIE FRANK. THE CONTROL USED TO ESTABLISH THE PROPERTY CORNERS WAS THE EXISTING SURVEY MONUMENTATION SURROUNDING SECTION 3, TOWNSHIP 5 NORTH, RANGE 2 WEST, OF THE SALT LAKE BASE AND MERIDIAN. THE BASIS OF BEARING IS THE EAST LINE OF THE SOUTHEAST QUARTER OF SAID SECTION WHICH BEARS SOUTH 00°51'36" WEST, WEBER COUNTY, UTAH NORTH, NAD 83 STATE PLANE GRID BEARING. THIS SURVEY WAS BASED ON THE MEASUREMENT OF FENCE LINES WITHIN THE NORTHEAST QUARTER OF THE SOUTHEAST QUARTER OF SAID SECTION.

SURVEYOR'S CERTIFICATE

I, KLINT H. WHITNEY, DO HEREBY CERTIFY THAT I AM A LICENSED PROFESSIONAL LAND SURVEYOR IN THE STATE OF UTAH AND THAT I HOLD CERTIFICATE NO. 8227228 IN ACCORDANCE WITH TITLE 58, CHAPTER 22, OF THE PROFESSIONAL ENGINEERS AND LAND SURVEYORS ACT. I FURTHER CERTIFY THAT BY AUTHORITY OF THE OWNERS I HAVE COMPLETED A SURVEY OF THE PROPERTY DESCRIBED ON THIS RECORD OF SURVEY PLAT IN ACCORDANCE WITH SECTION 17-23-20 AND HAVE VERIFIED ALL MEASUREMENTS; THAT THE REFERENCE MONUMENTS SHOWN ON THIS RECORD OF SURVEY PLAT ARE LOCATED AS INDICATED AND ARE SUFFICIENT TO RETRACE OR REESTABLISH THIS SURVEY; AND THAT THE INFORMATION SHOWN HEREIN IS SUFFICIENT TO ACCURATELY ESTABLISH THE LATERAL BOUNDARIES OF THE HEREIN DESCRIBED TRACT OF REAL PROPERTY.

SIGNED THIS 16TH DAY OF MARCH, 2017.

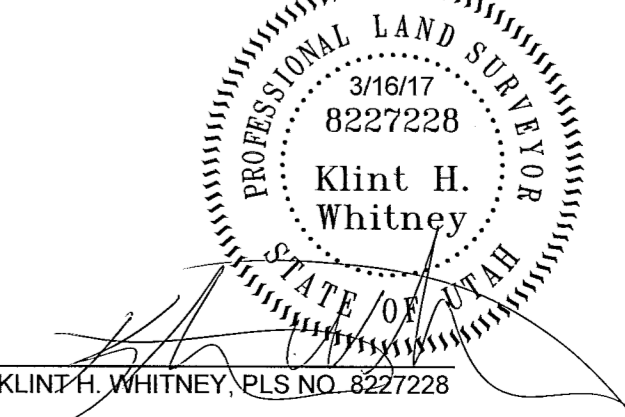

SCALE: 1"=40'	DATE: 3/16/17	DESIGN: _____	DRAWN: KHV	CHECKED: KHV
REVISIONS	DESCRIPTION	DATE		

DWG.: R2001 - MISC SURVEY 1114 - DANIEL SORENSON SURVEY COMPANY/ROSDWG

RECEIVED
MAY 09 2017
BY: 5122

PROPERTY SURVEY FOR SORENSON/FRANK
3696 N 2850 W & 3655 N 2700 W, WEBER CO. UTAH
LOCATED IN THE SOUTHEAST QUARTER OF SECTION 3,
TOWNSHIP 5 NORTH, RANGE 2 WEST, S.L.B. AND M.

GARDNER ENGINEERING
CIVIL - LAND PLANNING
MUNICIPAL - LAND SURVEYING
1510 SOUTH 875 EAST OGDEN, UT
OFFICE: 801-476-0202 FAX: 801-476-0066

S1
1

FOUND
SE COR. SEC. 3
T5N, R2W, S.L.B. & M.
3" BRASS CAP 1960