

| | |
|----------|---|
| SCALE: | 1:20 XREF |
| DATE: | 4/12/17 |
| DESIGN: | |
| DRAWN: | KHW |
| CHECKED: | KHW |
| DWG.: | R390 - MISC SURVEY/1731 - RICHARD MOORE SURVEY/1731 - RICHARD MOORE SURVEY/1731 |

RECEIVED
MAY 09 2017
BY: 5123

PROPERTY SURVEY FOR RICHARD MOORE
PARCEL NUMBER 140800001, OGDEN, UT 84404
LOCATED IN THE NORTHEAST QUARTER OF SECTION 34,
TOWNSHIP 6 NORTH, RANGE 1 WEST, S.L.B. AND M.

GARDNER ENGINEERING
CIVIL, LAND PLANNING
MUNICIPAL, LAND SURVEYING
5150 SOUTH 875 EAST OGDEN, UT
OFFICE: 801-476-0202 FAX: 801-476-0066

S1
1

SURVEYOR'S CERTIFICATE

I, KLINT H. WHITNEY, DO HEREBY CERTIFY THAT I AM A LICENSED PROFESSIONAL LAND SURVEYOR IN THE STATE OF UTAH AND THAT I HOLD CERTIFICATE NO. 8227228 IN ACCORDANCE WITH TITLE 58, CHAPTER 22, OF THE PROFESSIONAL ENGINEERS AND LAND SURVEYORS ACT. I FURTHER CERTIFY THAT BY AUTHORITY OF THE OWNERS I HAVE COMPLETED A SURVEY OF THE PROPERTY DESCRIBED ON THIS RECORD OF SURVEY PLAT IN ACCORDANCE WITH SECTION 17-23-20 AND HAVE VERIFIED ALL MEASUREMENTS; THAT THE REFERENCE MONUMENTS SHOWN ON THIS RECORD OF SURVEY PLAT ARE LOCATED AS INDICATED AND ARE SUFFICIENT TO RETRACE OR REESTABLISH THIS SURVEY; AND THAT THE INFORMATION SHOWN HEREIN IS SUFFICIENT TO ACCURATELY ESTABLISH THE LATERAL BOUNDARIES OF THE HEREIN DESCRIBED TRACT OF REAL PROPERTY.

SIGNED THIS 9th DAY OF March, 2017.

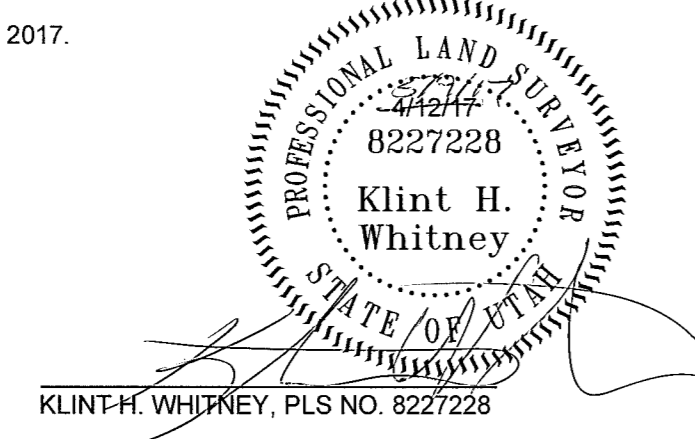

NARRATIVE

THE PURPOSE OF THE SURVEY WAS TO ESTABLISH THE BOUNDARY AND TOPOGRAPHY OF THE PARCEL NUMBER 140800001 AS SHOWN AND DESCRIBED HEREON. THE SURVEY WAS ORDERED BY RICHARD MOORE. THE CONTROL USED TO ESTABLISH THE BOUNDARY WAS THE EXISTING OGDEN CITY SURVEY MONUMENTATION AS SHOWN AND NOTED HEREON. THE BASIS OF BEARING IS THE LINE BETWEEN THE CENTERLINE MONUMENT AT 29TH STREET AND BUCHANAN AVENUE AND THE CENTERLINE MONUMENT AT THE INTERSECTION OF KERSHAW STREET AND BUCHANAN AVENUE WHICH BEARS NORTH 1°18'23" EAST, WEBER COUNTY UTAH NORTH, NAD 83, STATE PLANE GRID BEARING.

BOUNDARY DESCRIPTION

ALL OF LOTS 22 AND 23 AND A PORTION OF LOTS 21 AND 24 NOB HILL ANNEX, TOGETHER WITH THE NORTH HALF OF THE VACATED ALLEY ADJOINING TO THE SOUTH, TOGETHER WITH THE VACATED PORTIONS OF KERSHAW STREET ADJOINING TO THE NORTH, MORE PARTICULARLY DESCRIBED AS FOLLOWS: BEGINNING AT A POINT ON THE BOUNDARY LINE OF THE MEMORY HILL ESTATES SUBDIVISION BEING LOCATED NORTH 1°18'23" EAST 360.45 FEET ALONG THE MONUMENTED CENTERLINE OF BUCHANAN AVENUE BETWEEN THE INTERSECTIONS OF 29TH STREET AND KERSHAW AND SOUTH 90°00'00" WEST 470.89 FEET FROM THE OGDEN CITY CENTERLINE MONUMENT AT THE INTERSECTION OF 29TH STREET AND BUCHANAN; RUNNING THENCE ALONG SAID SUBDIVISION BOUNDARY THE FOLLOWING TWO (2) COURSES: (1) NORTH 88°41'10" WEST 17.94 FEET; (2) SOUTH 1°18'23" WEST 155.11; THENCE NORTH 88°41'37" WEST 149.54 FEET; THENCE NORTH 0°44'59" EAST 184.93 FEET; THENCE SOUTH 88°41'30" EAST 169.19 FEET TO THE WEST RIGHT-OF-WAY LINE OF KERSHAW STREET; THENCE ALONG SAID RIGHT-OF-WAY LINE ALONG THE ARC OF A CURVE TO THE LEFT 30.55 FEET, HAVING A RADIUS OF 40.00 FEET, A CENTRAL ANGLE OF 43°45'34", AND WHICH CHORD BEARS SOUTH 1°08'54" WEST 29.81 FEET TO THE POINT OF BEGINNING, CONTAINING 0.64 ACRES.

LEGEND

- WEBER COUNTY MONUMENT AS NOTED
- SET 24" REBAR AND CAP MARKED GARDNER ENGINEERING
- FOUND GREAT BASIN ENGINEERING REBAR AND CAP
- LOT BOUNDARY
- CENTERLINE
- ADJACENT PARCEL
- SECTION LINE
- EXISTING SEWER MANHOLE
- EXISTING SANITARY SEWER LINE
- EXISTING WATER METER
- EXISTING CONCRETE
- EXISTING CONCRETE PILLARS 16"X16"
- EXISTING ASPHALT
- EXISTING FENCE LINE
- 1' CONTOUR
- 5' CONTOUR

