

BOUNDARY DESCRIPTION
 ALL OF LOT 10, COTTONWOOD HILLS ESTATES SUBDIVISION PHASE 2, WEBER COUNTY, UTAH,
 ACCORDING TO THE OFFICIAL PLAT THEREOF.

SCALE: 1" = 20'	DATE: 4/3/17	DESIGN: _____	DRAWN: KHW	CHECKED: KHW
REVISIONS	DESCRIPTION			
DATE				
DWG.: S:\0801 - MISC SURVEYS\2017 - BRETT HARROP SURVEY\DWG\BRETTHARROP.DWG				

RECEIVED
 MAY 09 2017
 BY: 5724

PROPERTY SURVEY FOR BRETT HARROP
 3943 NORTH 3775 EAST, EDEN, UTAH
 LOCATED IN THE EAST HALF OF SECTION 20,
 TOWNSHIP 7 NORTH, RANGE 1 EAST, S.L.B. AND M.

GARDNER ENGINEERING
 CIVIL - LAND PLANNING
 MUNICIPAL - LAND SURVEYING
 150 SOUTH 700 EAST, EDEN, UT
 OFFICE: 801.476.0202 FAX: 801.476.0168

S1
 1

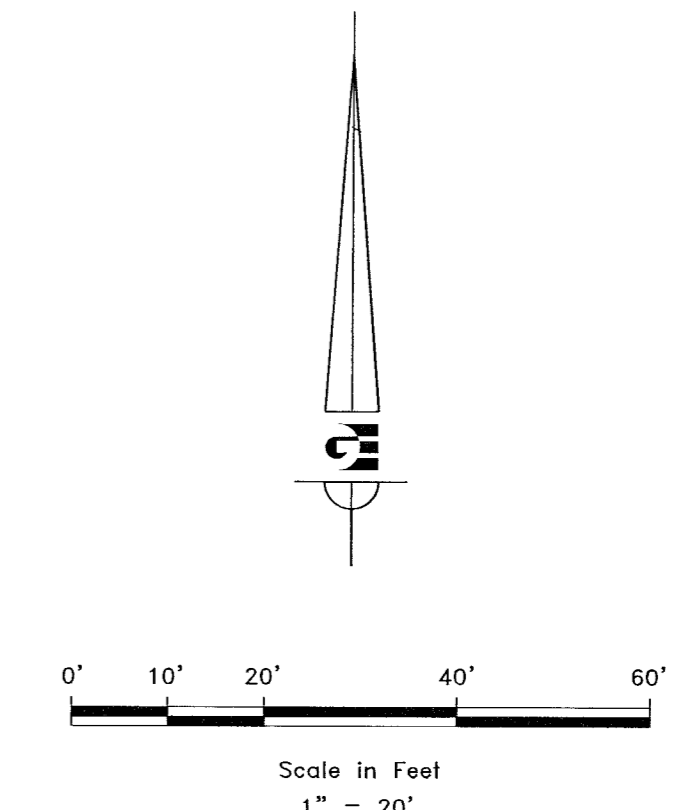

- LEGEND**
- ◆ WEBER COUNTY MONUMENT AS NOTED
 - SET 24" REBAR AND CAP MARKED GARDNER ENGINEERING
 - SUBDIVISION BOUNDARY
 - LOT LINE
 - - - ADJACENT PARCEL
 - - - SECTION LINE
 - - - EASEMENT
 - x - EXISTING FENCE LINE

NARRATIVE

THE PURPOSE OF THE SURVEY WAS TO DO AN AGRICULTURAL DIVISION OF THE PARCELS AS SHOWN AND DESCRIBED HEREON. NO DEVELOPMENT CAN OCCUR ON PARCELS A&B UNTIL THE INDIVIDUAL PARCEL GOES THROUGH THE PROPER SUBDIVISION PROCESS AND GETS APPROVAL FROM THE GOVERNING MUNICIPALITY. THE SURVEY WAS ORDERED BY CHUCK HEWARD. THE CONTROL USED TO ESTABLISH THE BOUNDARY WAS THE EXISTING WEBER COUNTY SURVEY MONUMENTATION AS SHOWN AND NOTED HEREON. THE BASIS OF BEARING IS THE EAST LINE OF THE SOUTHEAST QUARTER OF SECTION 27, TOWNSHIP 7 NORTH, RANGE 1 EAST, OF THE SALT LAKE BASE AND MERIDIAN WHICH BEARS SOUTH 0°22'02" WEST WEBER COUNTY GRID BEARING.

SURVEYOR'S CERTIFICATE

I, KLINT H. WHITNEY, DO HEREBY CERTIFY THAT I AM A LICENSED PROFESSIONAL LAND SURVEYOR IN THE STATE OF UTAH AND THAT I HOLD CERTIFICATE NO. 8227228 IN ACCORDANCE WITH TITLE 58, CHAPTER 22, OF THE PROFESSIONAL ENGINEERS AND LAND SURVEYORS ACT. I FURTHER CERTIFY THAT BY AUTHORITY OF THE OWNERS I HAVE COMPLETED A SURVEY OF THE PROPERTY DESCRIBED ON THIS RECORD OF SURVEY PLAT IN ACCORDANCE WITH SECTION 17-23-20 AND HAVE VERIFIED ALL MEASUREMENTS; THAT THE REFERENCE MONUMENTS SHOWN ON THIS RECORD OF SURVEY PLAT ARE LOCATED AS INDICATED AND ARE SUFFICIENT TO RETRACE OR REESTABLISH THIS SURVEY; AND THAT THE INFORMATION SHOWN HEREIN IS SUFFICIENT TO ACCURATELY ESTABLISH THE LATERAL BOUNDARIES OF THE HEREIN DESCRIBED TRACT OF REAL PROPERTY.

SIGNED THIS 3RD DAY OF APRIL, 2017.

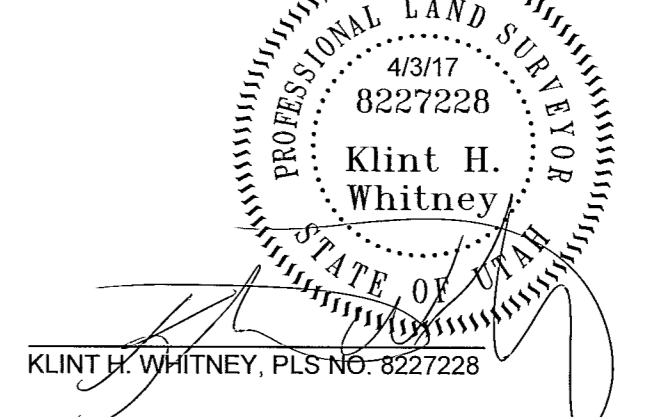

KLINT H. WHITNEY, PLS NO. 8227228