

LYNN & SHARON MUIRBOOK  
150880009

VAL E & LINDA STAKER  
150880008  
CONTAINING 1.135 ACRES

VAL E & LINDA STAKER  
150880001  
CONTAINING 2.185 ACRES

JAVIER LOPEZ  
150880022

SHELLEY GAILEY  
150880013

VAL E & LINDA STAKER  
150880005

- WEBER COUNTY MONUMENT AS NOTED
- SET 24" REBAR AND CAP MARKED GARDNER ENGINEERING
- PROPERTY LINE
- ADJACENT PARCEL
- SECTION LINE
- EXISTING BUILDING
- EXISTING FENCE
- 2550 SOUTH RIGHT-OF-WAY
- DEED OVERLAP AREA

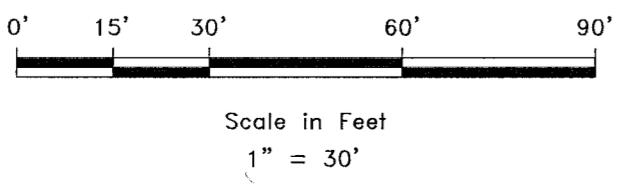

**NARRATIVE:**

THE PURPOSE OF THIS SURVEY WAS TO ESTABLISH AND SET THE PROPERTY CORNERS OF THE PARCEL AS SHOWN AND DESCRIBED HEREON. THE SURVEY WAS ORDERED BY LYNN MUIRBOOK. IT IS RECOMMENDED THAT THESE PARCELS GO FILE A BOUNDARY LINE AGREEMENT. THE CONTROL USED TO ESTABLISH THE PROPERTY CORNERS WAS THE EXISTING WEBER COUNTY SURVEY MONUMENTATION SURROUNDING SECTION 33, TOWNSHIP 6 NORTH, RANGE 2 WEST, OF THE SALT LAKE BASE AND MERIDIAN. THE BASIS OF BEARING IS THE NORTH LINE OF THE NORTHEAST QUARTER OF SAID SECTION WHICH BEARS SOUTH 89°07'43" EAST WEBER COUNTY, UTAH NORTH, NAD 83 STATE PLANE GRID BEARING.

**SURVEYOR'S CERTIFICATE**

I, KLINT H. WHITNEY, DO HEREBY CERTIFY THAT I AM A LICENSED PROFESSIONAL LAND SURVEYOR IN THE STATE OF UTAH AND THAT I HOLD CERTIFICATE NO. 8227228 IN ACCORDANCE WITH TITLE 58, CHAPTER 22, OF THE PROFESSIONAL ENGINEERS AND LAND SURVEYORS ACT; I FURTHER CERTIFY THAT BY AUTHORITY OF THE OWNERS I HAVE COMPLETED A SURVEY OF THE PROPERTY DESCRIBED ON THIS RECORD OF SURVEY PLAT IN ACCORDANCE WITH SECTION 17-23-20 AND HAVE VERIFIED ALL MEASUREMENTS; THAT THE REFERENCE MONUMENTS SHOWN ON THIS RECORD OF SURVEY PLAT ARE LOCATED AS INDICATED AND ARE SUFFICIENT TO RETRACE OR REESTABLISH THIS SURVEY; AND THAT THE INFORMATION SHOWN HEREIN IS SUFFICIENT TO ACCURATELY ESTABLISH THE LATERAL BOUNDARIES OF THE HEREIN DESCRIBED TRACT OF REAL PROPERTY.

SIGNED THIS 16TH DAY OF MAY, 2017.

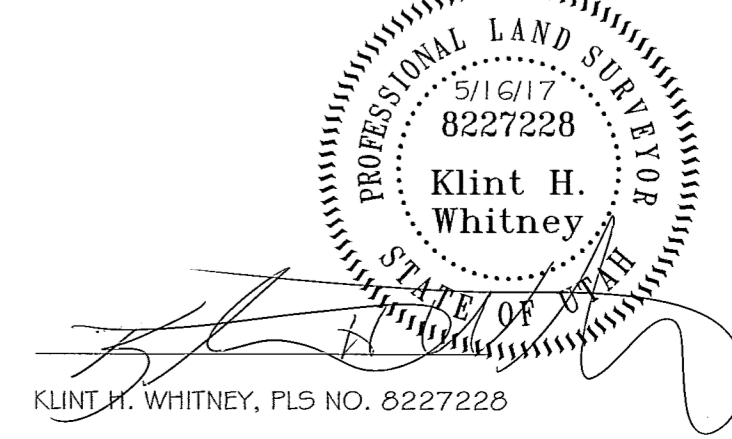

**AS SURVEYED PARCEL 150880001 BOUNDARY DESCRIPTION**

A PART OF THE NORTHEAST QUARTER OF SECTION 33, TOWNSHIP 6 NORTH, RANGE 2 WEST, OF THE SALT LAKE BASE AND MERIDIAN. BEGINNING AT A POINT ON THE SOUTH RIGHT-OF-WAY LINE OF 2550 SOUTH STREET BEING LOCATED SOUTH 89°07'43" EAST 1433.63 FEET ALONG THE NORTH LINE OF SAID NORTH EAST QUARTER AND SOUTH 00°52'55" WEST 33.00 FEET FROM THE NORTHWEST CORNER OF SAID NORTHEAST QUARTER, SAID POINT ALSO BEING LOCATED SOUTH 89°07'43" EAST 107.00 FEET AND SOUTH 00°52'55" WEST 33.00 FEET FROM THE NORTHWEST CORNER OF THE NORTHWEST QUARTER OF SAID NORTHEAST QUARTER, RUNNING THENCE ALONG SAID SOUTH RIGHT-OF-WAY LINE SOUTH 89°07'43" EAST 206.07 FEET; THENCE SOUTH 00°53'26" WEST 462.02 FEET; THENCE NORTH 89°07'47" WEST 206.00 FEET; THENCE NORTH 00°52'55" EAST 462.03 FEET TO THE POINT OF BEGINNING. CONTAINING 2.185 ACRES.

**RECORD PARCEL 150880001 BOUNDARY DESCRIPTION**

PART OF THE NORTHEAST QUARTER OF THE NORTHEAST QUARTER OF SECTION 33, TOWNSHIP 6 NORTH, RANGE 2 WEST, SALT LAKE BASE AND MERIDIAN, U.S. SURVEY; BEGINNING AT A POINT 107 FEET EAST OF THE NORTHWEST CORNER OF THE NORTHEAST QUARTER OF THE NORTHEAST QUARTER OF SAID SECTION 33, RUNNING THENCE EAST 206 FEET, THENCE SOUTH 30 RODS, THENCE WEST 206 FEET, THENCE NORTH 30 RODS TO THE PLACE OF BEGINNING.

**BOUNDARY LINE ADJUSTMENT PARCEL 150880001 BOUNDARY DESCRIPTION**

A PART OF THE NORTHEAST QUARTER OF SECTION 33, TOWNSHIP 6 NORTH, RANGE 2 WEST, OF THE SALT LAKE BASE AND MERIDIAN. BEGINNING AT A POINT ON THE SOUTH RIGHT-OF-WAY LINE OF 2550 SOUTH STREET BEING LOCATED SOUTH 89°07'43" EAST 1433.63 FEET ALONG THE NORTH LINE OF SAID NORTH EAST QUARTER AND SOUTH 00°52'55" WEST 33.00 FEET FROM THE NORTHWEST CORNER OF SAID NORTHEAST QUARTER, SAID POINT ALSO BEING LOCATED SOUTH 89°07'43" EAST 107.00 FEET AND SOUTH 00°52'55" WEST 33.00 FEET FROM THE NORTHWEST CORNER OF THE NORTHWEST QUARTER OF SAID NORTHEAST QUARTER, RUNNING THENCE ALONG SAID SOUTH RIGHT-OF-WAY LINE SOUTH 89°07'43" EAST 206.07 FEET; THENCE SOUTH 00°53'26" WEST 462.02 FEET; THENCE NORTH 89°07'47" WEST 206.00 FEET; THENCE NORTH 00°52'55" EAST 48.00 FEET; THENCE NORTH 89°07'05" WEST 22.00 FEET; THENCE NORTH 00°52'55" EAST 33.63 FEET TO THE POINT OF BEGINNING. CONTAINING 2.161 ACRES.

**AS SURVEYED PARCEL 150880008 BOUNDARY DESCRIPTION**

A PART OF THE NORTHEAST QUARTER OF SECTION 33, TOWNSHIP 6 NORTH, RANGE 2 WEST, OF THE SALT LAKE BASE AND MERIDIAN. BEGINNING AT A POINT ON THE SOUTH RIGHT-OF-WAY LINE OF 2550 SOUTH STREET BEING LOCATED SOUTH 89°07'43" EAST 1433.63 FEET ALONG THE NORTH LINE OF SAID NORTH EAST QUARTER AND SOUTH 00°52'55" WEST 33.00 FEET FROM THE NORTHWEST CORNER OF SAID NORTHEAST QUARTER, SAID POINT ALSO BEING LOCATED SOUTH 89°07'43" EAST 107.00 FEET AND SOUTH 00°52'55" WEST 33.00 FEET FROM THE NORTHWEST CORNER OF THE NORTHWEST QUARTER OF SAID NORTHEAST QUARTER, RUNNING THENCE SOUTH 00°52'55" WEST 462.03 FEET; THENCE NORTH 89°07'47" WEST 107.00 FEET TO THE WEST LINE OF THE NORTHEAST QUARTER OF THE NORTHEAST QUARTER OF SAID SECTION; THENCE ALONG SAID LINE NORTH 00°52'55" EAST 462.03 FEET TO A POINT ON SAID RIGHT-OF-WAY LINE; THENCE ALONG SAID RIGHT-OF-WAY LINE SOUTH 89°07'43" EAST 107.00 FEET TO THE POINT OF BEGINNING. CONTAINING 1.135 ACRES.

**RECORD PARCEL 150880008 BOUNDARY DESCRIPTION**

PART OF THE NORTHEAST QUARTER OF SECTION 33, TOWNSHIP 6 NORTH, RANGE 2 WEST, SALT LAKE MERIDIAN, U.S. SURVEY; BEGINNING AT THE NORTHWEST CORNER OF THE NORTHEAST QUARTER OF THE NORTHEAST QUARTER OF SECTION 33, TOWNSHIP 6 NORTH, RANGE 2 WEST, OF THE SALT LAKE BASE AND MERIDIAN, THENCE SOUTH 30 RODS (495 FEET); MORE OR LESS, TO POINT OF BEGINNING.

**BOUNDARY LINE ADJUSTMENT PARCEL 150880008 BOUNDARY DESCRIPTION**

A PART OF THE NORTHEAST QUARTER OF SECTION 33, TOWNSHIP 6 NORTH, RANGE 2 WEST, OF THE SALT LAKE BASE AND MERIDIAN. BEGINNING AT A POINT ON THE SOUTH RIGHT-OF-WAY LINE OF 2550 SOUTH STREET BEING LOCATED SOUTH 89°07'43" EAST 1433.63 FEET ALONG THE NORTH LINE OF SAID NORTH EAST QUARTER AND SOUTH 00°52'55" WEST 33.00 FEET FROM THE NORTHWEST CORNER OF SAID NORTHEAST QUARTER, SAID POINT ALSO BEING LOCATED SOUTH 89°07'43" EAST 107.00 FEET AND SOUTH 00°52'55" WEST 33.00 FEET FROM THE NORTHWEST CORNER OF THE NORTHWEST QUARTER OF SAID NORTHEAST QUARTER, RUNNING THENCE SOUTH 00°52'55" WEST 333.63 FEET; THENCE SOUTH 89°07'05" EAST 22.00 FEET; THENCE SOUTH 0°52'55" WEST 48.00 FEET; THENCE NORTH 89°07'05" WEST 22.00 FEET; THENCE SOUTH 00°52'55" WEST 80.39 FEET; THENCE NORTH 89°07'47" WEST 107.00 FEET; THENCE NORTH 00°52'55" EAST 462.03 FEET TO A POINT ON SAID RIGHT-OF-WAY LINE; THENCE ALONG SAID RIGHT-OF-WAY LINE SOUTH 89°07'43" EAST 107.00 FEET TO THE POINT OF BEGINNING. CONTAINING 1.159 ACRES.

SCALE	1" = 30'
DATE	5/16/17
DESIGN	
DRAWN	KHW
CHECKED	KHW
REVISIONS	
DESCRIPTION	
DATE	

RECEIVED  
MAY 09 2017  
BY: 5726

PROPERTY SURVEY FOR VAL E STAKER PROPERTY  
3669 WEST 2550 SOUTH, WEBER COUNTY, UTAH  
LOCATED IN THE NORTHEAST QUARTER OF SECTION 33,  
TOWNSHIP 6 NORTH, RANGE 2 WEST, S.L.B. AND M.

**GARDNER ENGINEERING**  
CIVIL - LAND PLANNING  
MUNICIPAL - LAND SURVEYING

01  
1