

**SURVEYOR'S CERTIFICATE**  
 I, DARREN R. WILLIAMS, DO HEREBY CERTIFY THAT I AM A PROFESSIONAL LAND SURVEYOR, HOLDING CERTIFICATE NUMBER 4975981, AS PRESCRIBED BY THE LAWS OF THE STATE OF UTAH. I FURTHER CERTIFY THAT I HAVE DIRECTLY SUPERVISED A SURVEY OF THE PARCEL(S) OF LAND REPRESENTED HEREON AND HAVE HAD STAKED ON THE GROUND THE BOUNDARY CORNERS AS SHOWN ON THIS PLAT.

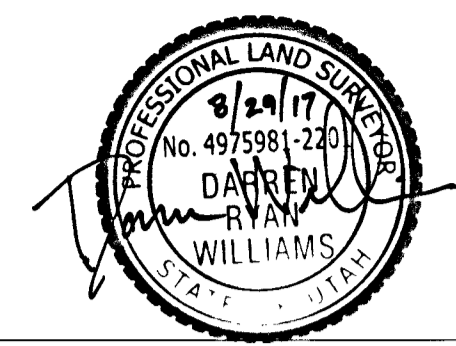

DARREN R. WILLIAMS  
 PLS NO. 4975981

**LEGAL DESCRIPTIONS:**

**PARCEL 1:**  
 A PARCEL OF LAND SITUATE IN THE SOUTHEAST QUARTER OF SECTION 28 AND THE NORTHEAST QUARTER OF SECTION 33, TOWNSHIP 7 NORTH, RANGE 1 WEST, SALT LAKE BASE & MERIDIAN. THE BOUNDARIES OF SAID PARCEL ARE MORE PARTICULARLY DESCRIBED AS FOLLOWS:

BEGINNING AT A POINT IN THE NORTHERLY RIGHT OF WAY LINE OF 2600 NORTH STREET, SAID POINT IS S.89°04'49"E. 50.38 FEET (EAST 50.00 FEET BY RECORD) FROM THE SOUTHEAST CORNER OF LOT 1, BLOCK 14, PLAT A, NORTH OGDEN SURVEY; THENCE N.01°03'59"E. (NORTH BY RECORD) 193.00 FEET; THENCE N.89°04'49"W. 51.38 FEET (WEST 50.00 FEET BY RECORD) TO THE NORTH-SOUTH QUARTER SECTION LINE OF SAID SECTION 33, SAID LINE IS ALSO THE EASTERLY LINE OF SAID PLAT A, NORTH OGDEN SURVEY; THENCE N.00°46'09"E. (NORTH BY RECORD) 34.08 FEET ALONG SAID QUARTER SECTION LINE TO THE SOUTH QUARTER CORNER OF SAID SECTION 28; THENCE N.01°12'38"E. (NORTH BY RECORD) 199.46 FEET ALONG THE NORTH-SOUTH QUARTER SECTION LINE OF SAID SECTION 28 TO THE SOUTHERLY BOUNDARY LINE OF WARREN ACRES PHASE 2 AS SHOWN ON THE OFFICIAL PLAT THEREOF, RECORDED IN THE OFFICE OF THE WEBER COUNTY RECORDER IN BOOK 40 AT PAGE 49 OF PLATS; THENCE S.88°56'01"E. 330.24 FEET (EAST 20.25 ROODS BY RECORD) ALONG SAID SOUTHERLY BOUNDARY LINE; THENCE S.01°10'16"W. 52.38 FEET (SOUTH 51.42 FEET BY RECORD) TO A POINT IN AN EXISTING FENCE LINE; THENCE N.88°38'22"W. 46.99 FEET (N.89°17'00"W. 52.53 FEET BY RECORD) ALONG SAID FENCE LINE; THENCE S.01°51'10"W. 248.71 FEET (S.01°20'33"W. 250.61 FEET BY RECORD) ALONG AN EXISTING FENCE LINE; THENCE N.89°04'49"W. 74.43 FEET (WEST 72°00'W. 71.37 FEET BY RECORD); THENCE S.01°12'11"W. (S.02°05'20"W. BY RECORD) 125.00 FEET TO SAID NORTHERLY RIGHT OF WAY LINE; THENCE N.89°04'49"W. 153.95 FEET (WEST 150.17 FEET BY RECORD) ALONG SAID NORTHERLY RIGHT OF WAY LINE TO THE POINT OF BEGINNING.

THE ABOVE DESCRIBED PARCEL OF LAND CONTAINS 103,166 SQUARE FEET OR 2.37 ACRES IN AREA, MORE OR LESS.

**PARCEL 2:**  
 ALL OF LOTS 1 AND 6, BLOCK 14, PLAT A, NORTH OGDEN SURVEY, ACCORDING TO THE OFFICIAL PLAT THEREOF, RECORDED IN THE OFFICE OF THE WEBER COUNTY RECORDER IN BOOK 5 AT PAGE 79.

LESS THE SOUTH 193.00 FEET OF SAID LOT 1.

TOGETHER WITH THE SOUTHERLY 33.00 FEET OF THE VACATED 2650 NORTH STREET PER THAT CERTAIN ORDINANCE RECORDED ON MAY 12, 1995 IN BOOK 1756 AT PAGE 1820.

THE BOUNDARIES OF SAID PARCEL ARE MORE PARTICULARLY DESCRIBED AS FOLLOWS:

BEGINNING AT A POINT IN THE EASTERLY LOT LINE OF SAID LOT 1, SAID POINT IS N.00°46'09"E. (NORTH BY RECORD) 193.00 FEET ALONG SAID LOT LINE FROM THE SOUTHEAST CORNER OF SAID LOT 1; THENCE N.89°04'49"W. 100.13 FEET TO A POINT IN THE WESTERLY LOT LINE OF SAID LOT 1; THENCE N.01°06'08"E. 233.79 FEET TO THE SOUTHERLY BOUNDARY LINE OF WARREN ACRES PHASE 2 AS SHOWN ON THE OFFICIAL PLAT THEREOF, RECORDED IN THE OFFICE OF THE WEBER COUNTY RECORDER IN BOOK 40 AT PAGE 49 OF PLATS; THENCE S.88°56'01"E. 100.31 FEET ALONG SAID SOUTHERLY BOUNDARY LINE TO A POINT IN THE NORTH-SOUTH QUARTER SECTION LINE OF SAID SECTION 28; THENCE S.01°12'38"W. (S.00°17'00"W. BY RECORD) 199.46 FEET ALONG SAID QUARTER SECTION LINE TO THE SOUTH QUARTER CORNER OF SAID SECTION 28; THENCE S.00°46'09"W. (SOUTH BY RECORD) 34.08 FEET ALONG THE NORTH-SOUTH QUARTER SECTION LINE OF SAID SECTION 33 TO THE POINT OF BEGINNING.

THE ABOVE DESCRIBED PARCEL OF LAND CONTAINS 23,395 SQUARE FEET OR 0.54 ACRE IN AREA, MORE OR LESS.

**PARCEL 3:**  
 A PARCEL OF LAND SITUATE IN THE SOUTHEAST QUARTER OF SECTION 28, TOWNSHIP 7 NORTH, RANGE 1 WEST, SALT LAKE BASE & MERIDIAN. THE BOUNDARIES OF SAID PARCEL ARE MORE PARTICULARLY DESCRIBED AS FOLLOWS:

BEGINNING AT A POINT IN AN EXISTING FENCE LINE WHICH IS S.89°02'18"E. 369.16 FEET (EAST 334.16 FEET BY RECORD) ALONG THE SOUTH LINE OF SAID SECTION 28 AND N.01°10'16"E. 146.21 FEET (NORTH 146.58 FEET BY RECORD); THENCE N.01°10'16"E. 52.58 FEET (NORTH 51.42 FEET BY RECORD) ALONG SAID FENCE LINE TO THE SOUTHEAST CORNER OF LOT 10 OF WARREN ACRES PHASE 2 AS SHOWN ON THE OFFICIAL PLAT THEREOF, RECORDED IN THE OFFICE OF THE WEBER COUNTY RECORDER IN BOOK 40 AT PAGE 49 OF PLATS; THENCE N.88°56'01"W. (WEST BY RECORD) 38.78 FEET ALONG THE SOUTHERLY LOT LINE OF SAID LOT 10; THENCE S.01°10'16"W. 52.38 FEET (SOUTH 51.42 FEET BY RECORD) TO A POINT IN AN EXISTING FENCE LINE; THENCE S.88°38'22"E. (EAST BY RECORD) 38.78 FEET ALONG SAID FENCE LINE TO THE POINT OF BEGINNING.

THE ABOVE DESCRIBED PARCEL OF LAND CONTAINS 2,035 SQUARE FEET OR 0.05 ACRE IN AREA, MORE OR LESS.

**SURVEYOR'S NARRATIVE**  
 IT IS THE INTENT OF THIS PLAT AND THE SURVEY ON WHICH IT IS BASED TO CORRECTLY REPRESENT THE BOUNDARY LINES AND PROPERTY CORNERS OF THE SURVEYED PARCEL DESCRIBED HEREON AS REQUESTED BY STEVE CAMPBELL. THE BASIS OF BEARING FOR THIS SURVEY IS S.89°02'18"E. BETWEEN THE FOUND BRASS CAP REPRESENTING THE SOUTHWEST CORNER OF SECTION 28 AND THE FOUND BRASS CAP REPRESENTING THE SOUTHEAST CORNER OF SAID SECTION 28, TOWNSHIP 7 NORTH, RANGE 1 WEST, SALT LAKE BASE & MERIDIAN. THE FIELD DATA FOR THIS SURVEY WAS COLLECTED IN JUNE OF 2017.

AS PART OF THIS SURVEY, MERIDIAN HAS CONDUCTED FIELD SEARCHES FOR EVIDENCE AND MONUMENTATION. FOUND EVIDENCE AND MONUMENTATION ARE REPRESENTED HEREON. EVERY DOCUMENT OF RECORD REVIEWED AND CONSIDERED AS PART OF THIS SURVEY IS NOTED BELOW. THERE MAY EXIST OTHER EVIDENCE, MONUMENTATION, AND DOCUMENTS THAT COULD AFFECT THIS SURVEY. ANY NEW EVIDENCE, MONUMENTATION, OR DOCUMENTS CONTRADICTORY TO THIS SURVEY SHOULD BE PRESENTED TO THE SURVEYOR FOR HIS REVIEW AND CONSIDERATION.

- WARRANTY DEED RECORDED APRIL 8, 2005; ENTRY NO. 2095738 IN THE WEBER COUNTY RECORDERS OFFICE.
- ORDINANCE RECORDED MAY 12, 1995 IN BOOK 1756 AT PAGE 1820 WHICH VACATED 2650 NORTH STREET.
- COORDINATES FOR STREET MONUMENTS IN 2600 NORTH PROVIDED BY THE WEBER COUNTY SURVEYORS OFFICE. THESE COORDINATES WERE TRANSLATED TO OUR PROJECT COORDINATE SYSTEM USING COORDINATES OF OTHER FOUND MONUMENTS IN THE AREA.
- WEBER COUNTY BEARING SHEET FOR TOWNSHIP 7 NORTH, RANGE 1 WEST, SALT LAKE BASE & MERIDIAN. THIS BEARING SHEET WAS USED TO CALCULATE THE POSITION FOR THE WEST QUARTER CORNER OF SECTION 28 AND THE SOUTH QUARTER CORNER OF SECTION 33.
- RECORD OF SURVEY COMPLETED IN 2002 BY LANDMARK SURVEYING AND ENGINEERING, INC.; MAP NO. 3113. THIS SURVEY WAS PLACED BY ROTATING IT TO THE WEST LINE OF SOUTHWEST QUARTER OF SECTION 28. AFTER ROTATING IT WAS FOUND TO MATCH FENCE LINES AND WAS HELD TO ESTABLISH THE WESTERLY BOUNDARY OF LOTS 1 AND 6 OF THE NORTH OGDEN SURVEY PLAT A.
- RECORD OF SURVEY COMPLETED IN 2004 BY HANSEN & ASSOCIATES, INC.; MAP NO. 3388. THIS SURVEY WAS PLACED BY ROTATING IT TO THE SOUTH LINE OF THE SOUTHEAST QUARTER OF SECTION 28. AFTER ROTATING IT WAS FOUND TO MATCH FENCE LINES AND WAS HELD AS THE EASTERLY BOUNDARY OF PARCELS 1 AND 3.
- SUBDIVISION PLAT FOR WARREN ACRES SUBDIVISION - PHASE 2 RECORDED IN 1995 IN THE WEBER COUNTY RECORDERS OFFICE IN BOOK 40 AT PAGE 49. THIS SURVEY WAS PLACED BY USING THREE (3) FOUND MONUMENTS IN THE WARREN ACRES SUBDIVISIONS AND WAS HELD AS THE NORTHERLY BOUNDARY OF PARCELS 1 AND 3. NO ROTATION WAS NEEDED TO FIT THE MONUMENTS.
- NORTH OGDEN SURVEY PLAT A RECORDED IN 1910 IN THE WEBER COUNTY RECORDERS OFFICE IN BOOK 5 AT PAGE 79. THIS PLAT WAS USED TO DETERMINE THE RIGHT OF WAY WIDTHS FOR 2600 NORTH AND 2650 NORTH. IT WAS ALSO USED TO CALCULATE THE SOUTH QUARTER CORNER OF SECTION 28 BY PRORATING THE SECTION LINE USING THE DISTANCES SHOWN ON THE PLAT AND OUR MEASURED DISTANCE BETWEEN THE SOUTHWEST AND SOUTHEAST CORNERS OF SAID SECTION 28.
- RECORD DESCRIPTIONS OF SUBJECT PARCELS SHOWN HEREON.

**SURVEY NOTES**

- EXCEPT AS SPECIFICALLY STATED OR SHOWN ON THIS PLAT, THIS SURVEY DOES NOT PURPORT TO REFLECT ANY OF THE FOLLOWING WHICH MAY BE APPLICABLE TO THE SUBJECT REAL ESTATE: EASEMENTS, BUILDING SETBACK LINES OR LIMITS; RESTRICTIVE COVENANTS, SUBDIVISION RESTRICTIONS; PERMITTING ISSUES, ZONING OR OTHER LAND USE REGULATIONS; AND ANY OTHER FACTS THAT A CURRENT TITLE COMMITMENT AND REPORT MAY DISCLOSE.
- THIS PLAT AND THE SURVEY ON WHICH IT IS BASED IS VALID ONLY IF THE SURVEYOR'S SEAL AND SIGNATURE IS PRESENT.
- THIS SURVEY DISCLOSES BOUNDARY LINES AND PROPERTY CORNER LOCATIONS ONLY. OTHER THAN SHOWN ON THIS PLAT, NO ATTEMPT HAS BEEN MADE AS PART OF THIS SURVEY TO SHOW THE EXISTENCE OF ANY BUILDING, STRUCTURE, DRIVE, WALK, ASPHALT, CONCRETE, FENCING OR ANY OTHER SURFACE OR SUBSURFACE STRUCTURE OR IMPROVEMENT.
- LAND USE REGULATIONS AND CURRENT ZONING REQUIREMENTS OR RESTRICTIONS HAVE NOT BEEN DETERMINED AND ARE NOT A PART OF THIS SURVEY.
- THIS PLAT AND THE SURVEY ON WHICH IT IS BASED, IS MADE FOR THE ORIGINAL PURCHASER AND NAMED PARTIES OF THIS SURVEY. IT IS NOT TRANSFERABLE TO ADDITIONAL INSTITUTIONS OR SUBSEQUENT OWNERS.
- THE WORDS "CERTIFY" AND "CERTIFICATE" AS SHOWN AND USED HEREON MEANS AN EXPRESSION OF PROFESSIONAL OPINION REGARDING THE FACTS DISCLOSED TO THE SURVEYOR OR INFORMATION IN POSSESSION OF THE SURVEYOR AND DOES NOT CONSTITUTE A WARRANTY OR GUARANTEE OF LEGAL OWNERSHIP, EXPRESSED OR IMPLIED.

(M) BEARING AND/OR DISTANCE DATA TAKEN FROM ACTUAL SURVEYED MEASUREMENTS.  
 (NOS) BEARING AND/OR DISTANCE DATA TAKEN FROM NORTH OGDEN SURVEY PLAT "A" & "B".

**LEGEND**

	PROPERTY BOUNDARY		FOUND SECTION CORNER
	ADJONER LINE		FOUND SECTION CORNER
	SECTION LINE		CALCULATED SECTION CORNER
	MONUMENT LINE		CALCULATED SECTION CORNER
	NORTH OGDEN PLAT "A" LOT LINE		FOUND STREET MONUMENT
	EXISTING CHAIN LINK FENCE LINE		CALCULATED STREET MONUMENT
	EXISTING WIRE FENCE LINE		FOUND REBAR & CAP AS NOTED
	EXISTING WOOD FENCE LINE		FUTURE MONROE BOULEVARD
	UNLESS OTHERWISE NOTED, SET 5/8" BY 24" REBAR WITH ORANGE PLASTIC CAP. CAP IS STAMPED "MERIDIAN PLS 4938744"		

OCT 02 2017  
 BY: 5829

**CURVE TABLE**

CURVE	RADIUS	DELTA	LENGTH	CHORD BEARING	CHORD LENGTH
CI	428.79'	173°6'11"	131.74'	S12°25'34"W	131.22'

<p><b>RECORD OF SURVEY</b></p> <p>PROJECT ADDRESS: 738 E 2600 N,          NORTH OGDEN, UTAH 84414          SITUATE IN THE SE 1/4 OF SEC 28 &amp;          THE NE 1/4 OF SEC 33, T7N, R1W, SLB&amp;M</p>	<p>COMP. FILE 17065_ROS</p> <p>PROJECT NO. 17065</p> <p>SHEET NO. 1 OF 1</p>
---	--

U:\Projects\2017\17065-28-Campbell-Boundary Survey\17065\17065\_2017.dwg Aug 23, 2017 - 10:06am