

**PARCEL # 08-006-0067  
BOUNDARY DESCRIPTION**

PART OF THE SOUTH HALF OF THE NORTHEAST QUARTER OF SECTION 2, TOWNSHIP 5 NORTH, RANGE 2 WEST, SALT LAKE MERIDIAN, BEGINNING AT THE SOUTHWEST CORNER OF SAID NORTHEAST QUARTER AND RUNNING THENCE NORTH 00°36'14" EAST 20.00 FEET, THENCE SOUTH 89°56'44" EAST 574.04 FEET, THENCE NORTH 35°41'55" EAST 329.71 FEET, THENCE SOUTH 54°02'56" EAST 165.16 FEET TO THE WESTERN RIGHT OF WAY OF THE RIO GRANDE WESTERN RAILWAY, THENCE ALONG RIGHT OF WAY LINE SOUTH 34°21'30" WEST 231.34 FEET, THENCE NORTH 89°56'44" WEST 769.79 FEET TO POINT OF BEGINNING.

**PARCEL # 08-006-0074  
BOUNDARY DESCRIPTION**

PART OF THE SOUTH HALF OF THE NORTHEAST QUARTER OF SECTION 2, TOWNSHIP 5 NORTH, RANGE 2 WEST, SALT LAKE MERIDIAN, BEGINNING AT THE SOUTHWEST CORNER OF SAID NORTHEAST QUARTER AND RUNNING THENCE NORTH 00°36'14" EAST 20.00 FEET, THENCE SOUTH 89°56'44" EAST 574.04 FEET, THENCE NORTH 35°41'55" EAST 329.71 FEET TO THE POINT OF BEGINNING, THENCE RUNNING NORTH 35°41'55" EAST 199.44 FEET, THENCE SOUTH 89°56'46" EAST 194.21 FEET, THENCE SOUTH 34°21'30" WEST 313.43 FEET, THENCE NORTH 54°02'56" EAST 165.16 FEET TO THE POINT OF BEGINNING.

**NARRATIVE:**

THE PURPOSE OF THIS SURVEY WAS TO INSTALL FENCE FOR CONVENIENCE OF TWWWID. THE SURVEY WAS ORDERED BY TWWWID. THE BOUNDARY FOR PARCEL # 08-006-0067 WAS ESTABLISHED FROM VESTING DEED ENTRY #2556481, ALONG WITH ADJOINING PROPERTY OWNER DEEDS. THE BOUNDARY FOR PARCEL # 08-006-0074 WAS ESTABLISHED FROM VESTING DEED ENTRY #2837387, ALONG WITH ADJOINING PROPERTY OWNER DEEDS. THE RIGHT-OF-WAY WAS DETERMINED BY WEBER COUNTY RECORDER. THE UTA RIGHT-OF-WAY WAS DETERMINED BY UTA RIGHT-OF-WAY DRAWINGS.

**SURVEYOR'S CERTIFICATE**

I, KLINT H. WHITNEY, DO HEREBY CERTIFY THAT I AM A LICENSED PROFESSIONAL LAND SURVEYOR IN THE STATE OF UTAH AND THAT I HOLD CERTIFICATE NO. 8227228 IN ACCORDANCE WITH TITLE 58, CHAPTER 22, OF THE PROFESSIONAL ENGINEERS AND LAND SURVEYORS ACT; I FURTHER CERTIFY THAT BY AUTHORITY OF THE OWNERS I HAVE COMPLETED A SURVEY OF THE PROPERTY DESCRIBED ON THIS RECORD OF SURVEY PLAT IN ACCORDANCE WITH SECTION 17-23-17 AND HAVE VERIFIED ALL MEASUREMENTS; THAT THE REFERENCE MONUMENTS SHOWN ON THIS RECORD OF SURVEY PLAT ARE LOCATED AS INDICATED AND ARE SUFFICIENT TO RETRACE OR REESTABLISH THIS SURVEY; AND THAT THE INFORMATION SHOWN HEREIN IS SUFFICIENT TO ACCURATELY ESTABLISH THE LATERAL BOUNDARIES OF THE HEREIN DESCRIBED TRACT OF REAL PROPERTY.

SIGNED THIS 13<sup>TH</sup> DAY OF DECEMBER, 2017.

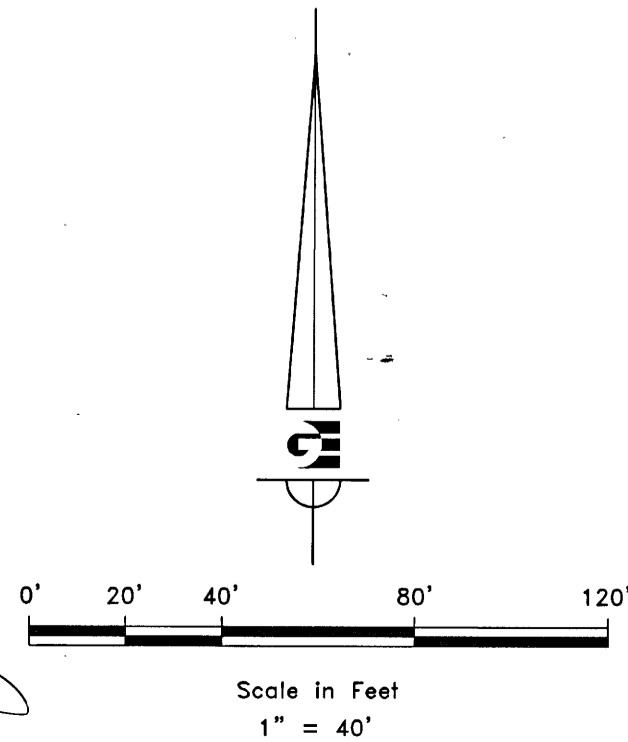
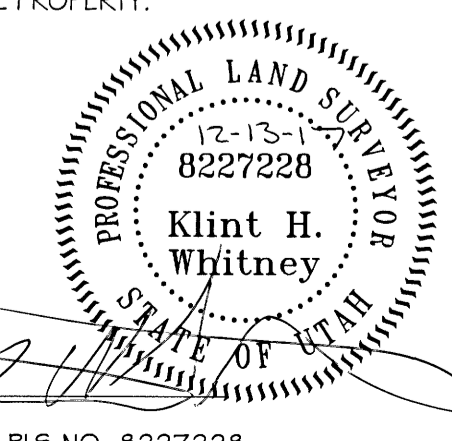

- WEBER COUNTY MONUMENT AS NOTED
- SET 24" REBAR AND CAP MARKED GARDNER ENGINEERING
- PROPERTY LINE
- ADJACENT PARCEL
- SECTION LINE
- EXISTING IRON PIPE FENCE
- EXISTING FENCE

SCALE	1"=20'
DATE	4/16/13
DESIGN	---
DRAWN	KHW
CHECKED	KHW
DWG. NO.	8227228

RECEIVED  
DEC 13 2017  
BY: 5874

BOUNDARY SURVEY FOR TWWWID  
2731 NORTH 850 EAST  
PART OF THE SOUTH HALF OF THE NORTHEAST QUARTER OF SECTION 2  
TOWNSHIP 5 NORTH, RANGE 2 WEST, S.L.B. AND M.

81  
1