

EXISTING 010350059 BOUNDARY DESCRIPTION
 PART OF LOT 6, BLOCK 41, PLAT A, OGDEN CITY SURVEY, WEBER COUNTY, UTAH. BEGINNING AT A POINT 16 RODS EAST OF THE NORTHWEST CORNER OF SAID LOT 6, AND RUNNING THENCE WEST 33.5 FEET, THENCE SOUTH 8 RODS, THENCE EAST 33.5 FEET, THENCE NORTH 8 RODS TO THE PLACE OF BEGINNING.

EXISTING 010350036 BOUNDARY DESCRIPTION
 PART OF LOT 6, BLOCK 41, PLAT A, OGDEN CITY SURVEY, WEBER COUNTY, UTAH. BEGINNING AT THE NORTHEAST CORNER OF LOT 6, BLOCK 41, PLAT A, OGDEN CITY SURVEY; RUNNING THENCE WEST 66 FEET, THENCE SOUTH 264 FEET, THENCE EAST 66 FEET, THENCE NORTH 264 FEET TO THE PLACE OF BEGINNING.

COMBINED PARCEL BOUNDARY DESCRIPTION
 A PART OF LOTS 5 AND 6, BLOCK 41 PLAT A, OGDEN CITY SURVEY LOCATED IN THE SOUTHWEST QUARTER OF SECTION 28, TOWNSHIP 6 NORTH, RANGE 1 WEST, OF THE SALT LAKE BASE AND MERIDIAN. BEGINNING AT A POINT ON THE SOUTH RIGHT-OF-WAY LINE OF 22ND STREET BEING LOCATED SOUTH 88°42'25" EAST 278.88 FEET ALONG THE MONUMENTED CENTERLINE OF 22ND STREET AND SOUTH 00°00'00" EAST 49.51 FEET FROM THE OGDEN CITY SURVEY MONUMENT AT THE INTERSECTION OF ADAMS AVENUE AND 22ND STREET; RUNNING THENCE ALONG SAID SOUTH RIGHT-OF-WAY LINE SOUTH 88°42'25" EAST 101.90 FEET TO THE EAST LINE OF SAID LOT 6; THENCE ALONG THE EAST LINES OF SAID LOT 5 AND 6 SOUTH 01°17'58" WEST 264.95 FEET TO THE SOUTH LINE OF SAID LOT 5; THENCE ALONG THE SOUTH LINE OF SAID LOT 5 NORTH 88°41'59" WEST 68.40 FEET; THENCE NORTH 01°17'57" EAST 132.53 FEET; THENCE NORTH 88°42'25" WEST 33.50 FEET; THENCE NORTH 01°17'57" EAST 132.41 FEET TO THE POINT OF BEGINNING. CONTAINING 22,557 SQ.FT. OR 0.518 ACRES.

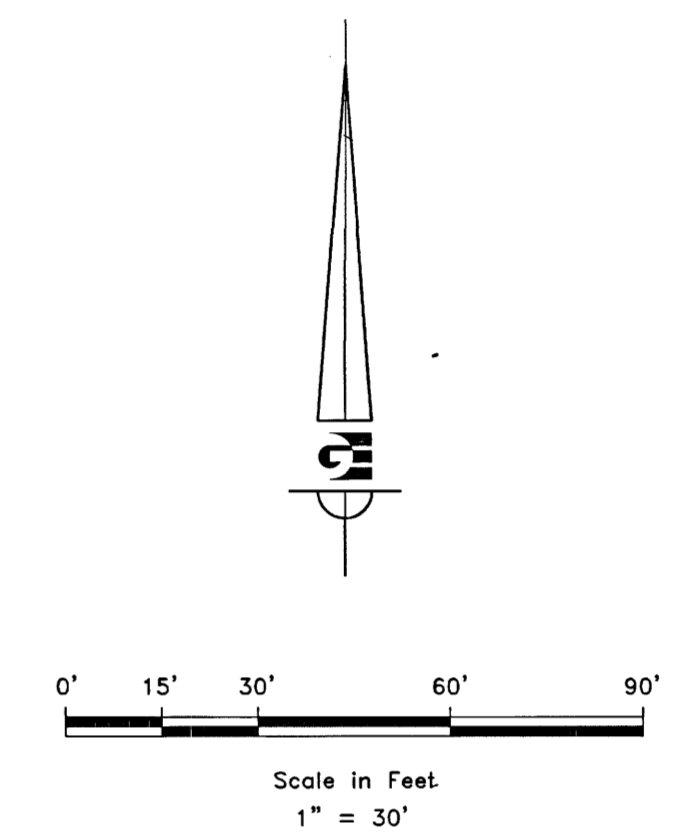

- LEGEND**
- ◆ WEBER COUNTY MONUMENT AS NOTED
 - SET 24" REBAR AND CAP MARKED GARDNER ENGINEERING
 - COMBINED PROPERTY LINE
 - ORIGINAL PROPERTY LINE
 - - - ADJACENT PARCEL
 - - - SECTION LINE
 - - - EASEMENT
 - x — EXISTING FENCE LINE

NARRATIVE

THE PURPOSE OF THIS SURVEY WAS TO ESTABLISH THE BOUNDARIES AND COMBINE OGDEN CITY TAX PARCELS 010350036 AND 0059 AS SHOWN AND DESCRIBED HEREON. THE SURVEY WAS ORDERED BY PARADIGM REAL ESTATE. THE CONTROL USED TO ESTABLISH THE BOUNDARY WAS THE EXISTING OGDEN CITY SURVEY MONUMENTATION AS SHOWN AND NOTED HEREON. THE BASIS OF BEARING IS THE CENTERLINE OF 22ND STREET BETWEEN ADAMS AVENUE AND JEFFERSON AVENUE WHICH BEARS SOUTH 88°42'25" EAST WEBER COUNTY, UTAH NORTH, NAD 83 STATE PLANE GRID BEARING.

SURVEYOR'S CERTIFICATE

I, KLINT H. WHITNEY, DO HEREBY CERTIFY THAT I AM A LICENSED PROFESSIONAL LAND SURVEYOR IN THE STATE OF UTAH AND THAT I HOLD CERTIFICATE NO. 8227228 IN ACCORDANCE WITH TITLE 58, CHAPTER 22, OF THE PROFESSIONAL ENGINEERS AND LAND SURVEYORS ACT. I FURTHER CERTIFY THAT BY AUTHORITY OF THE OWNERS I HAVE COMPLETED A SURVEY OF THE PROPERTY DESCRIBED ON THIS RECORD OF SURVEY PLAT IN ACCORDANCE WITH SECTION 17-23-20 AND HAVE VERIFIED ALL MEASUREMENTS. THAT THE REFERENCE MONUMENTS SHOWN ON THIS RECORD OF SURVEY PLAT ARE LOCATED AS INDICATED AND ARE SUFFICIENT TO RETRACE OR REESTABLISH THIS SURVEY; AND THAT THE INFORMATION SHOWN HEREIN IS SUFFICIENT TO ACCURATELY ESTABLISH THE LATERAL BOUNDARIES OF THE HEREIN DESCRIBED TRACT OF REAL PROPERTY.

SIGNED THIS 13TH DAY OF DECEMBER, 2017.

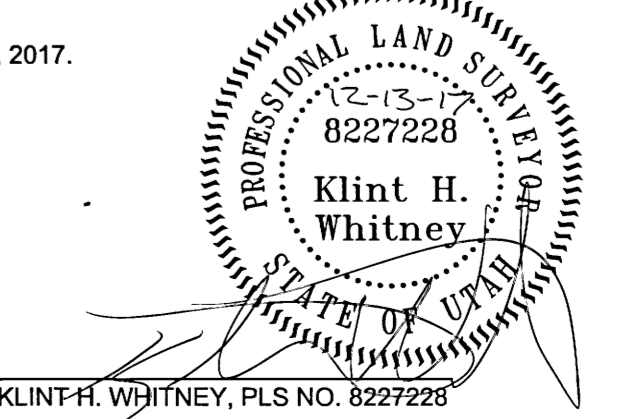

SCALE:	1:30 XREF
DATE:	10/19/17
DESIGN:	
DRAWN:	KHW
CHECKED:	KHW

RECEIVED
 OCT 13 2017
 BY: 5896

BOUNDARY COMBINATION FOR PARADIGM REAL ESTATE
 539 22ND STREET, OGDEN, UTAH
 LOCATED IN THE SOUTHWEST QUARTER OF SECTION 28,
 TOWNSHIP 6 NORTH, RANGE 1 WEST, S.L.B. AND M.

GARDNER ENGINEERING
 CIVIL - LAND PLANNING
 MUNICIPAL - LAND SURVEYING
 5100 SOUTH 375 EAST OGDEN, UT
 84143-4240 PH: 435-466-6066 FAX: 435-466-6066

CS

S1

1