

- LEGEND**
- Centerline
  - UGT— Buried Telephone line
  - OHT— Overhead Telephone line
  - OHP— Overhead Power line
  - UGP— Power line
  - S— Sanitary Sewer line
  - W— Culinary Water line
  - G— Gas line
  - SD— Storm Drain line
  - SW— Secondary Waterline
  - LD— Land Drain line
  - IW— Irrigation Waterline
  - X—X— Fence
  - Power Meter
  - Post
  - Water Meter
  - Gas Meter
  - Power Meter
  - Telephone Box
  - Sewer Manhole
  - Drain Manhole
  - Water Manhole
  - Cleanout Box
  - TA— Top of Asphalt
  - EA— Edge of Asphalt
  - NG— Natural Ground
  - LG— Lip of Gutter
  - SF— Service Pole
  - LP— Light Pole
  - PP— Power Pole
  - TP— Telephone Pole
  - FH— Fire Hydrant
  - DIT— Flowline of Ditch
  - TOS— Top of Slope
  - TOP— Top of Slope
  - CO— Cleanout
  - FC— Fence
  - Flowline
  - DMH— Drain Manhole
  - x99.00— Spot Elevation
  - Contour
  - Asphalt
  - Concrete
  - Building
  - Catch Basin
  - C.M.P.— Corrugated Metal Pipe
  - R.C.P.— Reinforced Concrete Pipe
  - CONC— Edge of Concrete
  - RWALL— Retaining Wall
  - SMH— Sewer Manhole
  - WV— Water Valve
  - CB— Catch Basin
  - DV— Diversion Box
  - TC— Top of Curb
  - SW— Sidewalk
  - GAS— Gas line Marker
  - GUY— Guy Wire
  - BLDG— Building Corner
  - Fire Hydrant
  - Natural Ground
  - Water Valve
  - Light Pole
  - Power Pole w/guy
  - Deciduous Tree
  - Coniferous Tree
  - ARP— Area Reference Plat
  - Building Columns
  - Landscaping

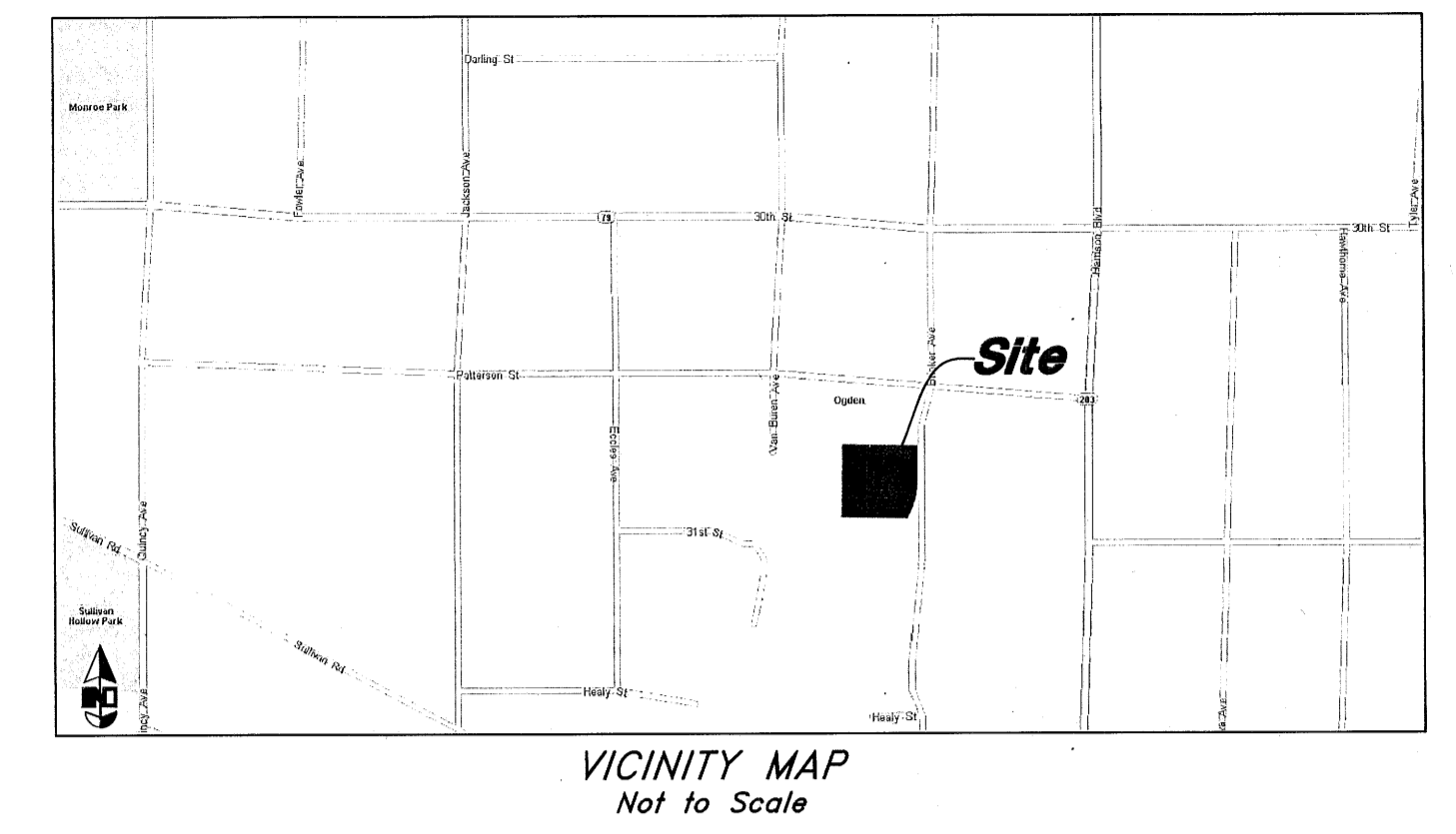
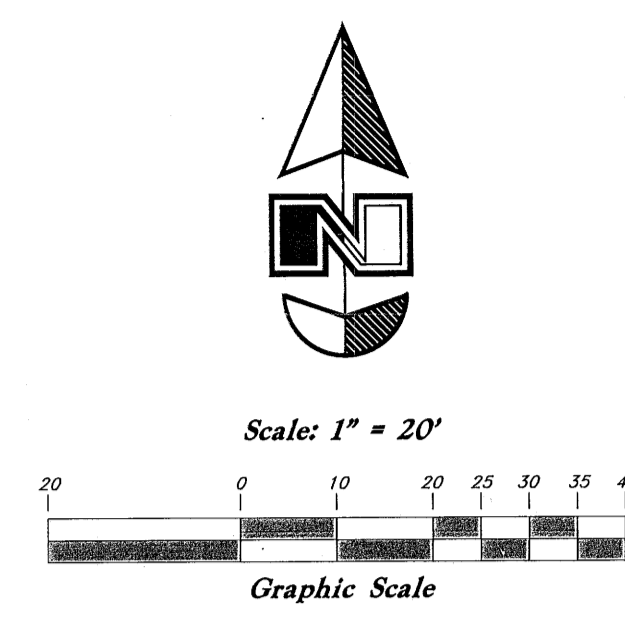

**NARRATIVE**

This Survey was requested by Ms. Lana Qadar for the purpose of establishing the Property Lines of this site.

A Line between Monuments found in the Intersections of Van Buren Avenue & Patterson Street and Brinker Avenue and Patterson Street with a bearing of South 89°02'00" East was used as the Basis of Bearings for this Survey.

Property Corners were set as depicted on this survey.

**RECORD DESCRIPTION**

ALL OF LOTS 7 TO 12, BLOCK 6, ILIFF COLLEGE HILL ADDITION, OGDEN CITY, WEBER COUNTY, UTAH; PLUS 1/2 OF VACATED ALLEY ABUTTING SAID LOTS ON THE WEST.

TOGETHER WITH 1/2 OF VACATED 31ST STREET ABUTTING ON THE SOUTH (1423-267), EXCEPT PART OF BLOCK 6, ILIFF COLLEGE HILL ADDITION, OF OGDEN CITY, WEBER COUNTY, UTAH:

BEGINNING AT THE SOUTHEAST CORNER OF SAID BLOCK 6, AND RUNNING THENCE NORTH 89°02' WEST 19.59 FEET, THENCE ALONG THE ARC OF A 135.78 FOOT RADIUS CURVE TO THE LEFT 73.87 FEET, THE LONG CHORD OF SAID CURVE BEARS NORTH 16°32'23" EAST 72.95 FEET, THENCE SOUTH 0°58' WEST 70.28 FEET TO THE POINT OF BEGINNING.

**AS-SURVEYED DESCRIPTION**

All of Lots 7 through 12, Block 6, Iliff College Hill Addition and the Easterly portion of the Vacated Alley Way to the West of said Lots 7 through 12, Ogden City, Weber County, Utah and a portion of the vacated Right of Way of 31st Street:

Beginning at a point on the Westerly Right of Way Line of Brinker Avenue and a found Rebar and Cap, said point being 183.88 feet South 0°58'00" East and 30.00 feet North 89°02'00" West from the Monument found in the Intersection of Brinker Avenue and Patterson Street, Ogden City, Weber County, Utah; and running thence along said Westerly Right of Way the following three (3) courses: (1) South 0°35'17" West 79.72 feet to a point of curvature, (2) Southwesterly along the arc of a 135.87 foot Radius curve to the right a distance of 83.00 feet (Central Angle equals 35°00'01" and Long Chord bears South 18°27'54" West 81.71 feet) to a point of reverse curvature and (3) Southwesterly along the arc of a 195.87 foot Radius curve to the left a distance of 37.24 feet (Central Angle equals 10°53'41" and Long Chord bears South 30°31'06" West 37.19 feet) to the Northerly Right of Way Line of Thirty-First Street; thence along said Northerly Right of Way Line North 89°02'00" West 112.74 feet to the Centerline of a Vacated Alley Way; thence along said Centerline North 1°01'54" East 190.00 feet to a found Rebar and Cap, said point being on the Southerly Line of Lot 6, Block 6, Iliff College Hill Addition extended; thence along said Southerly Line South 89°02'00" East 154.91 feet to the Westerly Right of Way Line of said Brinker Avenue and the Point of Beginning.

Contains 27,804 Sq. Ft. or 0.638 Acres

**SURVEYOR'S CERTIFICATE**

I, Andy Hubbard do hereby certify that I am a Professional Land Surveyor, and that I hold Certificate No. 6242920. In accordance with Title 58, Chapter 22, of the Professional Engineers and Surveyors Licensing Act, and I have made a survey of the above described property according to Section 17-23-17 and that the above plat correctly shows the true dimensions of the property surveyed.

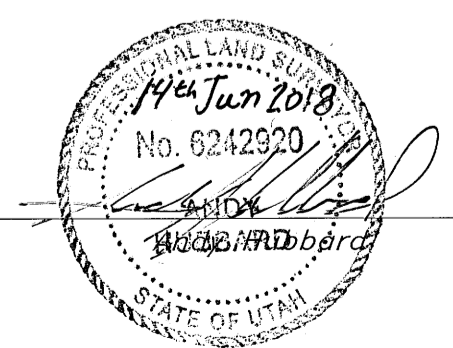

RECEIVED  
JUN 22 2018  
BY: 6032

**GREAT BASIN ENGINEERING**

5746 SOUTH 1475 EAST OGDEN, UTAH 84403  
MAIN (801)394-4515 S.L.C (801)392-7544  
WWW.GREATBASINENGINEERING.COM

**Record of Survey**

**Qadar - Ogden**

3083 Brinker Avenue Utah  
Ogden City, Weber County, Utah  
A part of Block 6, South Ogden Survey, Iliff College Hill Addition

9 May, 2018

SHEET NO. **1**

18N714 - ROS