

**BOUNDARY DESCRIPTION**

A PART OF LOT 1, BLOCK 3, PLAT B, BEGINNING AT A POINT ON THE WESTERLY RIGHT-OF-WAY LINE OF MONROE AVENUE, BEING LOCATED SOUTH 1°19'17" WEST 588.78 FEET ALONG A LINE BETWEEN THE OGDEN CITY CENTERLINE MONUMENT AT 26TH STREET AND MONROE AVENUE AND THE OGDEN CITY CENTERLINE MONUMENT AT 27TH STREET AND MONROE AVENUE AND NORTH 90°00'00" WEST 49.51 FEET FROM THE OGDEN CITY CENTERLINE MONUMENT AT 26TH STREET AND MONROE AVENUE; RUNNING THENCE ALONG SAID RIGHT-OF-WAY LINE SOUTH 1°19'17" WEST 37.50 FEET THENCE NORTH 88°40'43" WEST 157.00 FEET; THENCE NORTH 1°19'17" EAST 37.50 FEET; THENCE SOUTH 88°40'43" EAST 157.00 FEET TO THE POINT OF BEGINNING. CONTAINING: 5888 SQ FT OR 0.14 AC MORE OR LESS.

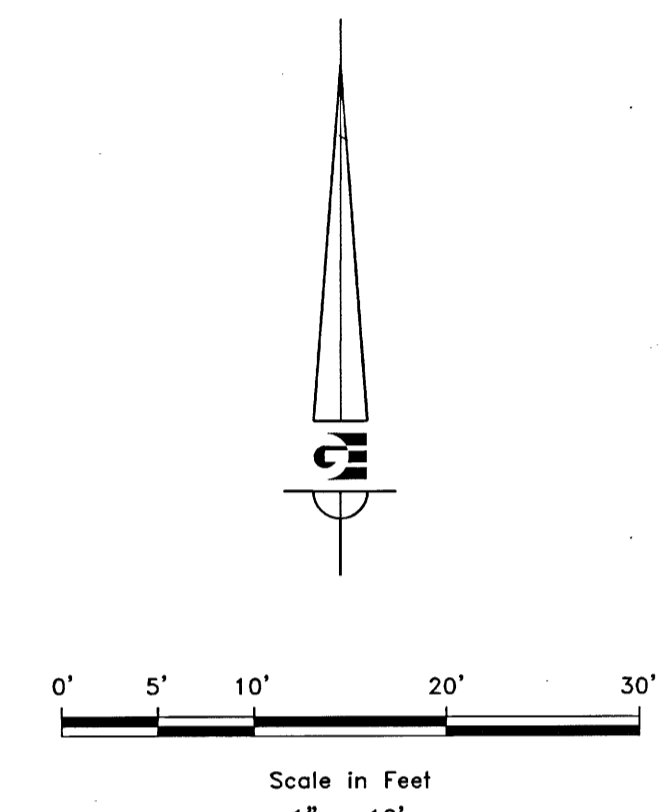

- LEGEND**
- ◆ OGDEN CITY MONUMENT AS NOTED
  - SET 24" REBAR AND CAP MARKED GARDNER ENGINEERING
  - BOUNDARY
  - - - CENTERLINE
  - - - ADJACENT PARCEL
  - - - SECTION LINE
  - - - EASEMENT
  - - - EXISTING FENCE LINE

**NARRATIVE**

THE PURPOSE OF THE SURVEY WAS TO ESTABLISH THE BOUNDARY LINES OF PARCEL #010500005 AS SHOWN AND DESCRIBED HEREON. THE SURVEY WAS ORDERED BY BRYCE CLARK. THE CONTROL USED TO ESTABLISH THE BOUNDARY WAS THE EXISTING OGDEN CITY SURVEY MONUMENTATION AS SHOWN AND NOTED HEREON, AS WELL AS WARRANTY DEED #2888226. THE BASIS OF BEARING IS THE LINE BETWEEN THE OGDEN THE OGDEN CITY CENTERLINE MONUMENT AT 26TH STREET AND MONROE AVENUE WHICH BEARS SOUTH 1°19'17" WEST, UTAH NORTH, NAD 83, STATE PLANE GRID BEARING.

**SURVEYOR'S CERTIFICATE**

I, KLINT H. WHITNEY, DO HEREBY CERTIFY THAT I AM A LICENSED PROFESSIONAL LAND SURVEYOR IN THE STATE OF UTAH AND THAT I HOLD CERTIFICATE NO. 8227228 IN ACCORDANCE WITH TITLE 58, CHAPTER 22, OF THE PROFESSIONAL ENGINEERS AND LAND SURVEYORS ACT. I FURTHER CERTIFY THAT BY AUTHORITY OF THE OWNERS I HAVE COMPLETED A SURVEY OF THE PROPERTY DESCRIBED ON THIS RECORD OF SURVEY PLAT IN ACCORDANCE WITH SECTION 17-23-20 AND HAVE VERIFIED ALL MEASUREMENTS. THAT THE REFERENCE MONUMENTS SHOWN ON THIS RECORD OF SURVEY PLAT ARE LOCATED AS INDICATED AND ARE SUFFICIENT TO RETRACE OR REESTABLISH THIS SURVEY; AND THAT THE INFORMATION SHOWN HEREIN IS SUFFICIENT TO ACCURATELY ESTABLISH THE LATERAL BOUNDARIES OF THE HEREIN DESCRIBED TRACT OF REAL PROPERTY.

SIGNED THIS 28<sup>TH</sup> DAY OF JUNE, 2018.

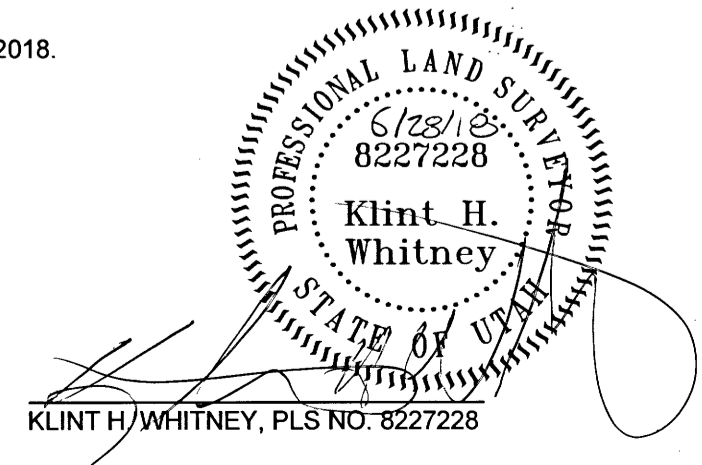

SCALE:	1:10 XREF
DATE:	1/15/18
DESIGN:	
DRAWN:	KHW
CHECKED:	KHW
DWG. NO.:	R-2001-NBC SURVEY 1746 - BRYCE CLARK SURVEY 010500005

**RECEIVED**

JUN 28 2018

BY: 6039

**BOUNDARY SURVEY FOR BRYCE CLARK**  
**2669 MONROE BLVD, OGDEN UTAH**  
**LOCATED IN THE NORTHWEST QUARTER OF SECTION 33**  
**TOWNSHIP 6 NORTH, RANGE 1 WEST, S.L.B. AND M.**

**GARDNER ENGINEERING**  
 CIVIL - LAND PLANNING  
 MUNICIPAL - LAND SURVEYING  
 5150 SOUTH 575 EAST OGDEN, UT  
 84143-6066 FAX 801-476-0066

**S1**  
**1**