

DURFEE CREEK ESTATES
HOME OWNERS ASSOCIATION
172230001

GLEESON ALLEMANN FAMILY TRUST
172250014

LOT 48
PARCEL 172250015
6825 NORTH 2050 EAST
1.19 ACRES

STEVEN & DIANNE SANDERS
172250001

RONALD & LEISA FIRTH
172250002

FOUND SOUTHWEST COR
SEC. 36, T8N, R1W SLB&M

S88°54'53"W 1463.87 (BASIS OF BEARING)

BOUNDARY DESCRIPTION

ALL OF LOT 48, DURFEE CREEK ESTATES NO. 2.

DETAIL 01
SCALE: 1"=1'

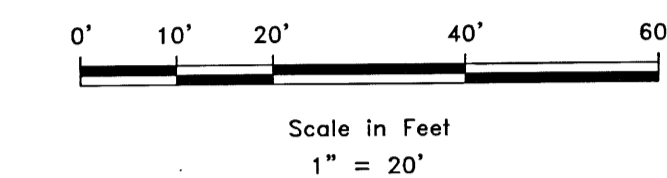
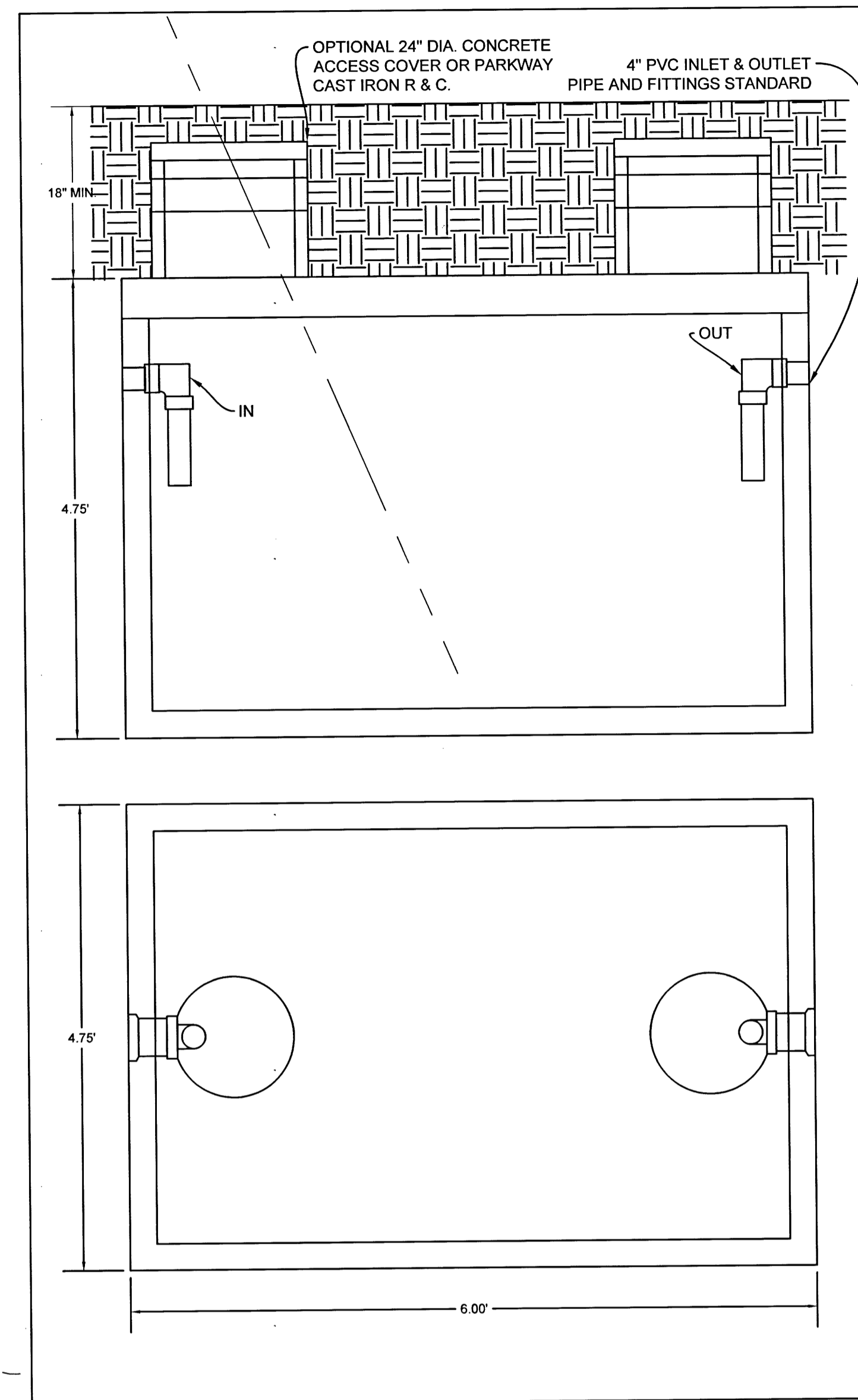

LEGEND

- WEBER COUNTY MONUMENT AS NOTED
- SET 24" REBAR AND CAP MARKED GARDNER ENGINEERING
- SUBDIVISION BOUNDARY
- LOT LINE
- ADJACENT PARCEL
- SECTION LINE
- EASEMENT
- EXISTING FENCE LINE
- COMM BOX
- POWER BOX
- WATER METER
- EXISTING ROCK WALL
- EXISTING CONTOURS
- EXISTING SANITARY SEWER LINE
- EXISTING WATER LINE

NOTES

1. ZONE F-5 CURRENT YARD SETBACKS: 30' REAR / 30' FRONT / 20' MIN.
2. SUBJECT PROPERTY FALLS WITHIN FEMA FLOOD ZONE "X" - AREAS DETERMINED TO BE OUTSIDE THE 0.2% ANNUAL CHANCE FLOODPLAIN, PER FEMA MAP NO. 49057C0019F WITH AN EFFECTIVE DATE OF JUNE 02, 2015.

NARRATIVE

THE PURPOSE OF THE SURVEY WAS TO ESTABLISH THE BOUNDARY OF PARCEL 172250015 AND CONDUCT A TOPOGRAPHIC SURVEY. THE SURVEY WAS ORDERED BY BRETT HATCH, THE DEDICATED PLAT OF DURFEE CREEK PHASE 2 WAS USED TO ESTABLISH THE BOUNDARY AS WELL AS FOUND REBAR WITHIN THE DURFEE DEVELOPMENT AS SHOWN AND NOTED HEREON. THE CONTROL USED TO ESTABLISH THE BOUNDARY WAS THE EXISTING WEBER COUNTY SURVEY MONUMENTATION AS SHOWN AND NOTED HEREON. THE BASIS OF BEARING IS THE SOUTH LINE OF THE SOUTHEAST QUARTER OF SECTION 36, TOWNSHIP 8 NORTH, RANGE 1 WEST, OF THE SALT LAKE BASE AND MERIDIAN WHICH BEARS SOUTH 88°54'53" WEST WEBER COUNTY, UTAH NORTH NAD 83 STATE PLANE GRID BEARING. VERTICAL DATUM IS NAVD 88.

SURVEYOR'S CERTIFICATE

I, KLINT H. WHITNEY, DO HEREBY CERTIFY THAT I AM A LICENSED PROFESSIONAL LAND SURVEYOR IN THE STATE OF UTAH AND THAT I HOLD CERTIFICATE NO. 8227228 IN ACCORDANCE WITH TITLE 58, CHAPTER 22, OF THE PROFESSIONAL ENGINEERS AND LAND SURVEYORS ACT; I FURTHER CERTIFY THAT BY AUTHORITY OF THE OWNERS I HAVE COMPLETED A SURVEY OF THE PROPERTY DESCRIBED ON THIS RECORD OF SURVEY PLAT IN ACCORDANCE WITH SECTION 17-23-20 AND HAVE VERIFIED ALL MEASUREMENTS; THAT THE REFERENCE MONUMENTS SHOWN ON THIS RECORD OF SURVEY PLAT ARE LOCATED AS INDICATED AND ARE SUFFICIENT TO RETRACE OR REESTABLISH THIS SURVEY; AND THAT THE INFORMATION SHOWN HEREIN IS SUFFICIENT TO ACCURATELY ESTABLISH THE LATERAL BOUNDARIES OF THE HEREIN DESCRIBED TRACT OF REAL PROPERTY.

SIGNED THIS 25 DAY OF JUNE, 2018.

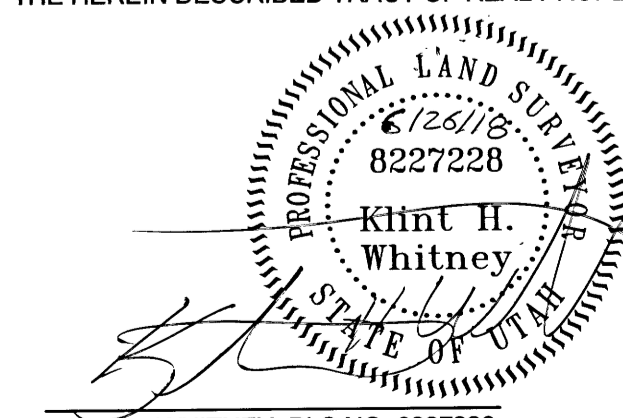

REVISIONS	DESCRIPTION
DATE	

SCALE: 1"=20'
DATE: 4/16/15
DESIGN: _____
DRAWN: MJL
CHECKED: KHW
DWG. NO.: 172250015 - BRETT HATCH SURVEYING

PROPERTY SURVEY FOR BRETT HATCH
6825 NORTH 2050 EAST
LOCATED IN THE EAST HALF OF SECTION 36,
TOWNSHIP 8 NORTH, RANGE 1 WEST, S.L.B. AND M.

GARDNER ENGINEERING
CIVIL - LAND PLANNING
MUNICIPAL - LAND SURVEYING
5150 SOUTH 875 EAST GARDEN, UT
OFFICE: 801-426-0202 FAX: 801-426-0006

S1
1