

PARCEL "A" BOUNDARY DESCRIPTION

A PART OF LOT 4 "PLAT OF SECTION 36" LOCATED IN THE SOUTHWEST QUARTER OF SECTION 36, TOWNSHIP 7 NORTH, RANGE 3 WEST, SALT LAKE BASE AND MERIDIAN. BEGINNING AT A POINT ON THE WEST LINE OF SAID LOT 4 ALSO BEING ON THE WEST LINE OF THE SOUTHWEST QUARTER OF SAID SECTION 36 BEING LOCATED NORTH 00°11'27" EAST 2224.94 FEET ALONG SAID WEST LINE FROM THE SOUTHWEST CORNER OF SAID SECTION; RUNNING THENCE ALONG SAID WEST LINE NORTH 00°11'27" EAST 150.00 FEET; THENCE SOUTH 89°48'33" EAST 373.75 FEET; THENCE SOUTH 00°04'35" WEST 386.11 FEET TO THE SOUTH LINE OF SAID LOT 4; THENCE ALONG SAID SOUTH LINE NORTH 89°54'17" WEST 168.32 FEET; THENCE NORTH 00°11'27" EAST 214.50 FEET; THENCE NORTH 89°17'05" WEST 206.17 FEET TO THE POINT OF BEGINNING. CONTAINING 92,634 SQUARE FEET.

PARCEL "190570006" BOUNDARY DESCRIPTION

A PART OF LOT 4 "PLAT OF SECTION 36" LOCATED IN THE SOUTHWEST QUARTER OF SECTION 36, TOWNSHIP 7 NORTH, RANGE 3 WEST, SALT LAKE BASE AND MERIDIAN. BEGINNING AT A POINT ON THE WEST LINE OF SAID LOT 4 ALSO BEING ON THE WEST LINE OF THE SOUTHWEST QUARTER OF SAID SECTION 36 BEING LOCATED NORTH 00°11'27" EAST 2374.94 FEET ALONG SAID WEST LINE FROM THE SOUTHWEST CORNER OF SAID SECTION; RUNNING THENCE ALONG SAID WEST LINE NORTH 00°11'27" EAST 240.49 FEET TO THE WEST QUARTER CORNER OF SAID SECTION 36; THENCE ALONG THE WEST LINE OF THE NORTHWEST QUARTER OF SAID SECTION 36 NORTH 00°11'22" EAST 2615.63 FEET TO THE NORTH LINE OF SAID LOT 4 ALSO BEING THE NORTH LINE OF SAID NORTHWEST QUARTER; THENCE ALONG SAID NORTH LINE SOUTH 89°38'16" EAST 677.40 FEET TO THE EAST LINE OF SAID LOT 4; THENCE ALONG SAID EAST LINE SOUTH 00°11'24" WEST 3218.59 FEET TO THE SOUTH LINE OF SAID LOT 4; THENCE ALONG THE SOUTH LINE OF SAID LOT 4 SOUTH 89°53'11" WEST 302.89 FEET; THENCE NORTH 00°04'35" EAST 366.11 FEET; THENCE NORTH 89°48'33" EAST 373.75 FEET TO THE POINT OF BEGINNING. CONTAINING 46,942 ACRES.

NARRATIVE

THE PURPOSE OF THIS SURVEY WAS TO PROVIDE A DESCRIPTION AND SET THE PROPERTY CORNERS FOR A FUTURE 2 ACRE LOT. ADDITIONAL SQUARE FOOTAGE IN THE DESCRIBED PARCEL "A" IS FOR THE PURPOSE OF FUTURE ROADWAY DEDICATION AT THE TIME OF SUBDIVIDING. THE SURVEY WAS ORDERED BY TAYLOR ANDERSON. THE BASIS OF BEARING IS THE WEST LINE OF THE SOUTHWEST QUARTER OF SECTION 36, TOWNSHIP 7 NORTH, RANGE 3 WEST, OF THE SALT LAKE BASE AND MERIDIAN WHICH BEARS NORTH 00°11'27" EAST WEBER COUNTY, UTAH NORTH, NAD 83 STATE PLANE GRID BEARING. WARRANTY DEED RECORDED AS ENTRY NUMBER 2915375, DEEDS OF ADJOINING PROPERTIES, THE PLAT OF SECTION 36 BOOK 6 PAGE 71 AND EXISTING FENCE LINES WERE USED TO DETERMINE BOUNDARY LOCATION.

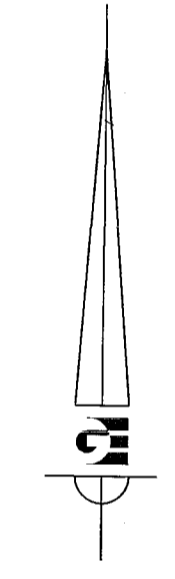

LEGEND

- ◆ WEBER COUNTY MONUMENT AS NOTED
- SET 24" REBAR AND CAP MARKED GARDNER ENGINEERING
- SUBDIVISION BOUNDARY
- LOT LINE
- - - ADJACENT PARCEL
- - - SECTION LINE
- - - EASEMENT
- - - EXISTING FENCE LINE

SURVEYOR'S CERTIFICATE

I, KLINT H. WHITNEY, DO HEREBY CERTIFY THAT I AM A LICENSED PROFESSIONAL LAND SURVEYOR IN THE STATE OF UTAH AND THAT I HOLD CERTIFICATE NO. 8227228 IN ACCORDANCE WITH TITLE 58, CHAPTER 22, OF THE PROFESSIONAL ENGINEERS AND LAND SURVEYORS ACT; I FURTHER CERTIFY THAT BY AUTHORITY OF THE OWNERS I HAVE COMPLETED A SURVEY OF THE PROPERTY DESCRIBED ON THIS RECORD OF SURVEY PLAT IN ACCORDANCE WITH SECTION 17-23-20 AND HAVE VERIFIED ALL MEASUREMENTS; THAT THE REFERENCE MONUMENTS SHOWN ON THIS RECORD OF SURVEY PLAT ARE LOCATED AS INDICATED AND ARE SUFFICIENT TO RETRACE OR REESTABLISH THIS SURVEY; AND THAT THE INFORMATION SHOWN HEREIN IS SUFFICIENT TO ACCURATELY ESTABLISH THE LATERAL BOUNDARIES OF THE HEREIN DESCRIBED TRACT OF REAL PROPERTY.

SIGNED THIS 12TH DAY OF SEPTEMBER, 2018.

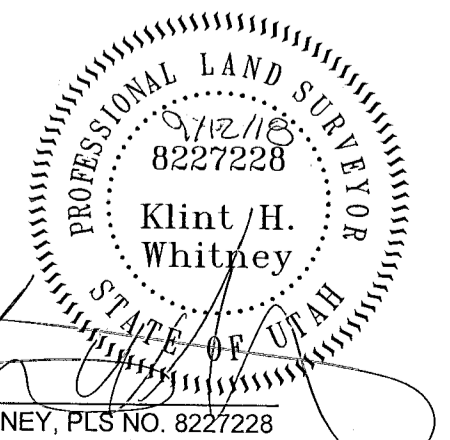

RECEIVED
OCT 24 2018
BY: 6129

SCALE: 1:100 XREF	DATE: 9/4/18	DESIGN: _____	DRAWN: KHW	CHECKED: KHW
REVISIONS	DATE	DESCRIPTION		

PROPERTY SURVEY FOR TAYLOR ANDERSON
+/- 2200 NORTH 6700 WEST, WEBER COUNTY, UTAH
LOCATED IN THE WEST HALF OF SECTION 36,
TOWNSHIP 7 NORTH, RANGE 3 WEST, S.L.B. AND M.

GARDNER ENGINEERING
CIVIL - LAND PLANNING
MUNICIPAL - LAND SURVEYING
5150 SOUTH 375 EAST OGDEN, UT
OFFICE: 801-476-0202 FAX: 801-476-0066