

**BOUNDARY DESCRIPTION**

**PARCEL A**  
 A PART OF THE SOUTHEAST QUARTER OF SECTION 32, TOWNSHIP 7 NORTH, RANGE 2 WEST, OF THE SALT LAKE BASE AND MERIDIAN. BEGINNING AT A POINT BEING LOCATED NORTH 89°24'00" WEST 410.83 FEET FROM AND NORTH 0°00'00" EAST 344.10 FEET FROM THE SOUTHEAST CORNER OF SAID SECTION 32. RUNNING THENCE NORTH 88°18'43" WEST 110.0 FEET; THENCE NORTH 1°41'17" EAST 216.78 FEET TO THE SOUTH RIGHT OF WAY LINE OF 1975 NORTH STREET; THENCE ALONG SAID SOUTH RIGHT OF WAY SOUTH 88°19'40" EAST 110.00 FEET; THENCE SOUTH 1°41'17" WEST 216.81 FEET TO THE POINT OF BEGINNING. CONTAINING 0.55 ACRES.

**REMAINDER PARCEL**  
 A PART OF THE SOUTHEAST QUARTER OF SECTION 32, TOWNSHIP 7 NORTH, RANGE 2 WEST, AND THE NORTHEAST QUARTER OF SECTION 5, TOWNSHIP 6 NORTH, RANGE 2 WEST, OF THE SALT LAKE BASE AND MERIDIAN. BEGINNING AT A POINT ON THE SOUTH LINE OF SAID SOUTHEAST QUARTER BEING LOCATED NORTH 89°24'00" WEST 312.04 FEET FROM THE SOUTHEAST CORNER OF SAID SECTION 28. RUNNING THENCE SOUTH 1°07'25" WEST 491.00 FEET; THENCE NORTH 88°58'01" WEST 144.45 FEET; THENCE NORTH 1°50'15" EAST 341.98 FEET; THENCE NORTH 89°15'53" WEST 61.57 FEET; THENCE NORTH 0°48'54" EAST 115.45 FEET; THENCE NORTH 26°00'16" WEST 36.30 FEET; THENCE NORTH 1°41'17" EAST 346.17 FEET; THENCE SOUTH 88°18'43" EAST 110.00 FEET; THENCE NORTH 1°41'17" EAST 216.81 FEET TO THE SOUTH RIGHT OF WAY LINE OF 1975 NORTH STREET; THENCE ALONG SAID RIGHT OF WAY SOUTH 88°19'40" EAST 104.10 FEET; THENCE SOUTH 1°11'44" WEST 558.94 FEET TO THE POINT OF BEGINNING. CONTAINING 4.05 ACRES.

**PARCEL C**  
 A PART OF THE NORTHEAST QUARTER OF SECTION 5, TOWNSHIP 6 NORTH, RANGE 2 WEST, OF THE SALT LAKE BASE AND MERIDIAN. BEGINNING AT A POINT ON THE NORTH LINE OF THE NORTHEAST QUARTER OF SAID SECTION 5. SAID POINT BEING LOCATED NORTH 89°24'00" WEST 530.98 FEET FROM THE NORTHEAST CORNER OF SAID SECTION 5. RUNNING THENCE SOUTH 26°00'16" EAST 36.30 FEET; THENCE SOUTH 0°48'54" WEST 115.45 FEET; THENCE NORTH 89°15'53" WEST 103.53 FEET TO THE EAST RIGHT OF WAY LINE OF 4425 WEST STREET; THENCE ALONG SAID RIGHT OF WAY THE FOLLOWING TWO COURSES: (1) ALONG THE ARC OF A 167.50 FOOT RADIUS CURVE TO THE NORTH 158.75 FEET, HAVING A CENTRAL ANGLE OF 54°18'06" CHORD BEARS NORTH 25°18'45" WEST 152.87 FEET; (2) NORTH 52°27'48" WEST 16.83 FEET; THENCE SOUTH 89°24'59" EAST 167.96 FEET TO THE POINT OF BEGINNING. CONTAINING 0.42 ACRES.

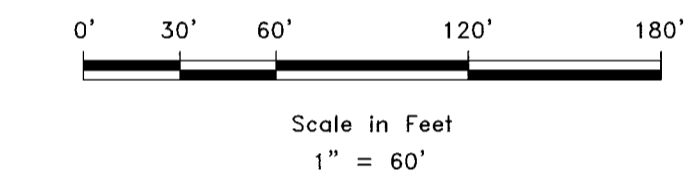
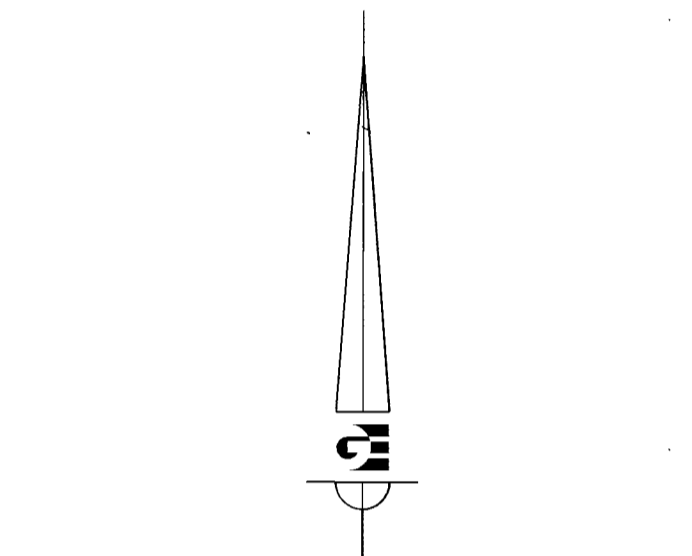

- LEGEND**
- ◆ WEBER COUNTY MONUMENT AS NOTED
  - SET 2" REBAR AND CAP MARKED GARDNER ENGINEERING
  - SUBDIVISION BOUNDARY
  - LOT LINE
  - - - ADJACENT PARCEL
  - SECTION LINE
  - - - EXISTING FENCE LINE

**NARRATIVE**

THE PURPOSE OF THE SURVEY WAS TO DO A BOUNDARY ADJUSTMENT FOR THE PROPERTIES SHOWN AND DESCRIBED HEREON. THE SURVEY WAS ORDERED BY JEFF HALES. THE CONTROL USED TO ESTABLISH THE BOUNDARY WAS THE EXISTING WEBER COUNTY SURVEY MONUMENTATION AS SHOWN AND NOTED HEREON. THE BASIS OF BEARING IS THE NORTH LINE OF THE NORTHEAST QUARTER OF SECTION 5, TOWNSHIP 6 NORTH, RANGE 2 WEST, OF THE SALT LAKE BASE AND MERIDIAN WHICH BEARS NORTH 89°24'00" WEST WEBER COUNTY GRID BEARING. THE DEDICATED PLAT OF THE JENKINS SUBDIVISION, RECORDED AS ENTRY NUMBER 1620274, PAGE 20, BOOK 55, AND THE WARRANTY DEED, RECORDED AS ENTRY NUMBER 2890830, WERE USED TO DETERMINE OWNERSHIP.

**SURVEYOR'S CERTIFICATE**

I, KLINT H. WHITNEY, DO HEREBY CERTIFY THAT I AM A LICENSED PROFESSIONAL LAND SURVEYOR IN THE STATE OF UTAH AND THAT I HOLD CERTIFICATE NO. 8227228 IN ACCORDANCE WITH TITLE 58, CHAPTER 22, OF THE PROFESSIONAL ENGINEERS AND LAND SURVEYORS ACT. I FURTHER CERTIFY THAT BY AUTHORITY OF THE OWNERS I HAVE COMPLETED A SURVEY OF THE PROPERTY DESCRIBED ON THIS RECORD OF SURVEY PLAT IN ACCORDANCE WITH SECTION 17-23-20 AND HAVE VERIFIED ALL MEASUREMENTS; THAT THE REFERENCE MONUMENTS SHOWN ON THIS RECORD OF SURVEY PLAT ARE LOCATED AS INDICATED AND ARE SUFFICIENT TO RETRACE OR REESTABLISH THIS SURVEY; AND THAT THE INFORMATION SHOWN HEREIN IS SUFFICIENT TO ACCURATELY ESTABLISH THE LATERAL BOUNDARIES OF THE HEREIN DESCRIBED TRACT OF REAL PROPERTY.

SIGNED THIS 6<sup>th</sup> DAY OF September 2019.

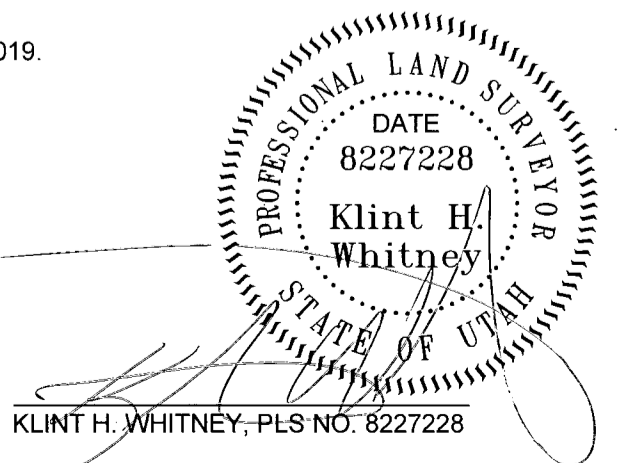

RECEIVED  
 SEP 06 2019  
 BY: 6339

SCALE: 1" = 60'
DATE: 8/2/19
DESIGN: JTN
DRAWN: JTN
CHECKED: KHW
DWG. NO.: 191901-001-001-001-001-001

REVISIONS	DATE	DESCRIPTION

**BOUNDARY ADJUSTMENT SURVEY FOR JENKINS FAMILY**  
 +/- 4425 WEST 1975 NORTH, PLAIN CITY, UTAH  
 LOCATED IN THE SOUTHEAST QUARTER OF SECTION 32,  
 TOWNSHIP 7 NORTH, RANGE 2 WEST, S.L.B. AND M.

**GARDNER ENGINEERING**  
 CIVIL, LAND PLANNING  
 MUNICIPAL, LAND SURVEYING  
 5150 SOUTH 375 EAST OGDEN, UT  
 OFFICE: 801-476-0202 FAX: 801-476-0066

S1  
 1