

RECORD PARCEL 240510008 BOUNDARY DESCRIPTION
 PART OF THE NORTH 1/2 OF THE NORTH 1/2 OF LOT 31, PLAT B, PLAIN CITY SURVEY, WEBER COUNTY, UTAH, BEGINNING AT A POINT 150 FEET EAST OF THE NORTHWEST CORNER OF SAID LOT 31, THENCE EAST 188.95 FEET, MORE OR LESS, TO THE EAST LINE OF SAID LOT 31, THENCE SOUTH 165 FEET, THENCE WEST 334 FEET, MORE OR LESS, TO THE EAST LINE OF 4275 WEST STREET, THENCE NORTH 65 FEET, THENCE EAST 150 FEET, THENCE NORTH 100 FEET TO THE POINT OF BEGINNING.

RECORD PARCEL 240510007 BOUNDARY DESCRIPTION
 THE SOUTH 1/2 OF THE NORTH 1/2 OF LOT 31, PLAT B, PLAIN CITY SURVEY, WEBER COUNTY, UTAH.

AS SURVEYED ADJUSTED 240510008 BOUNDARY DESCRIPTION
 A PART OF THE WEST HALF OF SECTION 33, TOWNSHIP 7 NORTH, RANGE 2 WEST, OF THE SALT LAKE BASE AND MERIDIAN ALSO A PART OF LOT 31, PLAT B, PLAIN CITY SURVEY, BEGINNING AT A POINT ON THE EAST RIGHT-OF-WAY LINE OF 4275 WEST BEING LOCATED NORTH 00°41'59" EAST 2560.82 FEET ALONG THE WEST LINE OF SAID SECTION 33 AND NORTH 90°00'00" EAST 233.61 FEET FROM THE SOUTHWEST CORNER OF SAID SECTION 33; RUNNING THENCE ALONG SAID EAST RIGHT-OF-WAY LINE NORTH 01°02'02" EAST 29.81 FEET; THENCE SOUTH 88°57'58" EAST 150.00 FEET; THENCE NORTH 01°02'02" EAST 100.00 FEET TO THE NORTH LINE OF SAID LOT 31; THENCE ALONG THE NORTH LINE OF SAID LOT 31 SOUTH 88°57'58" EAST 187.74 FEET TO THE EAST LINE OF SAID LOT 31; THENCE ALONG THE EAST LINE OF SAID LOT 31 SOUTH 01°13'44" WEST 129.77 FEET; THENCE NORTH 88°58'27" WEST 337.29 FEET TO THE POINT OF BEGINNING. CONTAINING 0.661 ACRES.

AS SURVEYED ADJUSTED 240510008 BOUNDARY DESCRIPTION
 A PART OF THE SOUTHWEST QUARTER OF SECTION 33, TOWNSHIP 7 NORTH, RANGE 2 WEST, OF THE SALT LAKE BASE AND MERIDIAN ALSO A PART OF LOT 31, PLAT B, PLAIN CITY SURVEY, BEGINNING AT A POINT ON THE EAST RIGHT-OF-WAY LINE OF 4275 WEST BEING LOCATED NORTH 00°41'59" EAST 2560.82 FEET ALONG THE WEST LINE OF SAID SECTION 33 AND NORTH 90°00'00" EAST 233.61 FEET FROM THE SOUTHWEST CORNER OF SAID SECTION 33; RUNNING THENCE SOUTH 88°58'27" EAST 337.29 FEET TO THE EAST LINE OF SAID LOT 31; THENCE ALONG THE EAST LINE OF SAID LOT 31 SOUTH 01°13'44" WEST 200.24 FEET; THENCE NORTH 88°57'58" WEST 336.61 FEET TO SAID EAST RIGHT-OF-WAY LINE; THENCE ALONG SAID EAST RIGHT-OF-WAY LINE NORTH 01°02'02" EAST 200.19 FEET TO THE POINT OF BEGINNING. CONTAINING 1.549 ACRES.

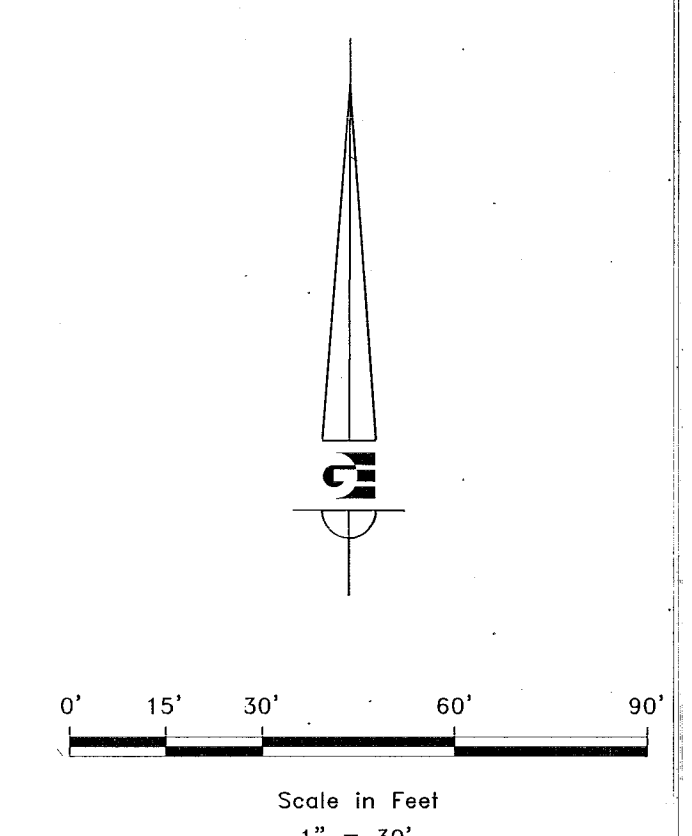

- LEGEND**
- ◆ WEBER COUNTY MONUMENT AS NOTED
 - SET 24" REBAR AND CAP MARKED GARDNER ENGINEERING
 - SUBDIVISION BOUNDARY
 - LOT LINE
 - - - ADJACENT PARCEL
 - - - SECTION LINE
 - - - EASEMENT
 - - - EXISTING FENCE LINE

NARRATIVE

THE PURPOSE OF THIS SURVEY WAS TO ADJUST AND SET THE PROPERTY CORNERS OF THE PARCEL AS SHOWN AND DESCRIBED HEREON. THE SURVEY WAS ORDERED BY BECKI WESTERGARD. THE BASIS OF BEARING IS THE WEST LINE OF SECTION 33, TOWNSHIP 7 NORTH, RANGE 2 WEST S.L.B.&M., WHICH BEARS NORTH 00°41'59" EAST, WEBER COUNTY, UTAH NORTH, NAD 83 STATE PLANE GRID BEARING. THE BOUNDARY WAS DETERMINED BY QUIT CLAIM DEED RECORDED AS ENTRY NUMBER 2684398 AND WARRANTY DEED RECORDED AS ENTRY NUMBER 2684687, AND DEEDS OF ADJOINING PROPERTY OWNERS. THE DEDICATED PLATS OF PLAIN CITY TOWNSHIP RECORDED AT BOOK 05 PAGE 080 WAS ALSO USED TO DETERMINE BOUNDARY LOCATION ALONG WITH THE FOUND MONUMENTS AS SHOWN AND DESCRIBED HEREON.

SURVEYOR'S CERTIFICATE

I, KLINT H. WHITNEY, DO HEREBY CERTIFY THAT I AM A LICENSED PROFESSIONAL LAND SURVEYOR IN THE STATE OF UTAH AND THAT I HOLD CERTIFICATE NO. 8227228 IN ACCORDANCE WITH TITLE 58, CHAPTER 22, OF THE PROFESSIONAL ENGINEERS AND LAND SURVEYORS ACT; I FURTHER CERTIFY THAT BY AUTHORITY OF THE OWNERS I HAVE COMPLETED A SURVEY OF THE PROPERTY DESCRIBED ON THIS RECORD OF SURVEY PLAT IN ACCORDANCE WITH SECTION 17-23-20 AND HAVE VERIFIED ALL MEASUREMENTS; THAT THE REFERENCE MONUMENTS SHOWN ON THIS RECORD OF SURVEY PLAT ARE LOCATED AS INDICATED AND ARE SUFFICIENT TO RETRACE OR REESTABLISH THIS SURVEY; AND THAT THE INFORMATION SHOWN HEREIN IS SUFFICIENT TO ACCURATELY ESTABLISH THE LATERAL BOUNDARIES OF THE HEREIN DESCRIBED TRACT OF REAL PROPERTY.

SIGNED THIS 15TH DAY OF JANUARY, 2020.

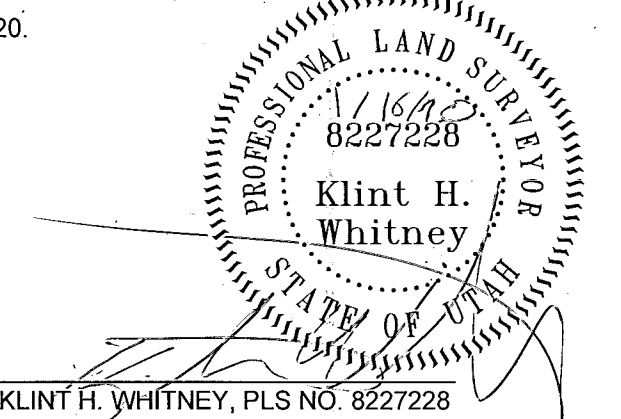

SCALE: 1:30 XREF	DATE: 11/1/19	DESIGN: KHW	DRAWN: KHW	CHECKED: KHW
REVISIONS	DESCRIPTION	DATE		

RECEIVED
 JAN 16 2020
 BY: 6407

BOUNDARY ADJUSTMENT SURVEY FOR BECKI WESTERGARD
 2274 AND 2280 NORTH 4275 WEST, PLAIN CITY, UTAH
 LOCATED IN THE WEST HALF OF SECTION 33,
 TOWNSHIP 7 NORTH, RANGE 2 WEST, S.L.B. AND M.

GARDNER ENGINEERING
 CIVIL LAND PLANNING
 MUNICIPAL LAND SURVEYING
 5150 SOUTH 375 EAST OGDEN, UT
 OFFICE: 801-476-0202 FAX: 801-476-0066

S1
 1