

**AS-SURVEYED BOUNDARY DESCRIPTION**

A PART OF THE NORTHWEST QUARTER OF SECTION 4, TOWNSHIP 6 NORTH, RANGE 1 WEST, OF THE SALT LAKE BASE AND MERIDIAN. BEGINNING AT THE SOUTHEAST CORNER OF THE BABCOCK CIRCLE SUBDIVISION (SAID POINT DESCRIBED OF RECORD AS BEING 1520.8 FEET WEST AND 982.99 FEET, MORE OR LESS SOUTH OF THE NORTHEAST CORNER OF SAID QUARTER SECTION) SAID POINT BEING LOCATED BY SURVEY NORTH 89°41'33" WEST 1523.37 FEET AND SOUTH 01°06'02" WEST 963.00 FEET FROM THE NORTH QUARTER CORNER OF SAID SECTION 4 (BASIS OF BEARING BEING THE NORTH LINE OF THE NORTHEAST QUARTER OF SAID SECTION 4 NORTH 89°42'01" WEST WEBER COUNTY, UTAH NORTH, NAD 83 STATE PLANE GRID BEARING); RUNNING THENCE SOUTH 01°05'56" WEST (SOUTH BY RECORD) 123.01 FEET, THENCE NORTH 88°54'04" WEST 160.91 FEET (WEST 164.00 FEET BY RECORD); THENCE NORTH 00°29'43" EAST 121.79 FEET (NORTH 123.01 FEET BY RECORD) TO THE SOUTH LINE OF SAID BABCOCK CIRCLE SUBDIVISION; THENCE ALONG THE SOUTH LINE OF SAID BABCOCK CIRCLE SUBDIVISION SOUTH 89°20'10" EAST 162.20 FEET TO THE POINT OF BEGINNING. CONTAINING 19,774 SQUARE FEET.

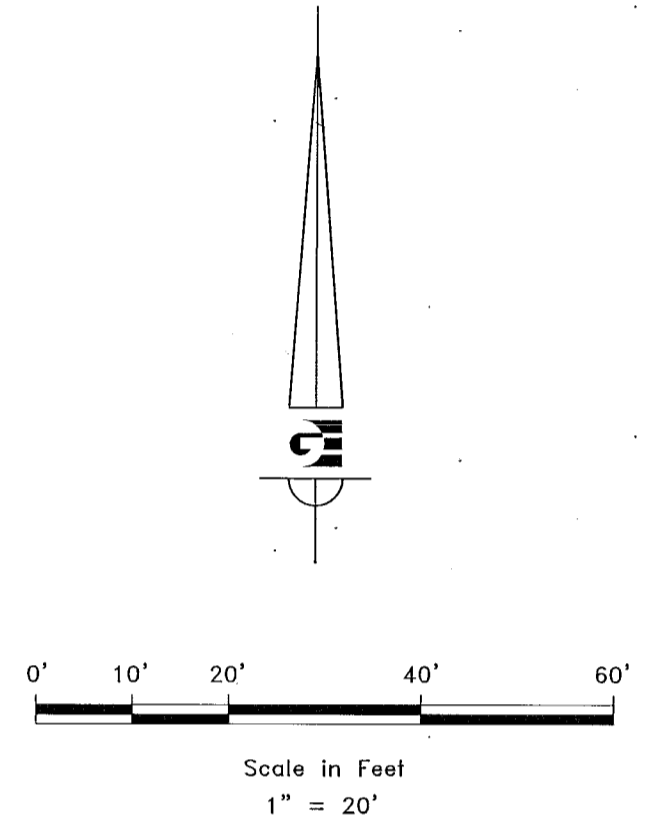

- LEGEND**
- ◆ WEBER COUNTY MONUMENT AS NOTED
  - SET 24" REBAR AND CAP MARKED GARDNER ENGINEERING
  - SUBJECT PROPERTY BOUNDARY
  - LOT LINE
  - - - ADJACENT PARCEL
  - - - SECTION LINE
  - - - EASEMENT
  - x - EXISTING FENCE LINE

**NARRATIVE**

THE PURPOSE OF THE SURVEY WAS TO ESTABLISH AND SET THE PROPERTY CORNERS OF THE PARCEL AS SHOWN AND DESCRIBED HEREON. THE SURVEY WAS ORDERED BY RALPH DUNKLEY. THE CONTROL USED TO ESTABLISH THE BOUNDARY WAS THE EXISTING WEBER COUNTY MONUMENTATION SURROUNDING SECTION 4, TOWNSHIP 6 NORTH, RANGE 1 WEST, SLB&M AND EXISTING OCCUPATION. THE BASIS OF BEARING IS THE NORTH LINE OF THE NORTHEAST QUARTER OF SAID SECTION 4, WHICH BEARS NORTH 89°42'01" WEST WEBER COUNTY, UTAH, NORTH NAD 83 STATE PLANE GRID BEARING. THE DEDICATED PLAT OF RIVER VALLEY ESTATES SUBDIVISION NUMBER 6 RECORDED IN BOOK 15, PAGE 63, THE DEDICATED PLAT OF BABCOCK CIRCLE RECORDED AS ENTRY # 2195349 IN BOOK 64, PAGE 33, AND THE WARRANTY DEED RECORDED AS ENTRY #2699971 ALONG WITH DEEDS OF ADJOINING LAND OWNERS WERE USED TO DETERMINE OWNERSHIP.

**SURVEYOR'S CERTIFICATE**

I, KLINT H. WHITNEY, DO HEREBY CERTIFY THAT I AM A LICENSED PROFESSIONAL LAND SURVEYOR IN THE STATE OF UTAH AND THAT I HOLD CERTIFICATE NO. 8227228 IN ACCORDANCE WITH TITLE 58, CHAPTER 22, OF THE PROFESSIONAL ENGINEERS AND LAND SURVEYORS ACT; I FURTHER CERTIFY THAT BY AUTHORITY OF THE OWNERS I HAVE COMPLETED A SURVEY OF THE PROPERTY DESCRIBED ON THIS RECORD OF SURVEY PLAT IN ACCORDANCE WITH SECTION 17-23-20 AND HAVE VERIFIED ALL MEASUREMENTS; THAT THE REFERENCE MONUMENTS SHOWN ON THIS RECORD OF SURVEY PLAT ARE LOCATED AS INDICATED AND ARE SUFFICIENT TO RETRACE OR REESTABLISH THIS SURVEY; AND THAT THE INFORMATION SHOWN HEREIN IS SUFFICIENT TO ACCURATELY ESTABLISH THE LATERAL BOUNDARIES OF THE HEREIN DESCRIBED TRACT OF REAL PROPERTY.

SIGNED THIS 16<sup>TH</sup> DAY OF JANUARY, 2020.

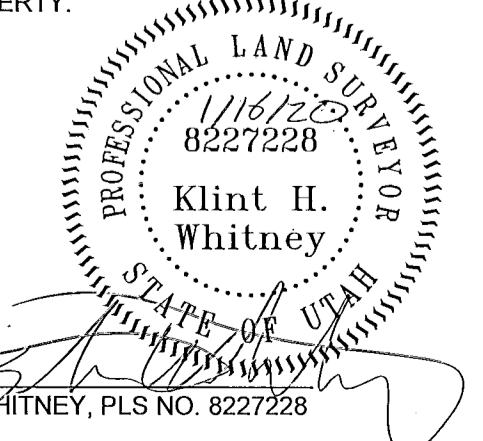

SCALE: 1/20" X REF	DATE: 6/14/19
DESIGN: _____	DRAWN: JTN
CHECKED: KHW	DWG.: R2001 - HSC SURVEYING - RALPH DUNKLEY SURVEYING/RALPH DUNKLEY DWS

**RECEIVED**  
 JAN 16 2020  
 BY: 6428

PROPERTY SURVEY FOR RALPH DUNKLEY  
 572 EAST 1700 NORTH  
 LOCATED IN THE NORTHWEST QUARTER OF SECTION 4,  
 TOWNSHIP 6 NORTH, RANGE 1 WEST, S.L.B. AND M.

**GARDNER ENGINEERING**  
 CIVIL & LAND PLANNING  
 MUNICIPAL & LAND SURVEYING  
 5150 SOUTH 375 EAST, OGDEN, UT  
 OFFICE: 801-476-0202 FAX: 801-476-0066

S1  
 1