

RECORD LEGAL DESCRIPTION:

Beginning at a point North 25.845 chains and West 2531 feet from the Southeast corner of the Northwest quarter of Section 1, Township 6 North, Range 2 West, Salt Lake Base and Meridian; running thence West 114 feet; thence South 370 feet; thence East 114 feet; thence North 370 feet to the point of beginning.

AS-SURVEYED LEGAL DESCRIPTION:

Commencing at a point North 00°39'31\"/>

Containing 38,748.25 square feet or 0.89 acres, more or less.

NARRATIVE:

The purpose of this survey is to define the existing Questar Gas parcel and adjoiners to be a part of a proposed facility. The original monument tie did not exist (center of Section 1) so the following determinations were made. The western right-of-way was defined from found UDOT monumentation and right of way maps from UDOT Project# I-15-8(7)338 which matched closely with the existing property fence. The southern right of way was determined from offsetting the northern right of way defined and verified from a boundary survey and subdivision plat for the LDS Church and Taylor Farms Estates Subdivision. The southern property line had no visual occupation from the adjoiner to the south, therefore the deed description location running from the found southwest corner of Section 1 was held as a common line.

SURVEYORS CERTIFICATE

I, CRAIG E. AHRENS, DO HEREBY CERTIFY THAT I AM A PROFESSIONAL LAND SURVEYOR AND THAT I HOLD LICENSE NO. 270814 AS PRESCRIBED BY THE LAWS OF THE STATE OF UTAH; THAT I HAVE MADE A SURVEY OF THE FOLLOWING DESCRIBED PROPERTY; THAT THIS SURVEY CORRECTLY SHOWS THE TRUE DIMENSIONS OF THE BOUNDARIES SURVEYED.

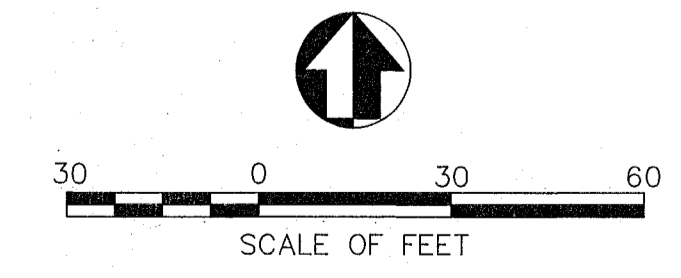
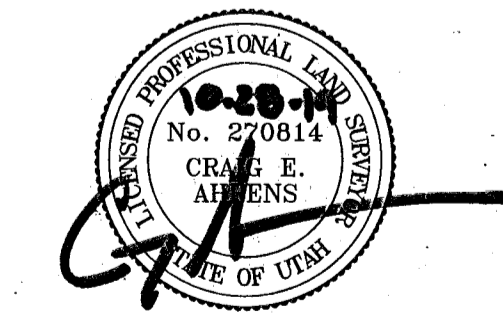

NOT FOUND CENTER OF SECTION SECTION 1 T6N R2W SLB&M

LOCATED IN THE NORTHWEST QUARTER OF SECTION 1, TOWNSHIP 6 NORTH, RANGE 2 WEST, SALT LAKE BASE & MERIDIAN

DATE:	10-28-19
PLAT DATE:	
SCALE:	1" = 30'
NUMBER:	80UE010366

**DOMINION ENERGY UTAH FACILITY
 RECORD OF SURVEY
 FARR WEST, UTAH**

PSOMAS
 4170 Riverboat Road, Suite 200
 Salt Lake City, Utah 84103
 (801) 270-3777 (801) 270-5782 (FAX)

DESIGNED	TDM
DRAFTED	TDM
CHECKED	CEA

SHEET	1
OF	1

RECEIVED
 FEB 18 2020
 BY: 6456