

VICINITY MAP  
Not to Scale

Northwest Corner of Section 14,  
T5N, R3W, SLB&M, U.S. Survey  
(Found Weber County Brass Cap in  
Good Condition Dated 1974 Flush  
with Road Surface)

NARRATIVE

This Survey was requested by Mr. Clair Heslop for the purpose of retracing the boundaries of these parcels.  
Weber County Brass Cap Monuments were found at a Witness corner location to the Southeast corner, of the East Quarter Corner and the Northeast corner of Section 14, T5N, R3W, SLB&M.  
A rebar with a melted cap was found at the Northwest corner of Bird's Place Subdivision, its location checks with the information shown on the Recorded Plat (Entry No 1249644, in book 36, at Page 55. of the Weber County Records Office).  
Property lines were established along deed lines.  
Property corners were monumented as depicted on this drawing.

SURVEYOR'S CERTIFICATE

I, Andy Hubbard do hereby certify that I am a Professional Land Surveyor, and that I hold Certificate No. 6242920, in accordance with Title 58, Chapter 22, of the Professional Engineers and Surveyors Licensing Act, and I have made a survey of the above described property according to Section 17-23-17 and that the above plat correctly shows the true dimensions of the property surveyed.

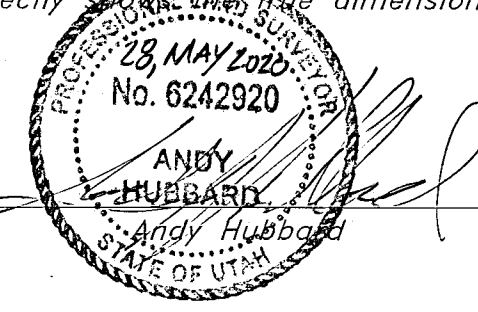

RECORD BOUNDARY DESCRIPTION

A part of the Southwest Quarter of Section 14 and part of the Southeast Quarter of Section 15, Township 5 North, Range 3 West, Salt Lake Base and Meridian, U.S. Survey: Beginning at a point 2.98 feet South from the Northwest Corner of the Southwest Quarter of said Section 14; running thence West 297.00 feet; thence South 404.24 feet; thence East 1372.8 feet; thence North 404.24 feet; thence West 1075.8 feet to the Point of Beginning.

Contains 10.65 Acres.

Center Corner of Section 14,  
T5N, R3W, SLB&M, U.S. Survey  
(Not Found Calculated)

West Quarter Corner of Section 14,  
T5N, R3W, SLB&M, U.S. Survey  
(Found Weber County Brass Cap in  
Good Condition Dated 1974 6"  
below grade)

Arthur and Nola Moore

Contains 12.738 Acres

Troy and Lori Sandberg

Stanley and Pamela Bird

Hunter Farms LLC

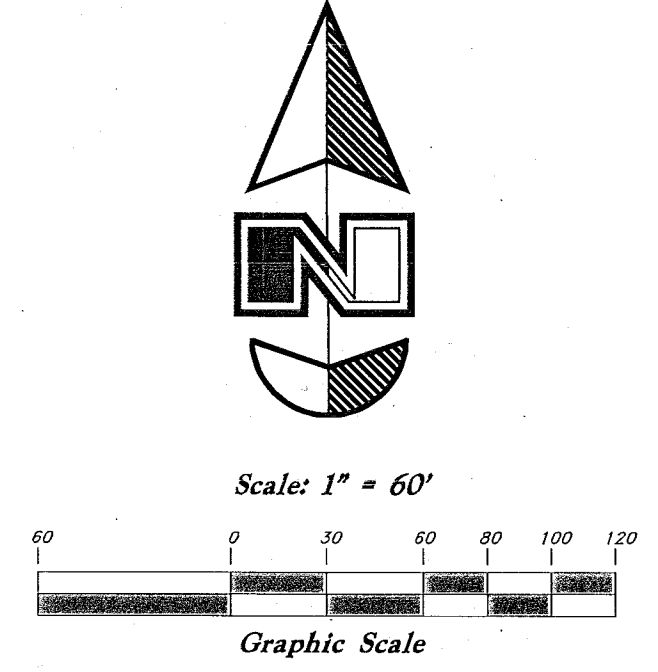

Legend

- ▲ Set Nail & Washer
- Set Rebar & Cap w/ Fencepost
- ⊙ Set Hub & Tack
- ⊕ Monument to be set
- (Rad.) Radial Line
- (N/R) Non-Radial Line
- Fence

Southwest Witness Corner of Section 14, T5N, R3W, SLB&M, U.S. Survey (Found Weber County Brass Cap in Good Condition Dated 1989 Flush with Ground)

Southwest Corner of Section 14, T5N, R3W, SLB&M, U.S. Survey (Not Found Calculated from witness corner)

**GREAT BASIN ENGINEERING**  
5746 SOUTH 1475 EAST OGDEN, UTAH 84403  
MAIN (801)394-4515, SLIC (801)521-0222, FAX (801)392-7544  
WWW.GREATBASINENGINEERING.COM

Record of Survey  
**Clair Heslop/Art Moore**  
Approx. 5261 South 7500 West  
Hooper City, Weber County, Utah  
A part of Section 15, T5N, R3W, SLB&M, U.S. Survey

29 May, 2020

SHEET NO.  
**1** of 1