

32ND STREET

STREET MONUMENT (NOT FOUND)

SURVEYOR'S CERTIFICATE

I, Michael B. Herbst, do hereby represent that I am a Professional Land Surveyor and that I hold Certificate no. 5046930 as prescribed by the laws of the State of Utah and I have made a survey of the following parcels: 05-037-0012, 05-037-0014 and 05-037-0026, in Ogden, Weber County, Utah and that it is true and correct based on the record information available and obtained at the time of this survey.

Date: January 9, 2018

*Michael B. Herbst*

Michael B. Herbst  
License no. 5046930

SURVEYOR'S NARRATIVE

The purpose of this survey is to locate and/or reset the property corner markers around the perimeter of the property. The Basis of Bearing is noted on the survey as being North 0°58'00" East 1351.18 feet, between two found street monuments. The first being a railroad spike marking the intersection of Harrison Boulevard and 33rd Street, and the second being a found Brass Cap street monument in the intersection of Harrison Boulevard and 33rd Street. The three subject parcels are located in the Northeast Quarter of Section 5, Township 5 North, Range 1 West, Salt Lake Base and Meridian. A total of three property corners were found and accepted as shown on the survey.

Documents and maps referenced during the course of this survey:

- Weber County ownership maps for the NW Quarter of Section 4.
- Record of Survey Map for Bone Villa Condominiums Recorded as Entry Number 1519488 in Book 46 at Page 23 in the office of the Weber County Recorder.
- Record of Survey Map Number 002849 of St. Paul Lutheran Church Prepared by Gary Newman on April 19, 2002 in the office of the Weber County Surveyor.
- Record of Survey Map Number 003841 Mountain Alarm Prepared by Keith Russell on June 27, 2007 in the office of the Weber County Surveyor.
- Tax descriptions for Parcels: 05-037-0011, 05-037-0012, 05-037-0013, 05-037-0014, 05-037-0015, 05-037-0017, and 05-037-0026

Parcel Tax Descriptions

Parcel 05-037-0012  
PART OF THE NORTHEAST QUARTER OF SECTION 4, TOWNSHIP 5 NORTH, RANGE 1 WEST, SALT LAKE MERIDIAN, U.S. SURVEY; BEGINNING AT A POINT SOUTH 00°33'30" WEST 9.9 FEET AND SOUTH 65.0 FEET 33.77 FEET AND SOUTH 00°58' WEST 379.82 FEET AND NORTH 89°02' WEST 551 FEET FROM THE NORTHEAST CORNER OF SAID QUARTER SECTION SAID POINT OF BEGINNING BEING ON THE SOUTH LINE OF THE GILLMAN JAY PROPERTY) RUNNING THENCE SOUTH 00°58' WEST 60 FEET, THENCE NORTH 89°02' WEST 125 FEET TO THE EAST LINE OF VAN BUREN AVENUE, THENCE NORTH 00°58' EAST 60 FEET, THENCE SOUTH 89°02' EAST 125 FEET TO THE POINT OF BEGINNING.

Parcel 05-037-0014  
PART OF THE NORTHEAST QUARTER OF SECTION 4, TOWNSHIP 5 NORTH, RANGE 1 WEST, SALT LAKE BASE AND MERIDIAN, U.S. SURVEY; BEGINNING AT A POINT ON THE SOUTH LINE OF THE PAUL D. SACHTER PROPERTY, SAID POINT BEING SOUTH 00°33'30" WEST 9.9 FEET AND SOUTH 65.0 FEET 33.77 FEET AND SOUTH 00°58' WEST 310 FEET AND NORTH 89°02' WEST 228.0 FEET FROM THE NORTHEAST CORNER OF THE NORTHEAST QUARTER OF SAID SECTION 4; RUNNING THENCE SOUTH 00°58' WEST 261.71 FEET, MORE OR LESS; THENCE NORTH 89°03'14" WEST 450.01 FEET TO THE EAST LINE OF VAN BUREN AVENUE; THENCE NORTH 00°58' EAST 30.0 FEET; THENCE SOUTH 89°03'14" EAST 125.0 FEET; THENCE NORTH 00°58' EAST 60.0 FEET; THENCE NORTH 89°02' WEST 125 FEET TO THE EAST LINE OF VAN BUREN AVENUE; THENCE NORTH 00°58' EAST 43.80 FEET ALONG THE EAST LINE OF SAID STREET; THENCE SOUTH 89°02' EAST 125.0 FEET; THENCE NORTH 00°58' EAST 60.0 FEET; THENCE SOUTH 89°02' EAST 8.0 FEET; THENCE NORTH 00°58' EAST 69.82 FEET; THENCE SOUTH 89°02' EAST 317.0 FEET TO THE POINT OF BEGINNING, SUBJECT TO A RIGHT-OF-WAY OVER AND ACROSS PART OF SAID PROPERTY DESIGNATED AS 43.80 FEET BY 125 FEET AND FRONTING ON VAN BUREN AVENUE AS GRANTED BY DEED RECORDED IN BOOK 797 OF RECORDS PAGE 215.

Parcel 05-037-0026  
PART OF THE NORTHEAST QUARTER OF SECTION 4, TOWNSHIP 5 NORTH, RANGE 1 WEST, SALT LAKE MERIDIAN, U.S. SURVEY; BEGINNING ON THE EAST LINE OF VAN BUREN AVENUE 318 FEET SOUTH 00°58' WEST AND SOUTH 89°02' EAST 103 FEET FROM THE NORTH LINE OF SAID QUARTER SECTION; RUNNING THENCE SOUTH 89°02' EAST 30 FEET; THENCE SOUTH 00°58' WEST 80 FEET; THENCE NORTH 89°02' WEST 30 FEET; THENCE NORTH 00°58' EAST 80 FEET TO THE POINT OF BEGINNING.

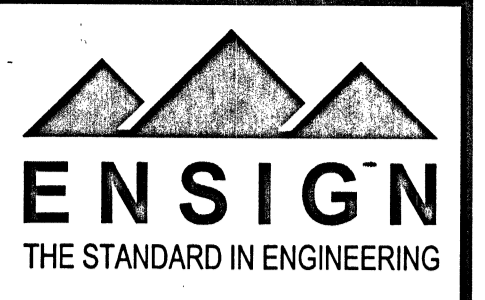

LAYTON  
1485 W. Hill Field Rd., Ste. 204  
Layton, UT 84041  
Phone: 801.547.1100

SALT LAKE CITY  
Phone: 801.255.0529

TOOELE  
Phone: 435.843.3590

CEDAR CITY  
Phone: 435.865.1453

RICHFIELD  
Phone: 435.896.2983

WWW.ENSIGNENG.COM

FOR:  
CRB  
3193 Farmwood Dr  
Layton, UT 84040  
CONTACT:  
Colin Brown  
PHONE: 801.390.8464

VERSAILLES APARTMENTS  
BOUNDARY SURVEY  
3290 VAN BUREN AVE  
OGDEN, UTAH

RECEIVED  
BY: 6618

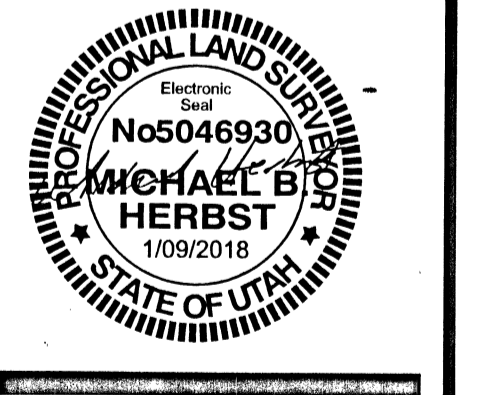

BOUNDARY SURVEY

PROJECT NUMBER: 7979  
PRINT DATE: 1/9/2018  
DRAWN BY: A. SHELBY  
CHECKED BY: M. HERBST  
PROJECT MANAGER: M. HERBST

1 of 1

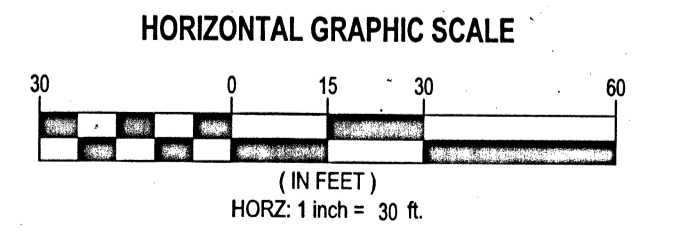
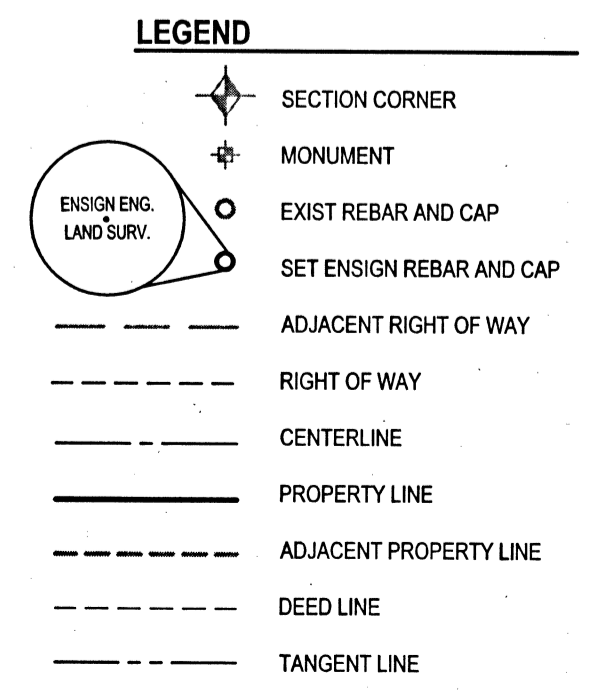

33RD STREET

FOUND STREET MONUMENT

FOUND RAILROAD SPIKE IN ASPHALT ACCEPTED AS STREET MONUMENT

35TH STREET

LOCATED IN THE NORTHEAST QUARTER OF SECTION 4 TOWNSHIP 5 NORTH, RANGE 1 WEST SALT LAKE BASE AND MERIDIAN